

STONE FILL THREE CABLE GUARD RAIL FOR SLOPE PROTECTION WITH STEEL POSTS (LIGHT TYPE)

RT	142'00" - 142'85.5"	LT	143'00"
RT	143'14" - 146'30"	RT	143'00"
		LT	143'100'
		RT	142'25"
		LT	149'80"

CONSTRUCT DRIVE

Steel Guide Posts
143'00 Rt 5

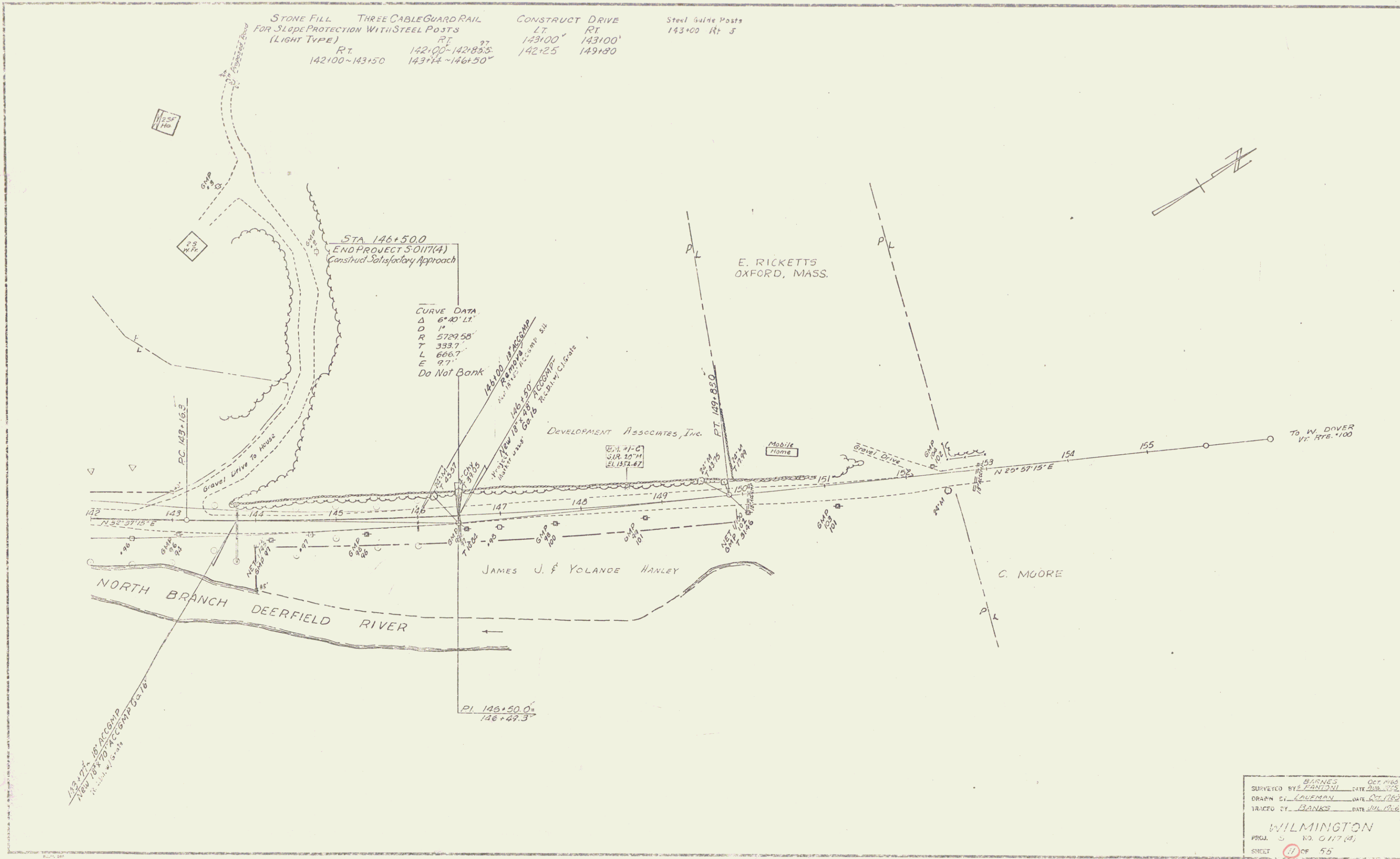

CURVE DATA
 Δ 6°40' LT
 D 14
 R 5729.55'
 T 333.7'
 L 666.7'
 E 9.7'
 Do Not Bank

BARNES OCT 1965
 SURVEYED BY E. FANTON DATE 2/28/65
 DRAWN BY COLEMAN DATE OCT 1965
 TRACED BY BANKS DATE JUL 1966

WILMINGTON
 PROJ. 5 NO. 0117(4)
 SHEET 11 OF 55