

FED. ROAD DIST. NO.	STATE	FED. AID PROJ. NO.	FISCAL YEAR	SHEET NO.	TOTAL SHEETS
9	VT.	E-101-F	1932	1	53

INDEX OF SHEETS

SHEET NO. 1	TITLE PAGE	} GRADING, BASE AND CULVERT CONST.
" 2	TYPICAL CROSS-SECTION OF IMPROVEMENT	
" 3	BANKING AND WIDENING TABLES	
" 4-12	PLAN AND PROFILE SHEETS	
" 13	STANDARD STRUCTURE SHEET S-20 (PIPE CULVERTS)	
" 14	STANDARD STRUCTURE SHEET S-21 (BOX CULVERTS)	
" 15	BARRICADES, SIGNS, AND LIGHTS SB-II	
" 16-53	CROSS SECTIONS	

STATE OF VERMONT
STATE HIGHWAY DEPARTMENT

PLAN AND PROFILE OF PROPOSED
STATE HIGHWAY

FEDERAL AID PROJECT

TOWNS OF PITTSFIELD-SHERBURNE
BETHEL - SHERBURNE ROAD

FROM 3000 FEET NORTH OF PITTSFIELD-SHERBURNE
TOWN LINE SOUTHERLY 2.351 MILES
TO 550 FEET SOUTH OF SHERBURNE HOLLOW ROAD

LENGTH OF PROJECT: 12,416.7 FEET = 2.351 MILES

(To Be Returned to R.O.W. Division)
Form of Vt 100
PERPETUAL
TOWN FILE
RIGHT-OF-WAY DIVISION

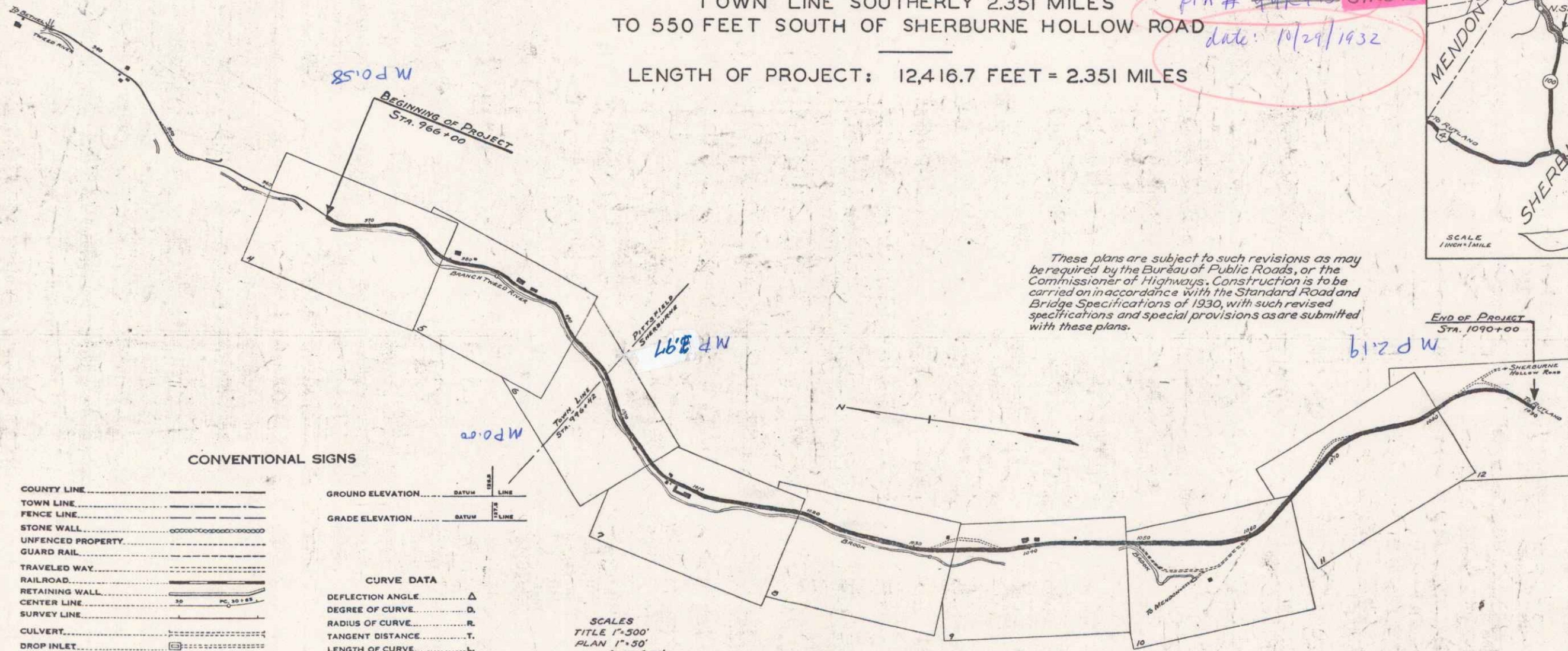
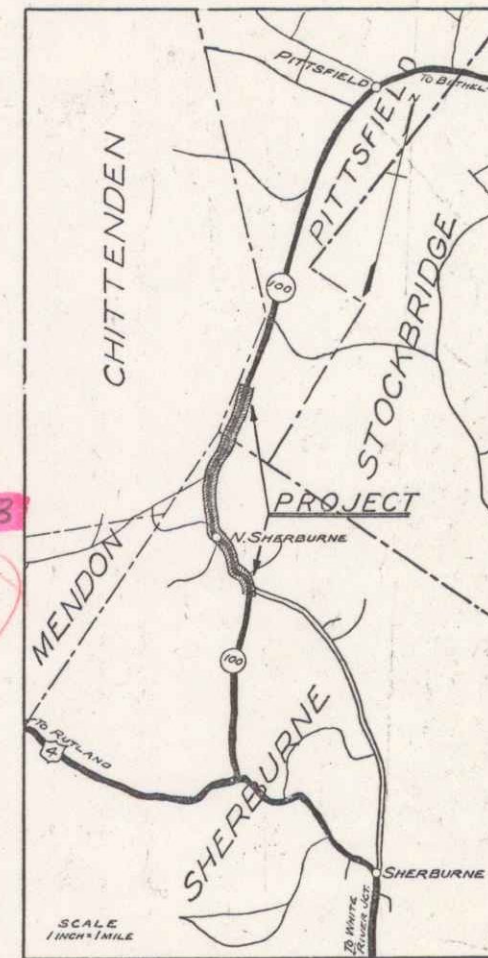

These plans are subject to such revisions as may be required by the Bureau of Public Roads, or the Commissioner of Highways. Construction is to be carried in accordance with the Standard Road and Bridge Specifications of 1930, with such revised specifications and special provisions as are submitted with these plans.

CONVENTIONAL SIGNS

COUNTY LINE	GROUND ELEVATION
TOWN LINE	GRADE ELEVATION
FENCE LINE	
STONE WALL	
UNFENCED PROPERTY	
GUARD RAIL	
TRAVELED WAY	
RAILROAD	
RETAINING WALL	
CENTER LINE	
SURVEY LINE	
CULVERT	
DROP INLET	
TROLLEY POLE	
POWER POLE	
TELEPHONE POLE	
TREES	
Hedge	

CURVE DATA

DEFLECTION ANGLE	Δ
DEGREE OF CURVE	D
RADIUS OF CURVE	R
TANGENT DISTANCE	T
LENGTH OF CURVE	L
EXTERNAL DISTANCE	E
POINT OF INTERSECTION	P. I.
POINT OF CURVE	P. C.
POINT OF TANGENT	P. T.
POINT ON TANGENT	P. O. T.

SCALES
TITLE 1"=300'
PLAN 1"=50'
PROFILE (VERT.) 1"=50'
CROSS SECTION 1"=5'

APPROVED: Oct. 29, 1932
F. E. Sargent
COMMISSIONER OF HIGHWAYS
SUBMITTED BY ORDER OF THE STATE HIGHWAY BOARD

RECOMMENDED _____
DISTRICT ENGINEER BUREAU OF PUBLIC ROADS
RECOMMENDED FOR APPROVAL _____
CHIEF ENGINEER BUREAU OF PUBLIC ROADS
APPROVED _____
DIRECTOR BUREAU OF PUBLIC ROADS

CORRECT Oct 29 1932
J. B. Randall
ROAD ENGINEER
SERIES F. NO. E-101-F FILED
SHEET 1 OF 53