

INDEX OF SHEETS

SHEET NO.	TITLE PAGE
1	TITLE PAGE
2	TYPICAL CROSS-SECTION OF IMPROVEMENT—DOUBLE TACK COAT OF REFINED TAR WITH PEA STONE SEAL ITEM 29A
3	BANKING AND WIDENING TABLES
4-8	PLAN AND PROFILE
9	DRAINAGE AND QUANTITY SHEET
10	STANDARD STRUCTURE SHEET S-28 PIPE CULVERTS
11	" " " S-30 GUARD RAIL
12	" " " S-30A BOUNDARY MARKERS
13	" " " S-40 BARRICADES, SIGNS AND LIGHTS
14	CULVERT SECTION SHEET

STANDARD STRUCTURE SHEETS APPROVED BY CHIEF ENGINEER  
VERMONT STATE HIGHWAY DEPARTMENT

S-28	APRIL 6, 1941
S-30	MAY 12, 1941
S-30A	APRIL 19, 1941
S-40	DECEMBER 18, 1941

STATE OF VERMONT  
STATE HIGHWAY DEPARTMENT

PLAN AND PROFILE OF PROPOSED  
STATE HIGHWAY  
SECONDARY

TOWN OF BRAINTREE

RANDOLPH-ROXBURY ROAD VERMONT ROUTE 12A  
BEGINNING AT THE RANDOLPH-BRAINTREE TOWN LINE AND  
EXTENDING WESTERLY AND NORTHERLY 6300.8 FEET

P.L.# 01R013

LENGTH OF PROJECT --- 63008 FT. = 1.193 MI.

FED. ROAD DIST. NO.	STATE	FED. AID PROJ. NO.	FISCAL YEAR	SHEET NO.	TOTAL SHEETS
9	Vt.	5#15-1830	1	1	1

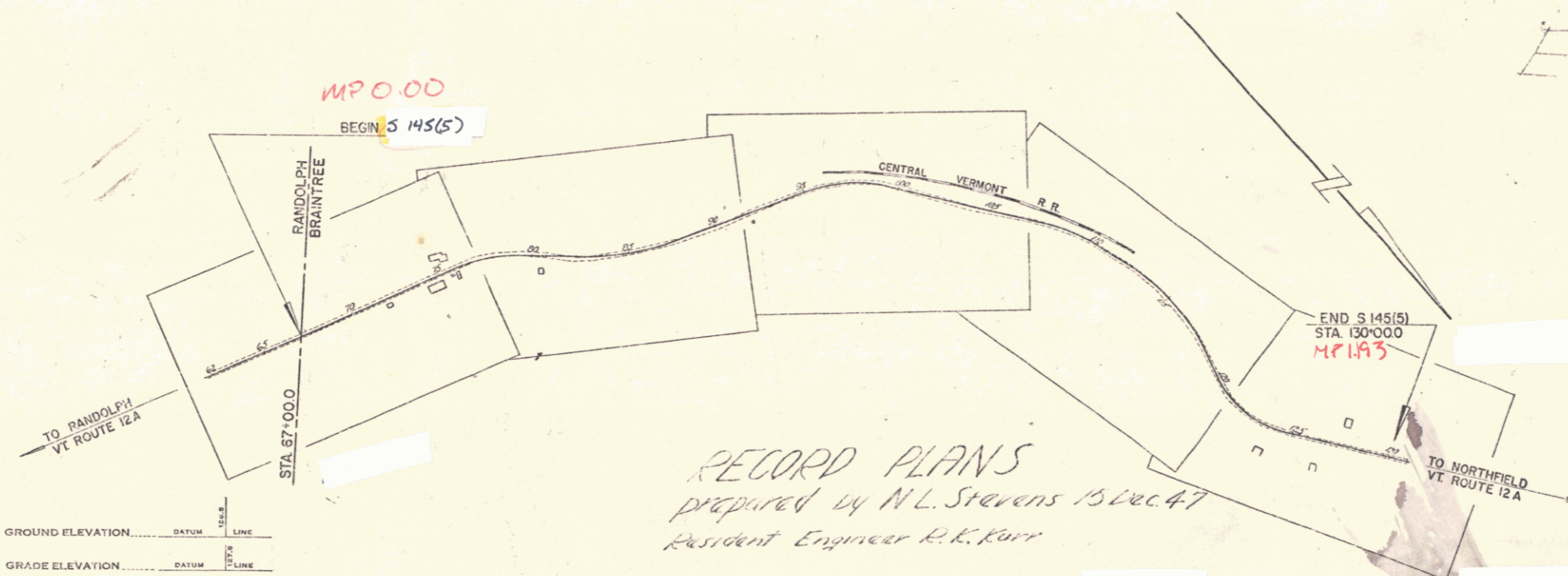

Earthworks not revised

RIGHT-OF-WAY DIVISION  
TOWN FILE  
PERPETUAL  
Town of 12A  
(To Be Returned To R.O.W. Division)

APPROVED: Oct. 21, 1946  
Hubert Sargent  
COMMISSIONER OF HIGHWAYS  
SUBMITTED BY ORDER OF THE STATE HIGHWAY BOARD

RECORD PLANS  
Prepared by N.L. Stevens 13 Dec. 47  
Resident Engineer R.K. Kerr

PROJECT NUMBER	145(5)
LENGTH	1.193 MI.
DATE	1947
CONTRACTOR	Ernest L. Bell
DATE	1947
DESCRIPTION	On the Randolph-Roxbury Road Vermont Route 12A beginning at the Randolph-Braintree town line and extending westerly and northerly 6300.8 feet.

RECORD PLANS  
BRAINTREE S 145(5)  
Contractor - ERNEST L. BELL

GROUND ELEVATION	DATUM	SCALE
.....	.....	.....
GRADE ELEVATION	DATUM	SCALE
.....	.....	.....

CURVE DATA

DEFLECTION ANGLE	.....	Δ
DEGREE OF CURVE	.....	D
RADIUS OF CURVE	.....	R
TANGENT DISTANCE	.....	T
LENGTH OF CURVE	.....	L
EXTERNAL DISTANCE	.....	E
POINT OF INTERSECTION	.....	P. I.
POINT OF CURVE	.....	P. C.
POINT OF TANGENT	.....	P. T.
POINT ON TANGENT	.....	P. O. T.

SCALES

TITLE	1" = 400'
TYPICAL	1" = 2'
PLAN	1" = 50'
PROFILE HORIZONTAL	1" = 50'
PROFILE VERTICAL	1" = 10'
CROSS SECTIONS	1" = 1"

THESE PLANS ARE SUBJECT TO SUCH REVISIONS AS MAY BE REQUIRED BY THE PUBLIC ROADS ADMINISTRATION OR THE COMMISSIONER OF HIGHWAYS.

CONSTRUCTION IS TO BE CARRIED ON IN ACCORDANCE WITH THE PLANS AND THE STANDARD ROAD AND BRIDGE SPECIFICATIONS OF 1936, AS APPROVED DECEMBER 25TH, 1936 BY THE PUBLIC ROADS ADMINISTRATION, INCLUDING ALL SUBSEQUENT APPROVED REVISIONS AND SUCH REVISED SPECIFICATIONS AND SPECIAL PROVISIONS AS ARE SUBMITTED WITH THE PLANS.

APPROVED: Oct 16, 1946  
DISTRICT HIGHWAY ENGINEER

APPROVED: Oct 16, 1946  
DISTRICT HIGHWAY COMMISSIONER

SERIES E 5 NO. 145(5) FILED  
SHEET 1 OF 1