

POOR ORIGINAL COPY

120-C 1930

CURVE # 22
 Δ 0°-37'-41"
 D 0'-15"
 R 2230.3
 T 123.4
 L 246.5
 E 0.2

PLAN	DATE	BY
REVISION	DATE	BY
REVISION	DATE	BY
REVISION	DATE	BY
REVISION	DATE	BY

PERMITS	DATE	BY
REVISION	DATE	BY
REVISION	DATE	BY
REVISION	DATE	BY
REVISION	DATE	BY

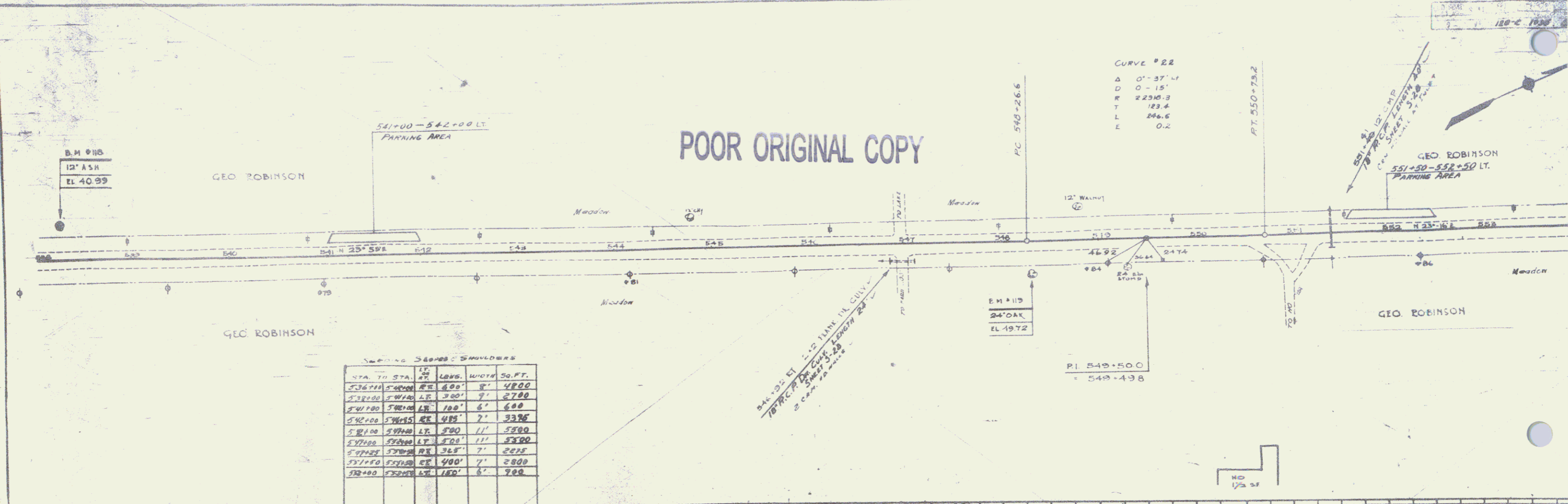

SETTING SHOULDERS

STA. TO STA.	LR	RR	LRG.	WIDTH	SQ. FT.
536+00	540+00	RR	6.00'	8'	4800
536+00	537+00	LR	3.00'	7'	2100
541+00	542+00	LR	1.00'	6'	600
542+00	543+00	RR	4.85'	7'	3395
543+00	544+00	LR	3.00'	11'	3300
544+00	545+00	LR	3.75'	11'	4125
545+00	546+00	RR	3.65'	7'	2555
547+00	548+00	RR	4.80'	7'	3360
548+00	549+00	LR	1.80'	6'	1080

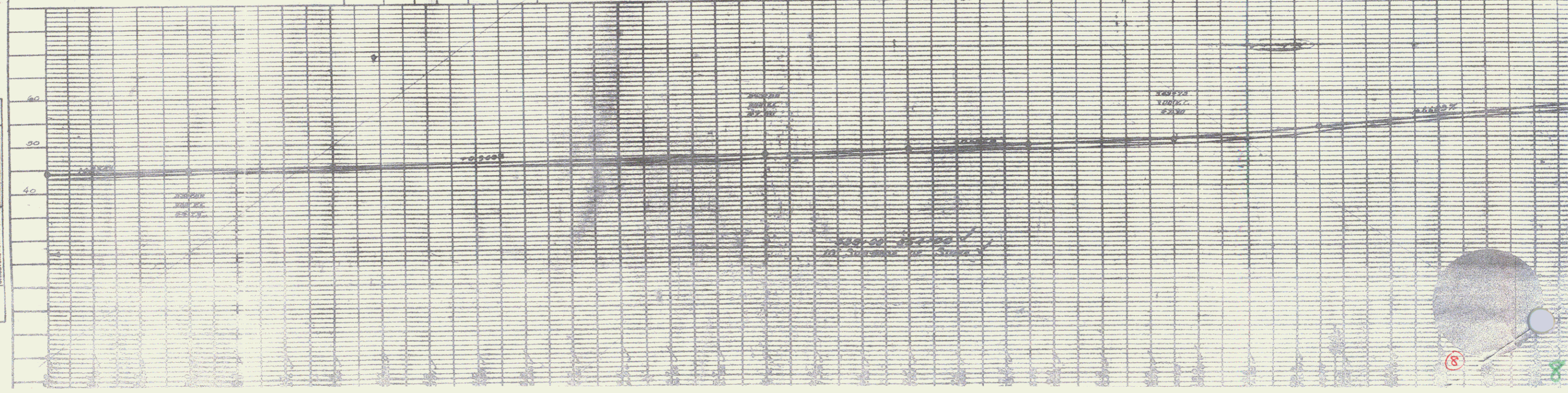

240' CURVE LENGTH
 10' R.C.P. DEPTH
 2" CAN. DRAINAGE

HD 1/2" 2"

