

INDEX OF SHEETS

1	TITLE SHEET
2	TYPICAL SHEET, MAINLINE
3	TYPICAL SHEET, U.S. 5 APPROACH
4-5	QUANTITY SHEETS
6	DRAINAGE SHEET
7-8	EARTHWORK SHEETS
9	PLAN & PROFILE SHEETS
9-12	DETAILS OF U.S. 4 & U.S. 5 INTERSECTION
13	ROW DETAIL SHEET
14	SOLID ROCK EXCAVATION
15	BANKING TABLES
16	TYPICAL SLOPE GRADING
17	CURBS
18	C-1
19	C-2
20	ONE COURSE CEMENT CONCRETE SIDEWALK
21	D-2
22	UNDERDRAIN, HEADWALLS
23	D-3
24	GUTTERS
25	ELBOWS, FLUSHING BASINS
26	D-4
27	D-5
28	D-6
29	D-7
30	D-8
31	D-9
32	D-10
33	D-11
34	D-12
35	D-13
36	D-14
37	D-15
38	D-16
39	D-17
40	D-18
41	D-19
42	D-20
43	D-21
44	D-22
45	D-23
46	D-24
47	D-25
48	D-26
49	D-27
50	D-28
51	D-29
52	D-30
53	D-31
54	D-32
55	D-33
56	D-34
57	D-35
58	D-36
59	D-37
60	D-38
61	D-39
62	D-40
63	D-41

STATE OF VERMONT  
DEPARTMENT OF HIGHWAYS

PROPOSED IMPROVEMENT

FEDERAL AID  
URBAN PROJECT

TOWN OF HARTFORD

COUNTY OF WINDSOR  
U.S. 5-WILDER INTERCHANGE SPUR

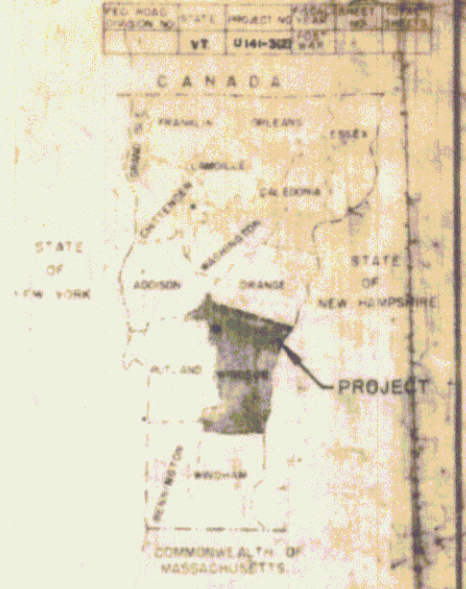

BEGINNING AT A POINT 0.048 MILE EASTERLY OF ROUTE 191 NORTHBOUND STA. 3826+37.46 AND EXTENDING EASTERLY 0.30 MILE TO AN INTERSECTION WITH U.S. RTE. 5 AT A POINT 0.738 MILE NORTH OF NORTHERLY STATE HIGHWAY LIMITS, WHITE RIVER JUNCTION.  
LENGTH OF PROJECT 1635.00 FEET = 0.310 MILE.

DESIGN	DESIGNATION
ADT 1965	1750
ADT 1985	4165
DIV 1985	300
D	55%
V	60%
	5%
	8%

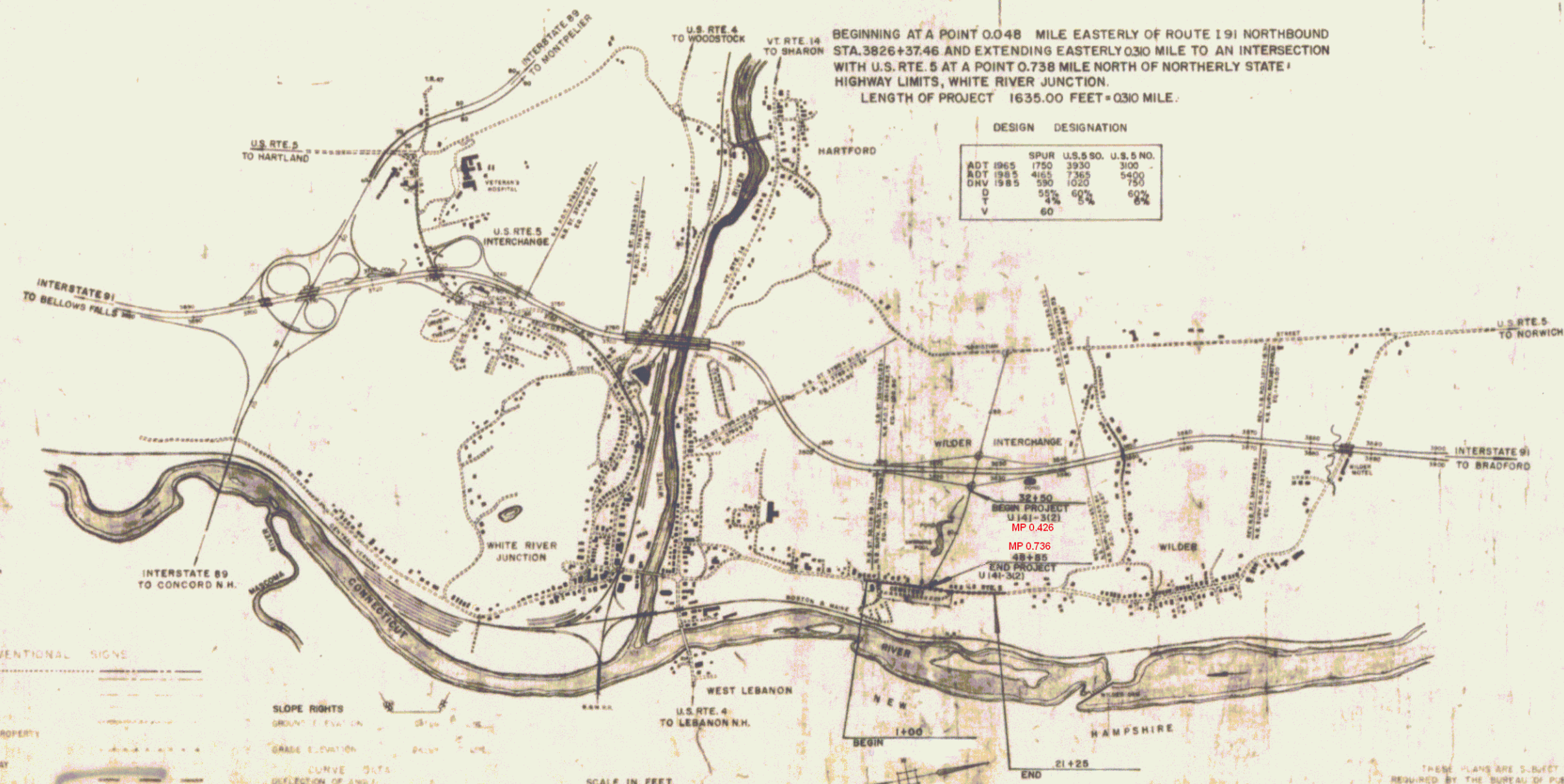

CONVENTIONAL SIGNS

ROW	---
COUNTY LINE	---
TOWN LINE	---
EDGE LINE	---
STONE WALL	---
UNFENCED PROPERTY	---
GUARD RAIL	---
TRAVELED WAY	---
RAILROAD	---
RETAINING WALL	---
CENTER LINE	---
SURVEY LINE	---
CULVERT	---
DROP INLET	---
TROLLEY POLE	---
POWER POLE	---
TELEPHONE POLE	---
TREES	---
HEDGE	---
LIMITED ACCESS	---

SLOPE RIGHTS

GRADE ELEVATION	---
CURVE DATA	---
DEFLECTION OF ANGLE	---
DEGREE OF CURVE	---
RADIUS OF CURVE	---
TANGENT DISTANCE	---
LENGTH OF CURVE	---
EXTERNAL DISTANCE	---
POINT OF INTERSECTION	---
POINT OF CURVE	---
POINT OF TANGENT	---
POINT ON TANGENT	---
POINT ON SUB-TANGENT	---
POST	---

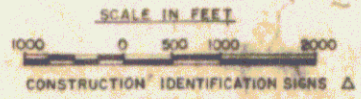

THESE PLANS ARE SUBJECT TO SUCH REVISIONS AS MAY BE REQUIRED BY THE BUREAU OF PUBLIC ROADS OF THE COMMISSIONER OF HIGHWAYS.  
CONSTRUCTION IS TO BE CARRIED ON IN ACCORDANCE WITH THESE PLANS AND THE STANDARD SPECIFICATIONS FOR HIGHWAY AND BRIDGE CONSTRUCTION OF JANUARY 1956 SUBMITTED TO THE BUREAU OF PUBLIC ROADS AS APPROVED JULY 5, 1956 INCLUDING ALL SUBSEQUENT APPROVED REVISIONS AND SUCH REVISED SPECIFICATIONS AND SPECIAL PROVISIONS AS ARE SUBMITTED WITH THE PLANS.

Pin # DOR863  
Route ST HWY  
Date 1/30/1963

STAGE I CONSTRUCTION  
HARTFORD

DEPARTMENT OF COMMERCE  
BUREAU OF PUBLIC ROADS

DISTRICT ENGINEER

APPROVED DATE	APPROVED DATE 1/30/63	APPROVED DATE	APPROVED DATE 2/1/66	APPROVED DATE 1/29/63	APPROVED DATE 1/29/63
------------------	--------------------------	------------------	-------------------------	--------------------------	--------------------------

PROJECT U. W. 141-3(21)  
SHEET 11 OF 11

STATE OF VERMONT  
DEPARTMENT OF HIGHWAYS  
RIGHT-OF-WAY PLANS  
(DETAIL SHEET)

TABLE OF PROJECT PROPERTY ACQUISITION

PARCEL NO.	GRANTOR	SHEET NO.	BEGINNING STATION	ENDING STATION	TAKING	REM.	RIGHTS	TITLE TAKEN	DATE	TOWN OR CITY RECORDED	BK.	PG.	REMARKS
1	TARDIE, PAUL	4/5	32+50 LT	42+57 LT	3.8A±LA 4.4 ZA±								
2	MANNING, SHERMAN B.	4/5	32+88 RT	48+49 RT	4.0A±LA 75.5A±								REMAINDER INCLUDES PARCELS 3 ABCD ON PROJECT U041-3(7). SWIMMING POOL
3	TOWN OF HARTFORD, LESSEE MANNING, SHERMAN B., LESSOR	4/5	40+75 RT 42+75 RT	45+15 RT 43+75 RT	0.5A±LA 3.0A±		SLOPE 37.5 S.F.						
4	PATTERSON, EULA S.	5	46+47 LT	48+90 RT	0.6A±LA NONE								REMAINDER INCLUDES PARCEL 15 ON PROJECT U041-3(7)
5	KINGSBURY, MILDRED L.	5	48+10 RT	48+90 RT	0.1A±LA NONE								REMAINDER INCLUDES PARCEL 13 ON PROJECT U041-3(7)

TABLE OF REVISIONS

REVISION NO.	SHEET NO.	DESCRIPTION OF REVISION	DATE	MADE BY	APPROVED BY
1		Changed sheet numbers to new specifications numbers on quantity, layout & sections and updated page system to match (ADDENDUM) papers	8/18/65	LBC	LCJ
2		Changed station, length, grade & width of 3d' OSMPD finally located 9.26± 42+00 LT - 47+00 RT. New station of 84' OSMPD from 42+00± 45+75 RT	9/18/65	LBC	LCJ
3		Added Property Line Fence w/ Steel Posts 30x 30+00 - 44+50 LT 5 FT.	8/28/65	LBC	LCJ
4		Added "Limited Access" Symbol to Taking Line of This Project	4-12-65	J.R.D.	J

LEGEND

MADE BY: E.L. May DATE 10-10-65  
CHECKED BY: R.C. Quinn DATE 10-30-65

--- TAKING WITHOUT ACCESS  
--- P --- TAKING WITHOUT ACCESS ALONG PROPERTY LINES  
--- TAKING WITH ACCESS  
--- PRESENT R O W

--- SR --- SLOPE RIGHTS  
--- P --- PROPERTY LINE  
--- Δ --- TOP OF CUT  
--- O --- TOE OF SLOPE

APPROVED: J.C. Bernatchez DATE 11-9-68  
PROGRAM SUPERVISOR  
APPROVED: W.H. [Signature] DATE 11-5-68  
APPROVED: [Signature] DATE 11/5/68  
HARTFORD U 741-3(8)

SHEET 7 OF 8 SHEETS

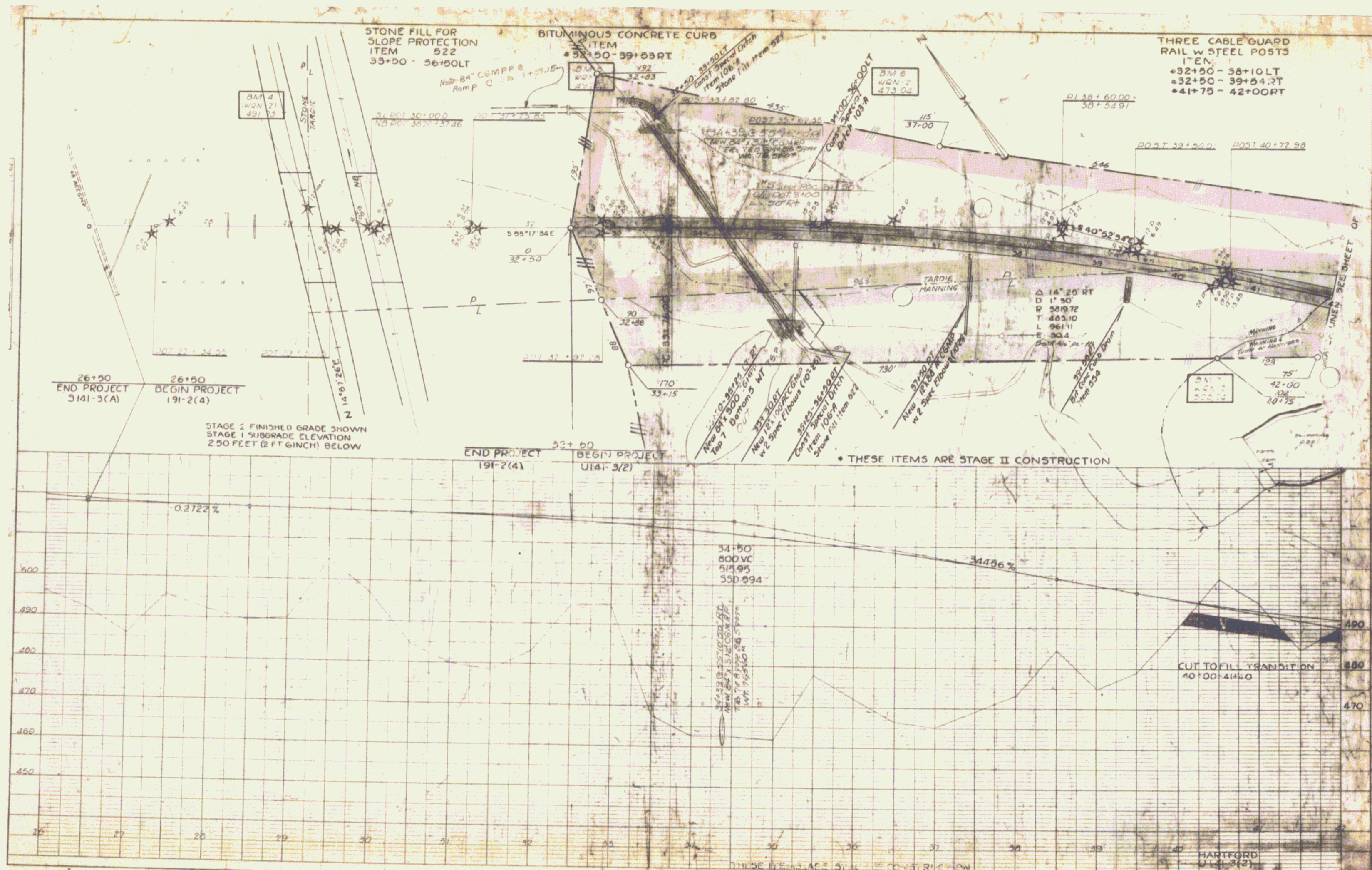

**CONST DRIVES**  
 U55 Appr 1+90 LT  
 U55 Appr 3+20 RT  
 U55 Appr 3+50 LT  
 U55 Appr 14+16 RT (Paved)  
 U55 Appr 14+75 RT (Paved)  
 U55 Appr 16+00 RT (Paved)

**GRANITE CURB**  
 U55 Appr 3+50-14+08 RT  
 U55 Appr 14+24-14+67 RT  
 U55 Appr 14+63-15+23 RT  
 U55 Appr 16+06-16+23 RT  
 U55 Appr 16+68-16+86 RT

**TREATED TIMBER CURBING ITEM**  
 \* 44+75-47+79 LT  
 \* 46+18-45+74 RT

**THREE CABLE GUARD RAIL w STEEL POSTS**  
 \* 42+00-44+25 RT  
 \* 44+75-47+79 LT  
 \* 46+10-45+74 RT

**CONST COMM.DRIVES**  
 U55 Appr 16+46 RT (Paved)

**STONE FILL FOR SLOPE PROTECTION**  
 42+85-43+75 RT

**GRANITE SLOPE EDGING**  
 U55 Appr 4+40-10+40 LT (ISLAND)  
 U55 Appr 11+00-16+00 LT (ISLAND)  
 47+85-48+85 (ISLAND)  
 46+35-48+85 (ISLAND)

**DEMOLITION & REMOVAL OF BUILDING ITEM 586**  
 BLDG NO 1 U55 4+50 LT  
 BLDG NO 2 U55 4+90 LT  
 BLDG NO 3 U55 5+50 LT  
 BLDG NO 4 U55 6+29 LT  
 BLDG NO 5 U55 7+50 LT  
 BLDG NO 6 U55 7+89 LT  
 BLDG NO 7 U55 9+90 LT  
 BLDG NO 8 U55 11+20 LT  
 BLDG NO 9 U55 13+50 LT  
 BLDG NO 10 U55 14+50 LT  
 BLDG NO 11 U55 15+50 LT

**9" CONC SIDEWALK**  
 U55 APPR 3+30-17+00 RT

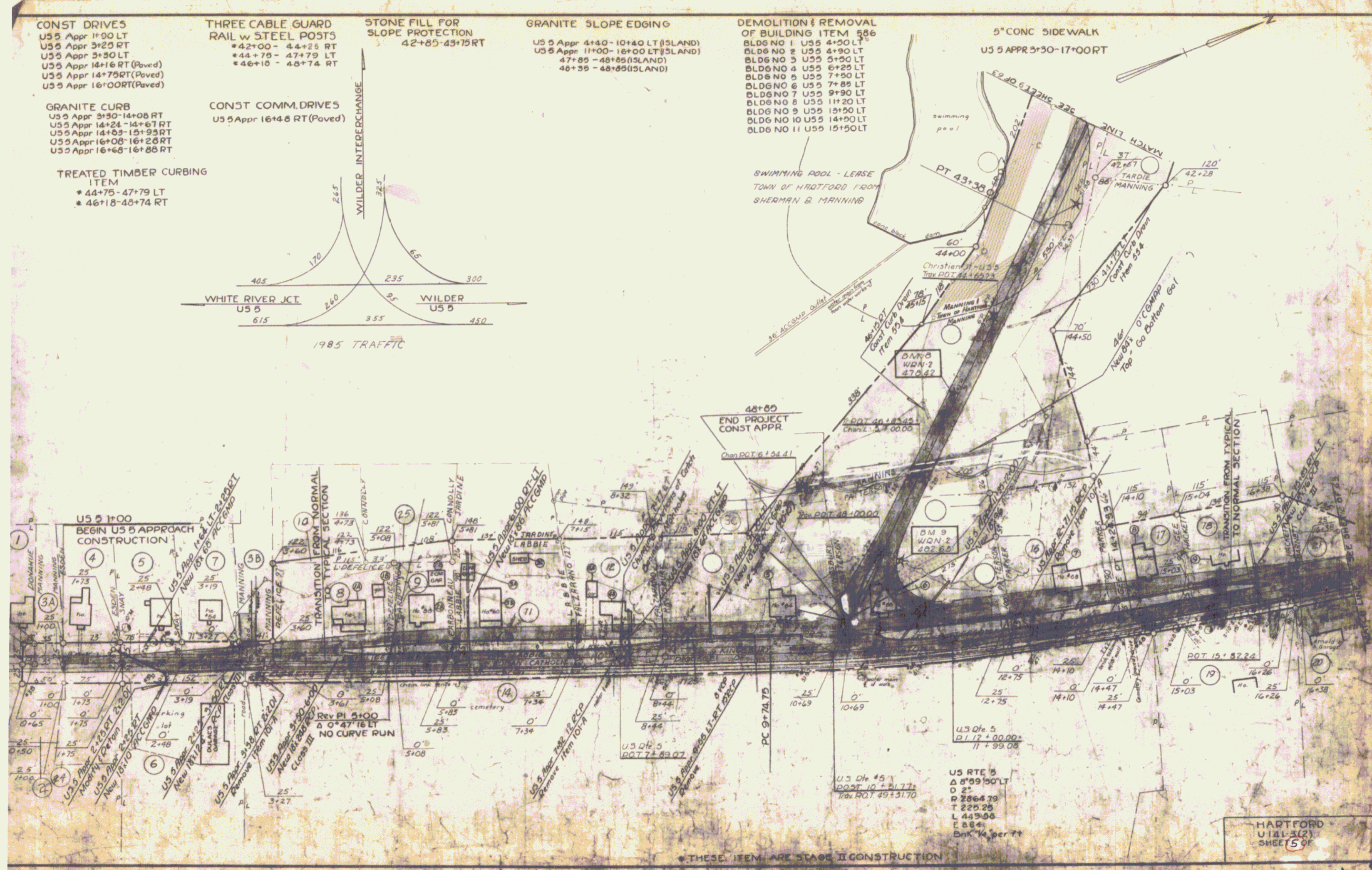
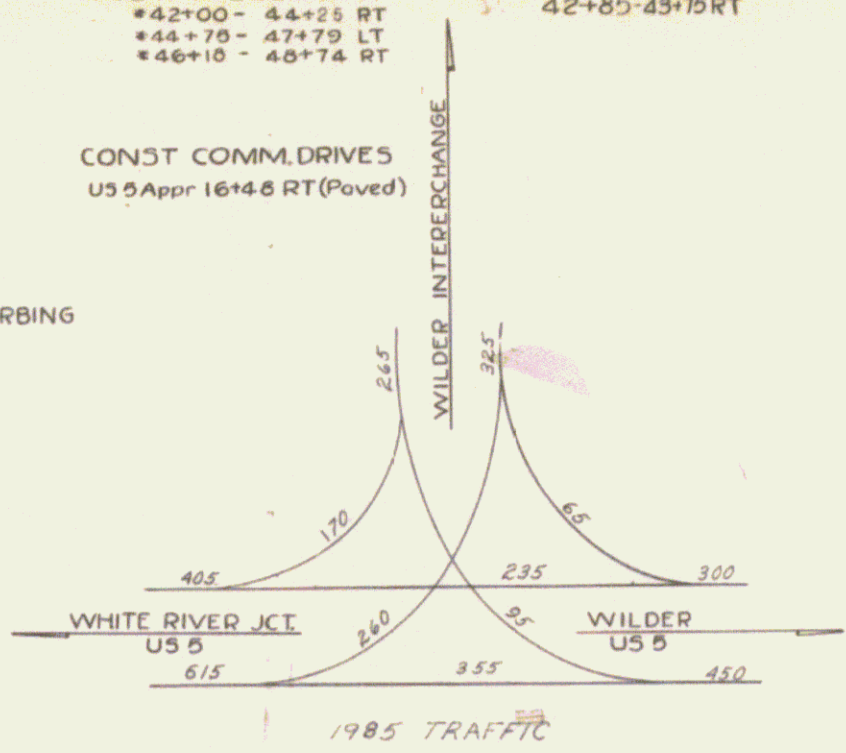

• THESE ITEMS ARE STAGE II CONSTRUCTION

HARTFORD  
 U141-3(2)  
 SHEET 5 OF 5