

BEING PART OF THE LAND AND PREMISES ACQUIRED BY THE STATE OF VERMONT FROM THE UNION HIGH SCHOOL DIST. NO. 4 BY WD. DATED SEPT. 18, 1956 AND RECORDED OCT. 20, 1956 IN BK. 54, PG. 26 OF THE TOWN OF WOODSTOCK LAND RECORDS.

STATE OF VERMONT  
TO  
TOWN OF WOODSTOCK

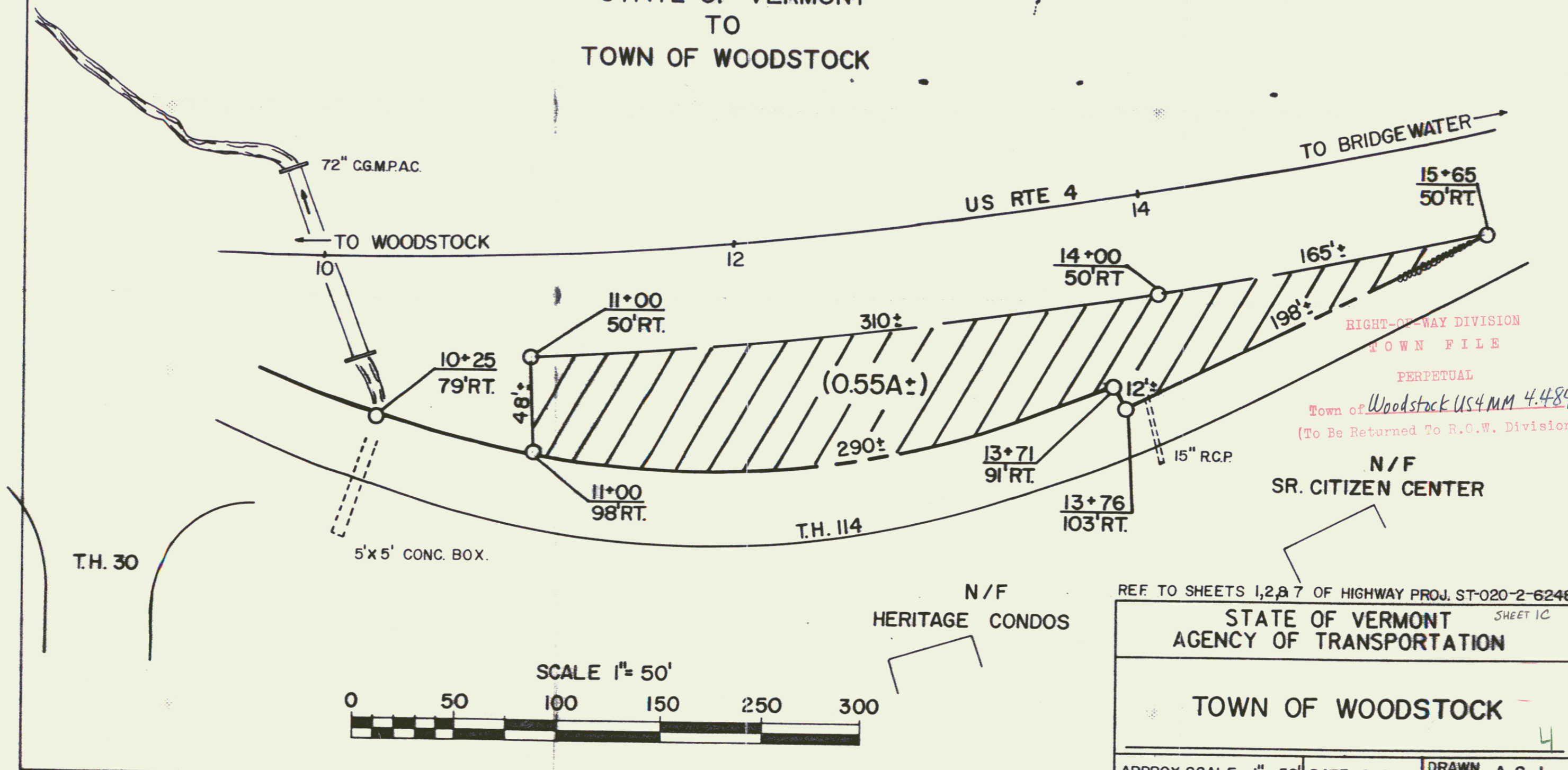
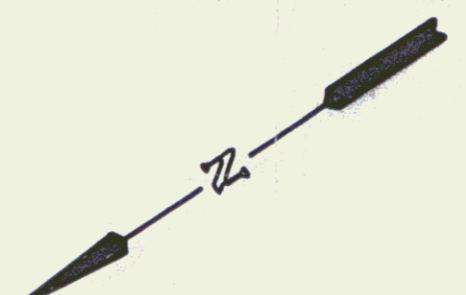

RIGHT-OF-WAY DIVISION  
TOWN FILE  
PERPETUAL  
Town of Woodstock US4 MM 4.484  
(To Be Returned To R.O.W. Division)

N/F  
SR. CITIZEN CENTER

N/F  
HERITAGE CONDOS

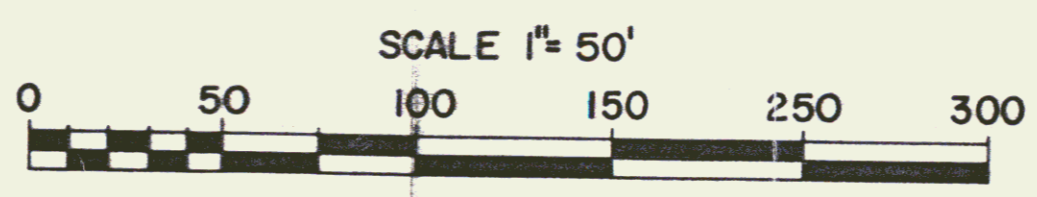

REF. TO SHEETS 1,2,3,7 OF HIGHWAY PROJ. ST-020-2-6248

STATE OF VERMONT  
AGENCY OF TRANSPORTATION

TOWN OF WOODSTOCK

APPROX. SCALE 1" = 50' DATE 8-8-88 DRAWN BY A. S. J.