

INDEX OF SHEETS

SHEET NO. 1	TITLE PAGE
2	TYPICAL CROSS-SECTION OF IMPROVEMENT DOUBLE TRACK COAT OF REFINED TAR WITH SAND-GRAVEL SEAL, ITEM S11-A
3	BANKING AND WIDENING TABLES
4	QUANTITY SHEET (ITEMS AND DRAINAGE)
5-7	EARTHWORK SHEETS
8-13	PLAN AND PROFILE SHEETS
14	CONSTRUCTION DETAILS (DRAINAGE AND MARKERS)
15	CONSTRUCTION DETAILS CD 1 (DITCHES)
16	STANDARD STRUCTURE SHEET S 40 (BARRICADES, SIGNS & LIGHTS)
16-A	STANDARD STRUCTURE SHEET S 53-48 (P.C. CATCH BASINS)
17-32	CROSS SECTIONS

STANDARD STRUCTURE SHEET APPROVED BY THE CHIEF ENGINEER, VERMONT STATE DEPARTMENT OF HIGHWAYS.

S-40 JUNE 10, 1950

NOTE - Any further information concerning final quantities, amounts or other details relative to this project may be found in either the field books or the estimate file.

STATE OF VERMONT
STATE HIGHWAY DEPARTMENT

PLAN AND PROFILE OF PROPOSED
STATE HIGHWAY

SECONDARY PROJECT

TOWN OF LONDONDERRY
COUNTY OF WINDHAM
VERMONT ROUTE 8
LONDONDERRY-WESTON ROAD

BEGINNING AT A POINT 150 FEET NORTHERLY OF THE INTERSECTION OF VERMONT ROUTE 11 AND VERMONT ROUTE 8 AND EXTENDING NORTHERLY 7,451.7 FEET

LENGTH OF PROJECT 7,451.7 FT. = 1.411 MILES

FED. ROAD DIV. NO.	STATE	PROJ. NO.	FISCAL YEAR	SHEET NO.	TOTAL SHEETS
1	VT.	8242	1952	1	32

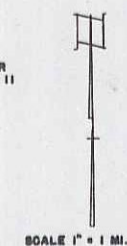
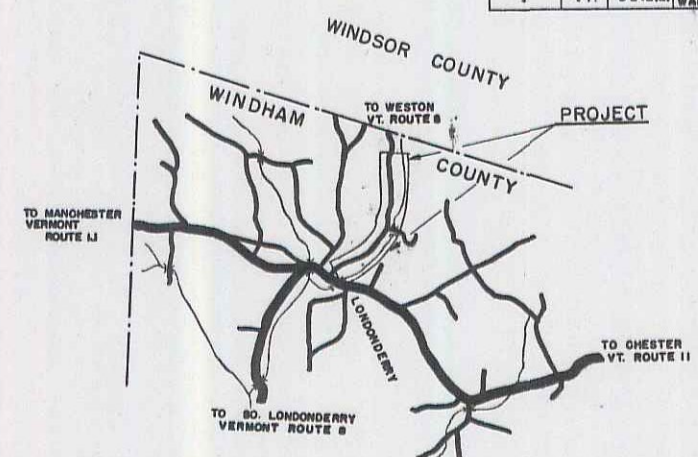

PROJECT NAME AND NUMBER	TYPE	PAVEMENT AREA
LONDONDERRY S-242-(2)	DOUBLE TRACK	1,668.9 SQ. YD.
RECORD PLANS		
MATERIALS		
STONE-VT SAND-GRAVEL	GRAVEL	MERRILL PIT
ADKINGHAM VT		LONDONDERRY VT
LAMP-KOOPER'S PRODUCTS CO		
EVERETT MASS.		
P.C.P. - VT CONCRETE PIPE		
CO. WINDSOR VT		
WINDMORSE CONSTRUCTION		CONTRACT DATED JUNE 13, 1952
LUZERNE CO.		" STARTED JULY 26, 1952
RES. ENGR. - R. J. WOODWARD		" COMPLETED OCT 12, 1952
RECORD PLANS BY R. J. WOODWARD		" ACCEPTED NOV 6, 1952

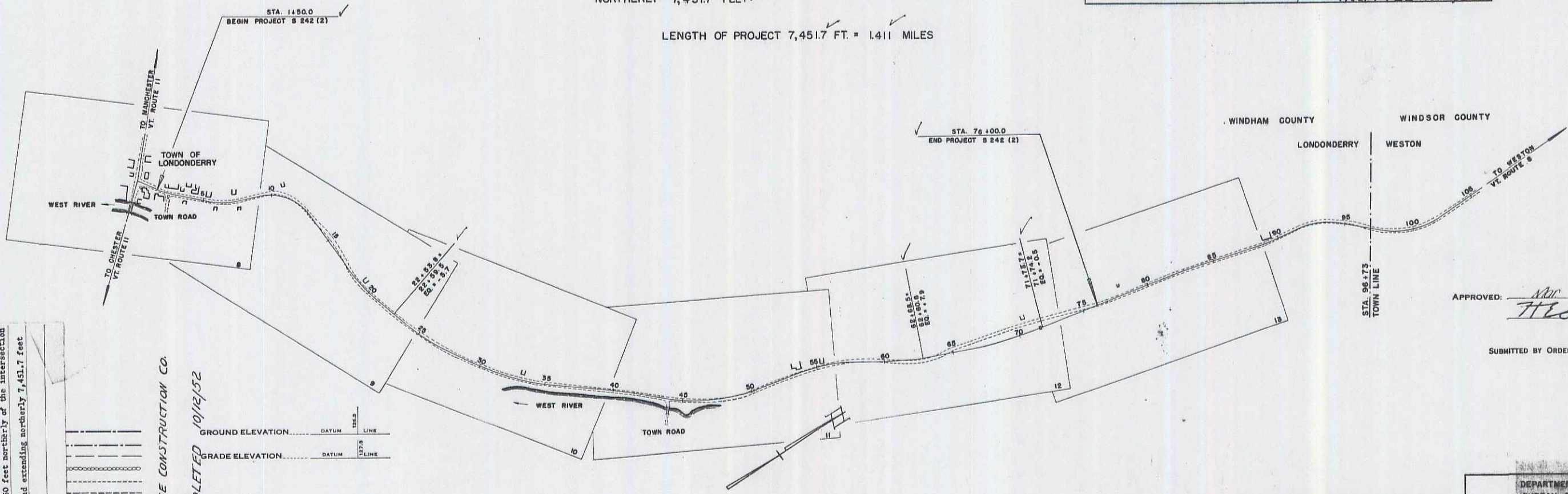

TOWN OF LONDONDERRY
COUNTY OF WINDHAM
VERMONT ROUTE 8
LONDONDERRY-WESTON ROAD

PROJECT: Londonderry
LENGTH: 7,451.7' LENGTH: 1.411 MI.
TYPE: Double Track Coat of Refined Tar With Sand-Gravel Seal,
Item S11-A
CONTRACTOR: W. H. Morse Construction & Lumber Co.
LOCATION: Beginning at a point 150 feet northerly of the intersection of Vermont Routes 11 & Vermont Route 8, and extending northerly 7,451.7 feet

LONDONDERRY S-242-(2)
CONTRACTOR - W. H. MORSE CONSTRUCTION CO.
RECORD PLANS
CONSTRUCTION COMPLETED 10/12/52

CURVE DATA

DEFLECTION ANGLE Δ
DEGREE OF CURVE D
RADIUS OF CURVE R
TANGENT DISTANCE T
LENGTH OF CURVE L
EXTERNAL DISTANCE E
POINT OF INTERSECTION P. I.
POINT OF CURVE P. C.
POINT OF TANGENT P. T.
POINT ON TANGENT P. O. T.

SCALES

TITLE	1" = 400'
TYPICAL	1" = 2'
PLAN	1" = 80'
PROFILE HORIZONTAL	1" = 80'
PROFILE VERTICAL	1" = 10'
CROSS SECTIONS	1" = 5'

APPROVED: *Nov 17 1952*
H. E. Sargent
CHIEF ENGINEER.
SUBMITTED BY ORDER OF THE STATE HIGHWAY BOARD

THESE PLANS ARE SUBJECT TO SUCH REVISIONS AS MAY BE REQUIRED BY THE BUREAU OF PUBLIC ROADS OR THE COMMISSIONER OF HIGHWAYS.

CONSTRUCTION IS TO BE CARRIED ON IN ACCORDANCE WITH THE PLANS AND THE STANDARD ROAD AND BRIDGE SPECIFICATIONS OF 1948, AS APPROVED JULY 28 1949 BY THE BUREAU OF PUBLIC ROADS INCLUDING ALL SUBSEQUENT APPROVED REVISIONS AND SUCH REVISED SPECIFICATIONS AND SPECIAL PROVISIONS AS ARE SUBMITTED WITH THE PLANS.

DEPARTMENT OF COMMERCE
BUREAU OF PUBLIC ROADS

RECOMMENDED FOR APPROVAL

DISTRICT ENGINEER DATE

APPROVED

DIVISION ENGINEER DATE

PROJECT S NO. 842 (2) FILED
SHEET 1 OF 32

APPROVED <i>Jan 27 1952</i> CONSTRUCTION ENGINEER	APPROVED <i>Feb 26 1952</i> SECONDARY ENGINEER	APPROVED <i>Nov 26 1952</i> HIGHWAY ENGINEER	APPROVED <i>Nov 7 1952</i> DISTRICT ENGINEER
--	---	---	---

1A 2