

DATE: \_\_\_\_\_  
 BY: \_\_\_\_\_  
 CHECKED: \_\_\_\_\_  
 NO. \_\_\_\_\_

DATE: 4/83  
 BY: L. G. GILLESPIE  
 CHECKED: G. W. HARRIS  
 NO. \_\_\_\_\_

1 1/2" Bituminous Concrete Pavement, Item 361 - Mod.  
 18" Sub-base of Crushed Rock, Item 204 Mod.  
 12" Granular Borrow, Item 105 - In Fill  
 12" Sub-base of Sand, Item 202 Mod. (In Cut)  
 SUB-BASE OF GRAVEL, ITEM 201 MOD  
 To be placed as noted on the plans or as directed by the Engineer

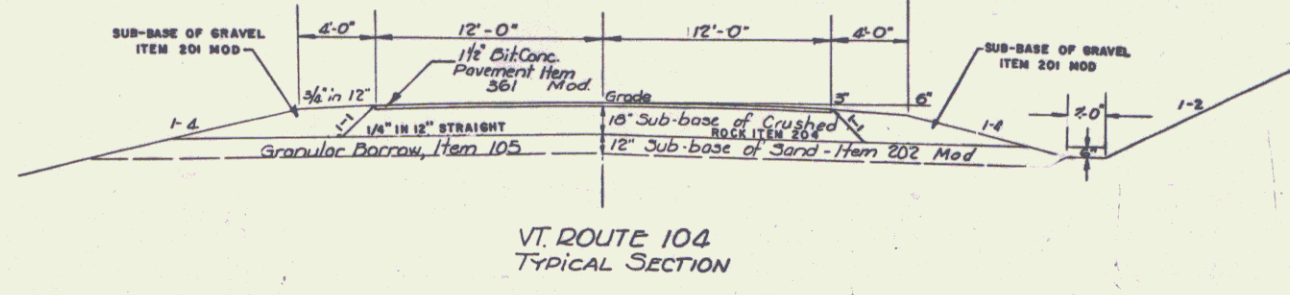

VT ROUTE 104  
 TYPICAL SECTION

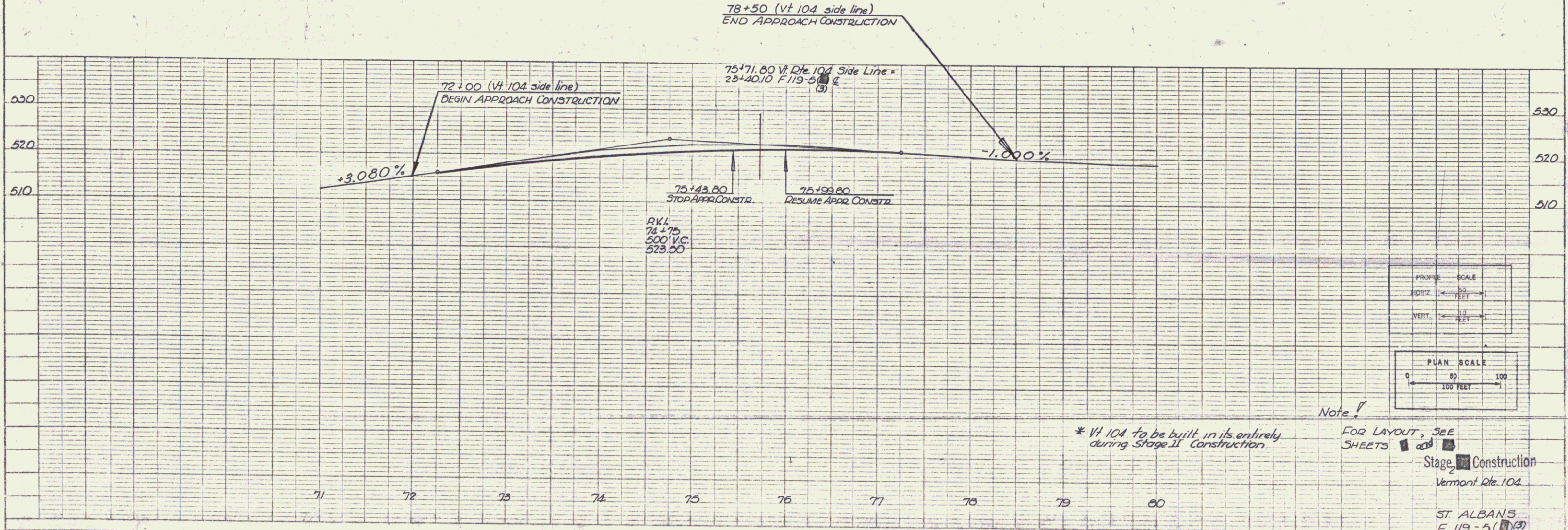

\* Vt 104 to be built in its entirety during Stage II Construction

Note!  
 FOR LAYOUT, SEE SHEETS 100 and 101  
 Stage II Construction  
 Vermont Dte 104  
 ST. ALBANS  
 F 119-5(1)(3)  
 Sheet 100 of 103