

DATE	
BY	
CHECKED	
APPROVED	
PROJECT	
NO.	
SCALE	

DRILLING & BLASTING of SOLID ROCK
 SUBGRADE, ITEM 115
 64+00 - 68+00
 63+25 - 67+92

* Seeding, Item 611
 Fertilizer, Item 615
 Topsoil, Item 621
 63+00 - 65+00 Island

* VERTICAL CURB
 67+50 - 68+05 Lt. Rd.
 *SLOPE EDGING
 63+00 - 67+63

* JUTE MATTING, ITEM 625
 63+00 - 63+75 Lt.
 63+00 - 64+75 Lt.

DEMOLITION / DISPOSAL of BLDGS, IT 506
 66+55 Lt. ✓
 67+00 Lt. ✓
 67+20 Lt. ✓
 67+50 Lt. ✓
 67+70 Lt. ✓
 67+75 Lt. ✓
 68+50 Lt. ✓
 67+15 Lt. ✓
 67+50 Lt. ✓

* Bituminous Concrete Surface for Buffers
 and Traffic Islands, Item 334 Mod.
 65+00 - 67+50 Island

CHAIN LINK FENCE
 63+00 - 67+30 Lt. (450 LF x 6' High)
 63+00 - 67+30 Lt. (450 LF x 6' High)

* Standard Steel Beam Guard Rail, Item 545-A (6'3" c/c)
 39+05 - 40+15 Lt. Rd.
 * Install Overhead Traffic Sign Support, Item 703
 40+00 US 7

CONTROL OF ACCESS IS COMPLETE
 ON THIS SHEET, EXCEPT AT STA. 68+05.00

* 5" One Course Cement Concrete
 Sidewalk, Item 550
 67+50 Appr Lt - 30+42 US 7 Rt.
 67+50 Appr Rt - 40+00 US 7 Rt.

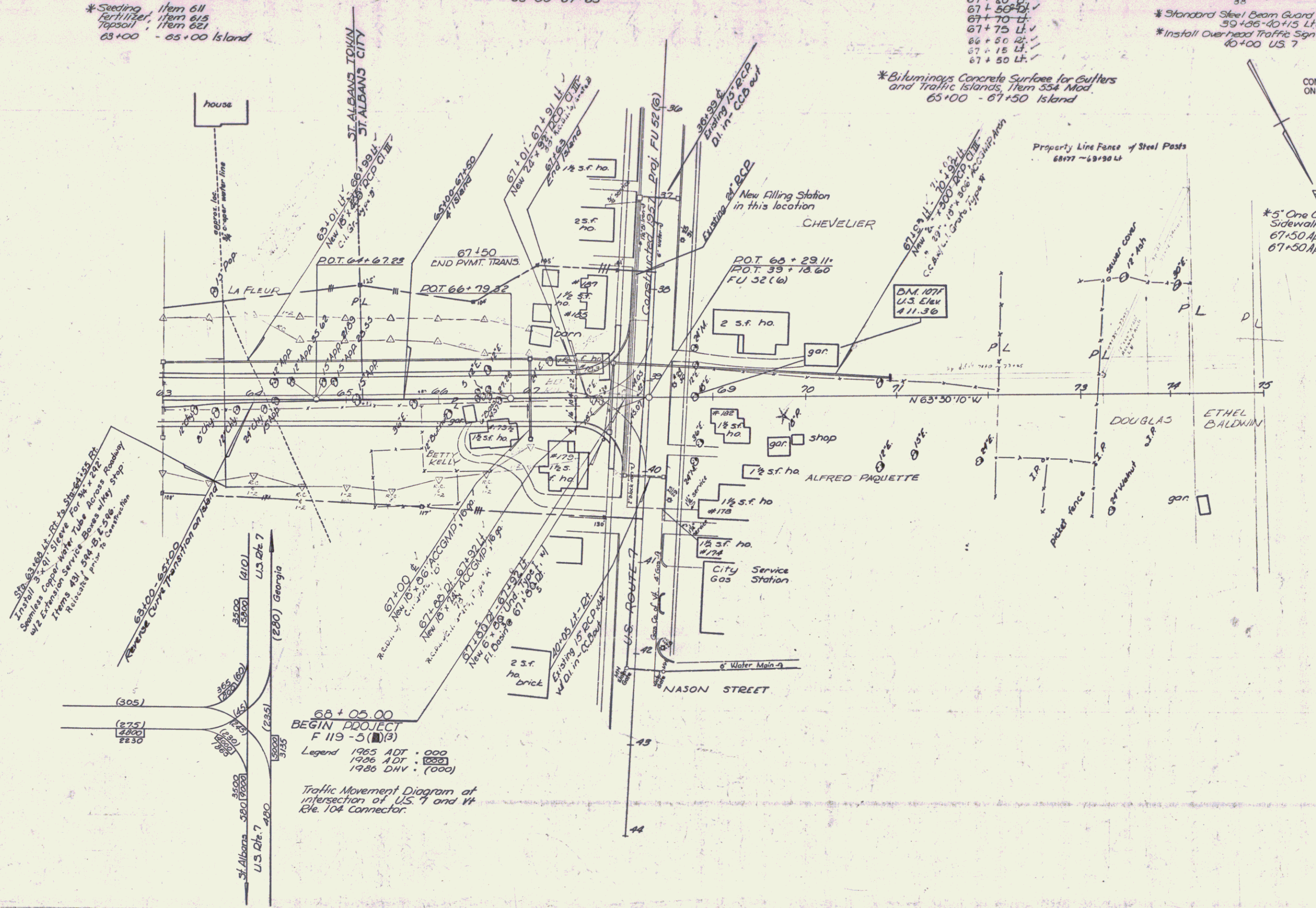

Site 63+00 Lt. Rd. to Streeting Pt.
 Install 9" x 41" Slaves for 12" x 12" x 12"
 Swales as Cooper Water Tube Across Roadway
 w/ Expansion Service Above Utility Stop.
 Items 611, 615, 621, 625, 626, 627, 628, 629, 630, 631, 632, 633, 634, 635, 636, 637, 638, 639, 640, 641, 642, 643, 644, 645, 646, 647, 648, 649, 650, 651, 652, 653, 654, 655, 656, 657, 658, 659, 660, 661, 662, 663, 664, 665, 666, 667, 668, 669, 670, 671, 672, 673, 674, 675, 676, 677, 678, 679, 680, 681, 682, 683, 684, 685, 686, 687, 688, 689, 690, 691, 692, 693, 694, 695, 696, 697, 698, 699, 700, 701, 702, 703, 704, 705, 706, 707, 708, 709, 710, 711, 712, 713, 714, 715, 716, 717, 718, 719, 720, 721, 722, 723, 724, 725, 726, 727, 728, 729, 730, 731, 732, 733, 734, 735, 736, 737, 738, 739, 740, 741, 742, 743, 744, 745, 746, 747, 748, 749, 750, 751, 752, 753, 754, 755, 756, 757, 758, 759, 760, 761, 762, 763, 764, 765, 766, 767, 768, 769, 770, 771, 772, 773, 774, 775, 776, 777, 778, 779, 780, 781, 782, 783, 784, 785, 786, 787, 788, 789, 790, 791, 792, 793, 794, 795, 796, 797, 798, 799, 800, 801, 802, 803, 804, 805, 806, 807, 808, 809, 810, 811, 812, 813, 814, 815, 816, 817, 818, 819, 820, 821, 822, 823, 824, 825, 826, 827, 828, 829, 830, 831, 832, 833, 834, 835, 836, 837, 838, 839, 840, 841, 842, 843, 844, 845, 846, 847, 848, 849, 850, 851, 852, 853, 854, 855, 856, 857, 858, 859, 860, 861, 862, 863, 864, 865, 866, 867, 868, 869, 870, 871, 872, 873, 874, 875, 876, 877, 878, 879, 880, 881, 882, 883, 884, 885, 886, 887, 888, 889, 890, 891, 892, 893, 894, 895, 896, 897, 898, 899, 900, 901, 902, 903, 904, 905, 906, 907, 908, 909, 910, 911, 912, 913, 914, 915, 916, 917, 918, 919, 920, 921, 922, 923, 924, 925, 926, 927, 928, 929, 930, 931, 932, 933, 934, 935, 936, 937, 938, 939, 940, 941, 942, 943, 944, 945, 946, 947, 948, 949, 950, 951, 952, 953, 954, 955, 956, 957, 958, 959, 960, 961, 962, 963, 964, 965, 966, 967, 968, 969, 970, 971, 972, 973, 974, 975, 976, 977, 978, 979, 980, 981, 982, 983, 984, 985, 986, 987, 988, 989, 990, 991, 992, 993, 994, 995, 996, 997, 998, 999, 1000

68+05.00
 BEGIN PROJECT
 F 119-5(1)(3)

Legend
 1965 ADT - (000)
 1966 ADT - (000)
 1986 DHV - (000)

Traffic Movement Diagram at
 intersection of US 7 and Wt
 Ele. 104 Connector.

NOTE:
 * - Indicates items to be
 included in Stage II const.

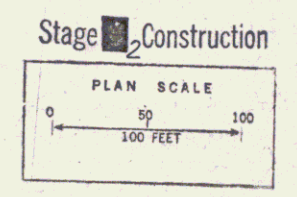

ST. ALBANS
 F 119-5(1)(3)
 Sheet 28 of 31