

PLAN OF  
BARROWS MILL  
ROUTE 100 IN STOCKBRIDGE, VT  
0.3 MILE NORTH OF JUNCTION  
WITH ROUTE 107  
SCALE 1" = 20'

SURVEY BY E. STICKNEY  
TRACED BY L. LANN

TOWN OF STOCKBRIDGE  
Project MM 22 (Barrows Mill)  
Pin # 00R803  
Route VT100  
Date 1/1/1940



SHEET (1)

1



SHEET 2

2

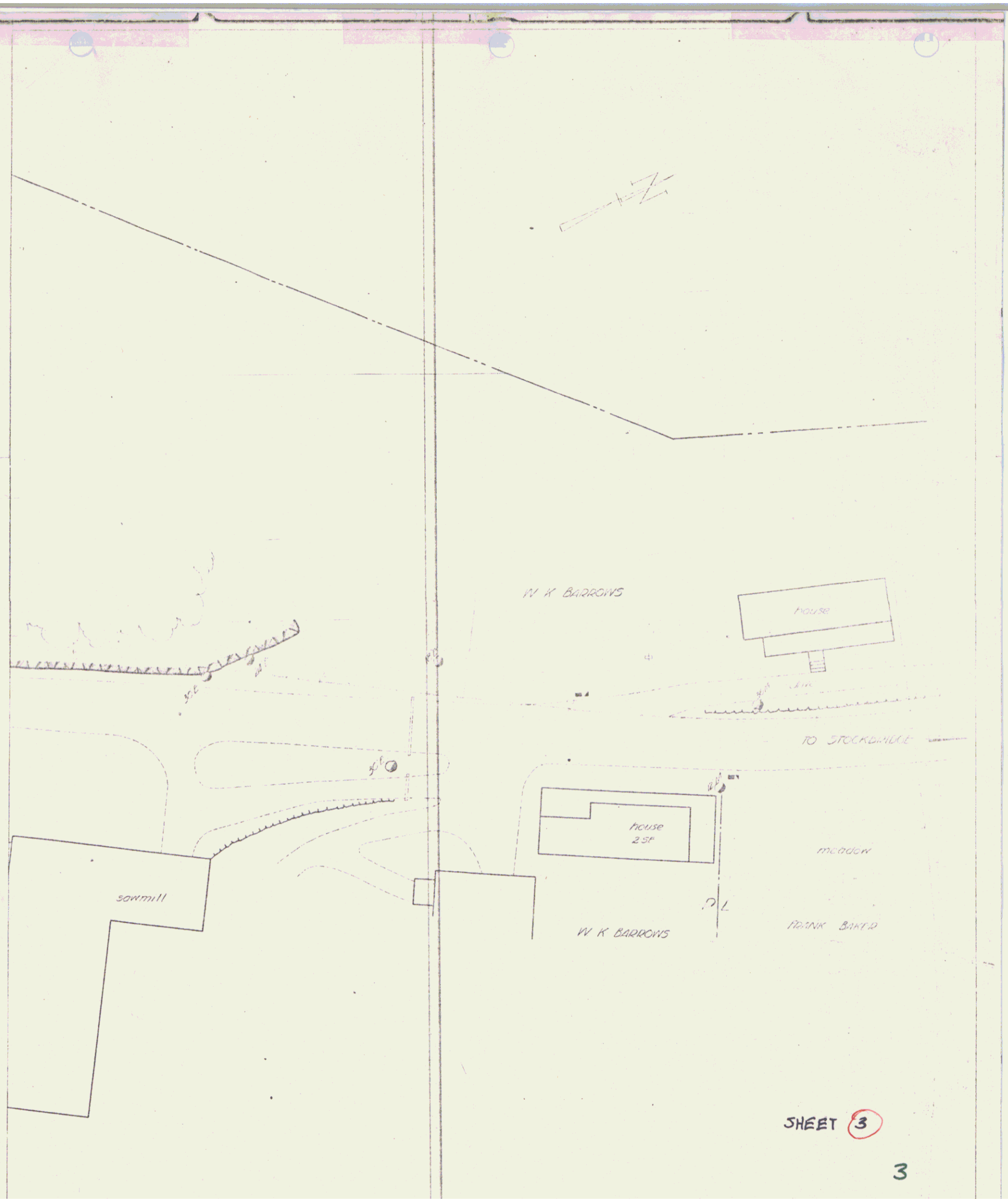

SHEET 3

3