

Project: PWA 1020-R
 Date: 10/10/1936
 Route: VT 100
 Town: Londonderry
 Proj: **JURCO 2**

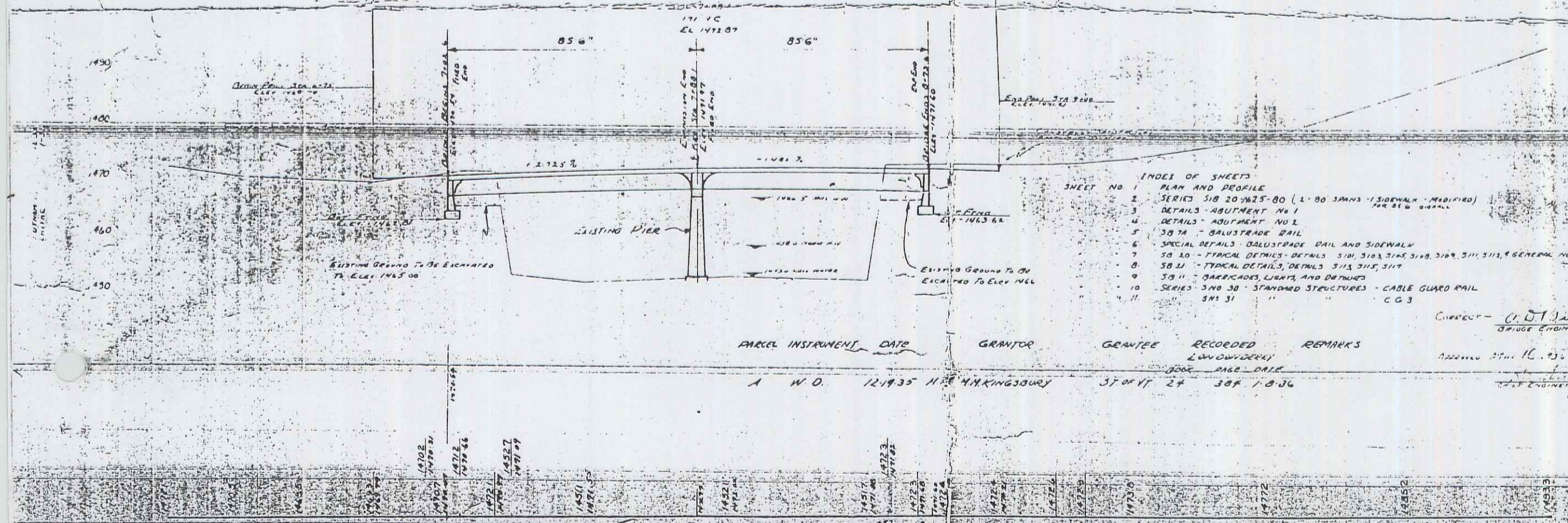

ESTIMATED QUANTITIES

ITEM NO.	DESCRIPTION	QUANTITY	UNIT
10-11	COMMERCIAL INCL. BRIDGE	50	CU YD
12	GRAVEL - 6" DEEP	30	CU YD
13	STRUCTURE EXCAVATION	25	CU YD
14	GENERAL SURFACE COURSE	30	CU YD
11A	CONCRETE CLASS A	14	CU YD
11B	CONCRETE CLASS B	75	CU YD
14	REINFORCING STEEL	37734	LB
15	STEEL TUBES 12" DIA.	5	LINEAL FEET
16	CEMENT MASONRY	25	CU YD
17	TEMPERARY BRIDGE	20	CU YD
18	CHANNEL EXCAVATION	126	CU YD

- INDEX OF SHEETS
- 1 PLAN AND PROFILE
 - 2 SERIES 318 TO 315 80 (1-80 SANS SIDEWALK - MODIFIED)
 - 3 DETAILS - ABUTMENT NO. 1
 - 4 DETAILS - ABUTMENT NO. 2
 - 5 30 74 - BALUSTRADE RAIL
 - 6 SPECIAL DETAILS - BALUSTRADE RAIL AND SIDEWALK
 - 7 30 10 - TYPICAL DETAILS - DETAILS 318, 319, 318, 319, 311, 312, 9 GENERAL NOTES
 - 8 30 11 - TYPICAL DETAILS - DETAILS 318, 319, 319
 - 9 30 11 - BARRICADES, LIGHTS AND DETAILS
 - 10 SERIES 318 TO 315 - STANDARD STRUCTURES - CABLE GUARD RAIL
 - 11 318 31

BRIDGE DATA

ITEM	PRESENT	PROPOSED
SPAN	20.66'	19.85'
CLEAR HEIGHT	16'	16'
PIERCEWAY	2112'	2112'
LENGTH OVERALL	1331'	148'
ROADWAY WIDTH	16'	20' - 1.5"
PER CONC. CENTER LINE	19'	2
LOOSE STONE SURF		2

RIGHT-OF-WAY DIVISION
 TOWN FILE
 PERPETUAL
 Town of Londonderry
 (To Be Returned to R.O.W. Division)

