

INDEX OF SHEETS

SHEET NO. 1	TITLE PAGE
" 2	TYPICAL CROSS-SECTION OF IMPROVEMENT (24' GRAVEL)
" 3	PLAN AND PROFILE
" 4	STB. 20-35 (SQUARE)
" 5	STB. 20-50 (")
" 6	SB 4 SOLID RAIL
" 7-10	ABUTMENT DETAILS
" 11	SB 2 TYPICAL DETAILS
" 12-13	CROSS SECTIONS
" 14	STANDARD STRUCTURES S-19

FED. ROAD DIST. NO.	STATE	FED. AID PROJ. NO.	FISCAL YEAR	SHEET NO.	TOTAL SHEETS
9	VT.	119-A	1928	1	14

STATE OF VERMONT
STATE HIGHWAY DEPARTMENT

PLAN AND PROFILE OF PROPOSED
STATE HIGHWAY
FEDERAL AID PROJECT

TOWN OF JOHNSON

JOHNSON - NEWPORT ROAD

TWO BRIDGES OVER THE GIHON RIVER
LOCATED IN EAST JOHNSON VILLAGE

LENGTH 500.0 FEET = 0.094 MILES



MP 1.00
RIGHT-OF-WAY DIVISION
TOWN FILE
Rte. PERPETUAL
Town of VT 100C
(To Be Returned To R.O.W. Division)

MP 0.944-1.039

APPROVED: MAY 25, 1928
H. E. Sargent
CHIEF ENGINEER
SUBMITTED BY ORDER OF THE STATE HIGHWAY BOARD
H. J. Balch
COMMISSIONER OF HIGHWAYS

SCALES
PLAN 1 in = 20 FEET
VERT. 1 in = 20 FEET
PROFILE HORIZ. 1 in = 20 FEET
SECTIONS 1 in = 5 FEET

LAYOUT
SEE SHEET 3

THIS PROJECT TO BE CONSTRUCTED IN ACCORDANCE WITH
STANDARD SPECIFICATIONS ON FILE WITH THE U. S.
BUREAU OF PUBLIC ROADS.

STRUCTURES ON THIS PROJECT TO BE CONSTRUCTED IN
ACCORDANCE WITH DETAILS GIVEN ON STANDARD
STRUCTURE SHEETS SERIES Nos. S17-18-19

DISTRICT No. 3
BRIDGE No. 37-36
JOHNSON

RECOMMENDED [Signature]
DISTRICT ENGINEER BUREAU OF PUBLIC ROADS
RECOMMENDED FOR APPROVAL [Signature]
CHIEF ENGINEER BUREAU OF PUBLIC ROADS

Pin # OOR 793
Route VT 100C
Date 5/25/1928

APPROVED [Signature]
DIRECTOR - BUREAU OF PUBLIC ROADS

SERIES F. No. 119-A FILED
SHEET 1 OF 14

CONVENTIONAL SIGNS

- COUNTY LINE
- TOWN LINE
- FENCE LINE
- STONE WALL
- UNFENCED PROPERTY
- GUARD RAIL
- TRAVELED WAY
- RAILROAD
- RETAINING WALL
- CENTER LINE
- SURVEY LINE
- CULVERT
- DROP INLET
- TROLLEY POLE
- POWER POLE
- TELEPHONE POLE
- TREES
- HEDGE

- GROUND ELEVATION
- GRADE ELEVATION

- CURVE DATA
- DEFLECTION ANGLE
 - DEGREE OF CURVE
 - RADIUS OF CURVE
 - TANGENT DISTANCE
 - LENGTH OF CURVE
 - EXTERNAL DISTANCE
 - POINT OF INTERSECTION
 - POINT OF CURVE
 - POINT OF TANGENT
 - POINT ON TANGENT

DIST # 8 PLANS

WOODEN GUARD RAIL REQUIRED

STATION	TO	LENGTH
2:08	2:30	22 LIN. FT.
2:49	3:75	108
4:29	5:00	30
TOTAL 160		

STATION	TO	LENGTH
2:14	2:30	16 LIN. FT.
2:49	3:75	108
4:30	4:00	36
TOTAL 160		

GRAVEL SURFACE COURSE REQUIRED
ESTIMATED QUANTITY 245 CU YDS.

SURVEY	REVISED
Δ = 18°-08'	20°-30'
D = 14°-30'	10'
T = 63.1'	57.0'
L = 125.1'	141'
E = 5.0'	5.2'

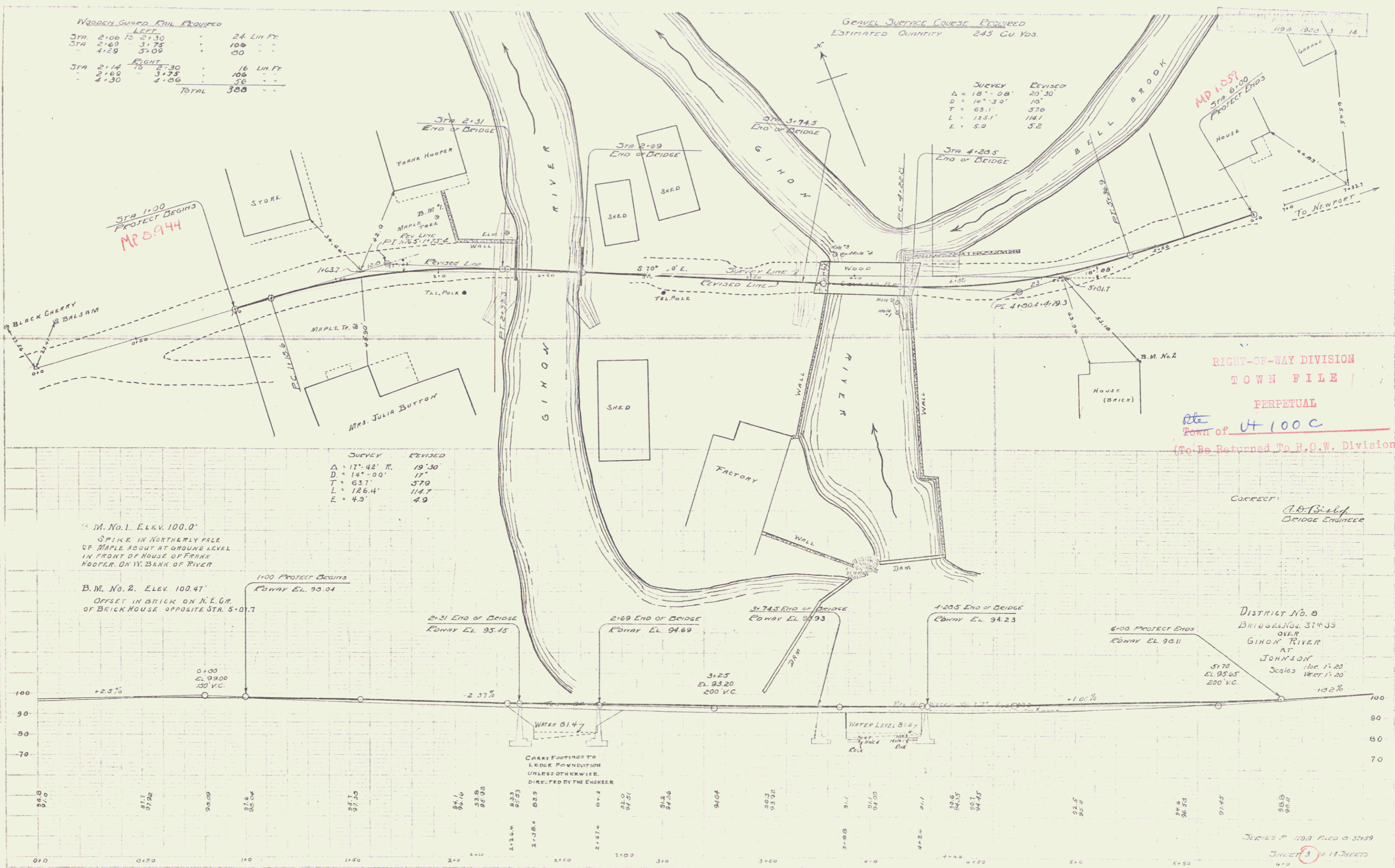

M. No. 1. ELEV. 100.0'
SPIKE IN NORTHERLY FACE
OF MAPLE ABOUT AT GROUND LEVEL
IN FRONT OF HOUSE OF FRANK
HOOPER, ON W. BANK OF RIVER

B.M. No. 2. ELEV. 100.47'
OFFSET IN BRICK ON N.E. COR.
OF BRICK HOUSE OPPOSITE STA. 5+0.17

RIGHT-OF-WAY DIVISION
TOWN FILE
PERPETUAL
Town of Ut 100 C
(To Be Returned To R.O.W. Division)

Corrected
A.B. Seelye
BRIDGE ENGINEER

DISTRICT No. 5
BRIDGES Nos. 31*35
OVER
GIRON RIVER
AT
JOHNSON
Scale: 1" = 20'
Vertical: 1" = 20'

Series P 1193 Filed 3-27-39
Sheet 3 of 11 Sheets
610