

2 Cable Guard Rail  
 515+50-519+66 Lt - 416'  
 520+36-520+60 Lt - 24'  
 520+32-521+48 Rt - 96'  
 524+83-528+00 Rt - 317'

Construct Drive  
 Sta 522+00 Lt  
 Sta 522+00 Rt  
 C & R TREE  
 ITEM 110  
 Removing & Resetting C.G.R.  
 519+67-520+36 Lt - 69'  
 519+27-520+52 Rt - 125'

Limits of Stone Fill for Slope Protection  
 Item 521 C  
 Sta 515+75 to 516+75 Lt  
 Sta 526+00-528+00 Rt  
 Removal & Disposal of G.R.  
 524+80-526+68 Rt - 188'

#21D  
 EDWIN R. & BEULAH N. PUTNAM  
 STA 525+08-526+43  
 0.25 ACRE ±  
 W.D.O.E. 8/24/56  
 RECORDED: PLYMOUTH-BK27-  
 PGS 251/252 9/10/56

#21B  
 EDWIN R. & BEULAH N. PUTNAM  
 STA 525+08-526+43  
 0.04 ACRE ±  
 W.D.O.E. 10/20/55  
 RECORDED: PLYMOUTH-BK 27-  
 PGS 197/198 11/5/55

#22B  
 ARNOLD J. & SHIRLEY M. SAILER  
 STA 526+43-528+00  
 0.09 ACRE ±  
 W.D.O.E. 10/22/55  
 RECORDED: PLYMOUTH-BK 27- PGS 199/200  
 11/5/55

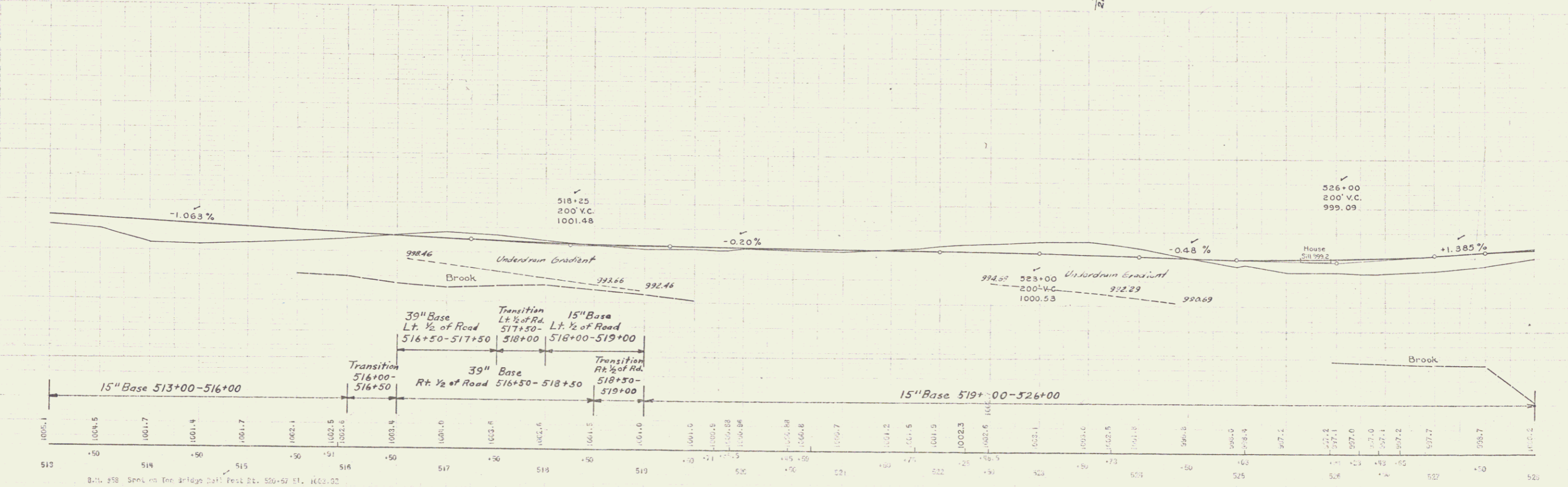
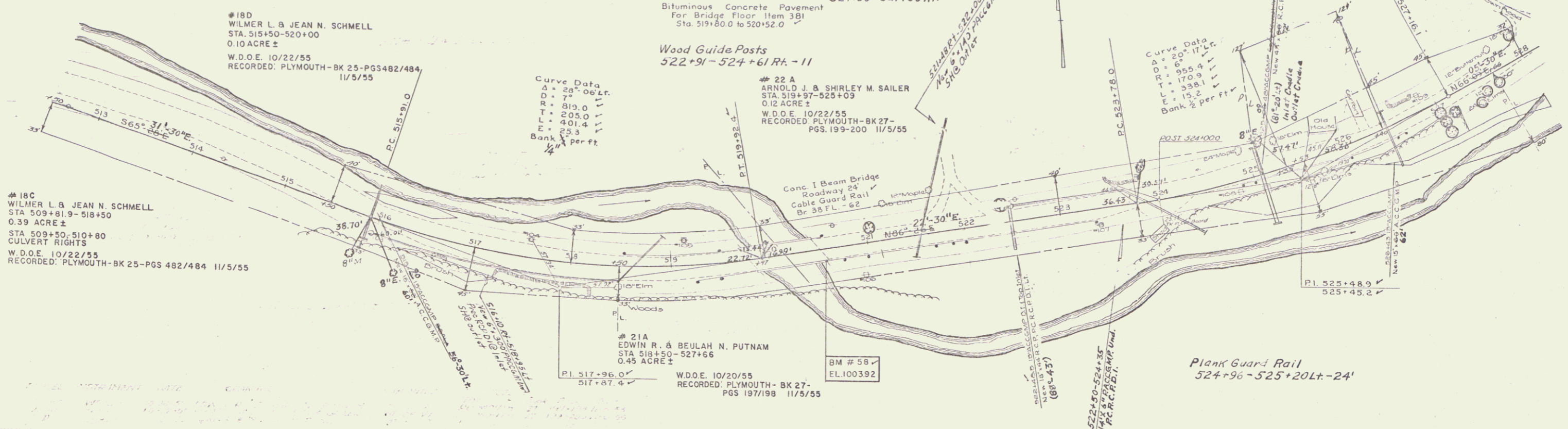

8 1/2" x 11" Scale on Two Bridges 2 1/2" East of Sta. 520+50 ST. 11/10/52