

Removing & Resetting C.G.R.
 417+22-417+41 Lt. - 19'
 416+95-417+29 Rt. - 34'

Channel Excavation Item 106A
 Sta. 409+00 to 409+75 Rt.
 Sta. 418+00 to 418+75 Lt. - 416+40 Rt.

Limits of Stone Fill for Slope Protection
 Item 521C
 Sta. 411+75-413+00 - Rt.

C. & R. TREE
 ITEM 110

DATE	10/22/55
SCALE	1" = 40'
SHEET	21
PROJECT	PLYMOUTH ST. BRIDGE

Wood Guide Posts
 410+15-411+43 Rt. - 9
 413+76-416+74 Rt. - 20

Limits of Clearing and Grubbing Item 104
 Sta. 409+00-412+70 Rt.
 Sta. 413+00-416+25 Rt.
 Sta. 418+00-411+30 Lt.
 Sta. 418+00-423+00 Rt.

Bituminous Concrete Pavement
 For Bridge Floor Item 381
 Sta. 417+18.0 to 417+40.0

2 Cable Guard Rail
 409+00-409+94 Rt. - 94'
 411+53-413+49 Rt. - 196'
 416+90-417+22 Lt. - 32'
 417+41-423+00 Lt. - 559'

BM # 42
 ELI270.37

BM # 7A
 1275.25

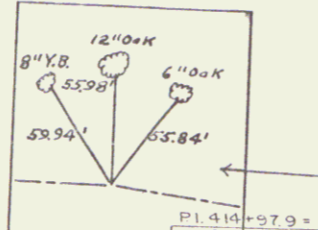

11
 CLIFFORD E. WHEELER & ELIZABETH M. WHEELER
 STA. 418+80.5
 CULVERT RIGHTS

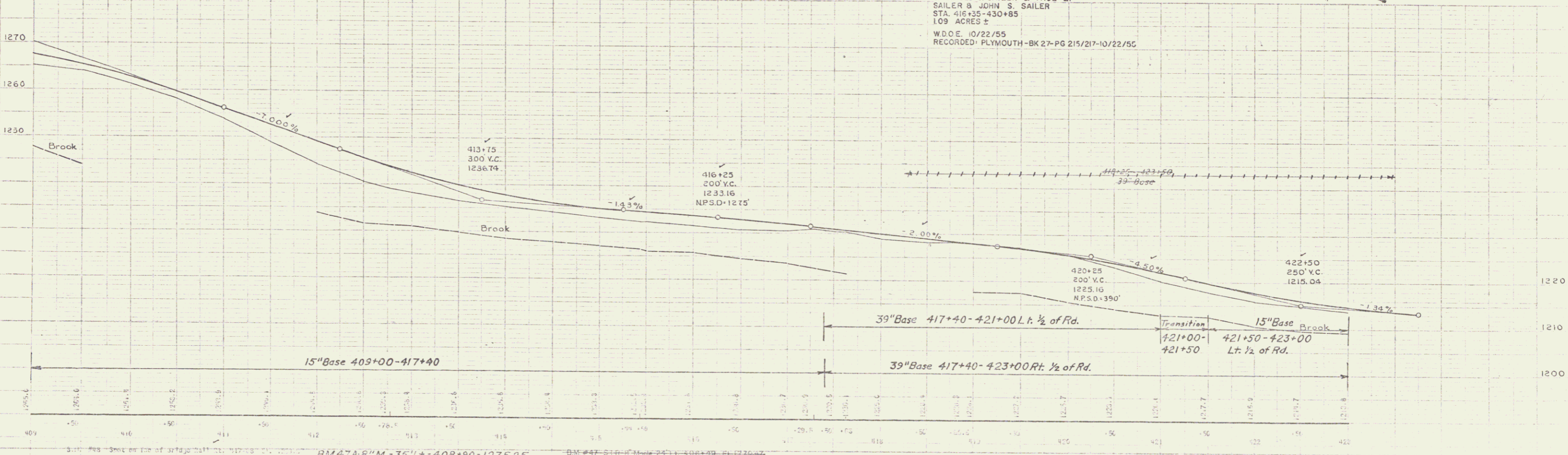
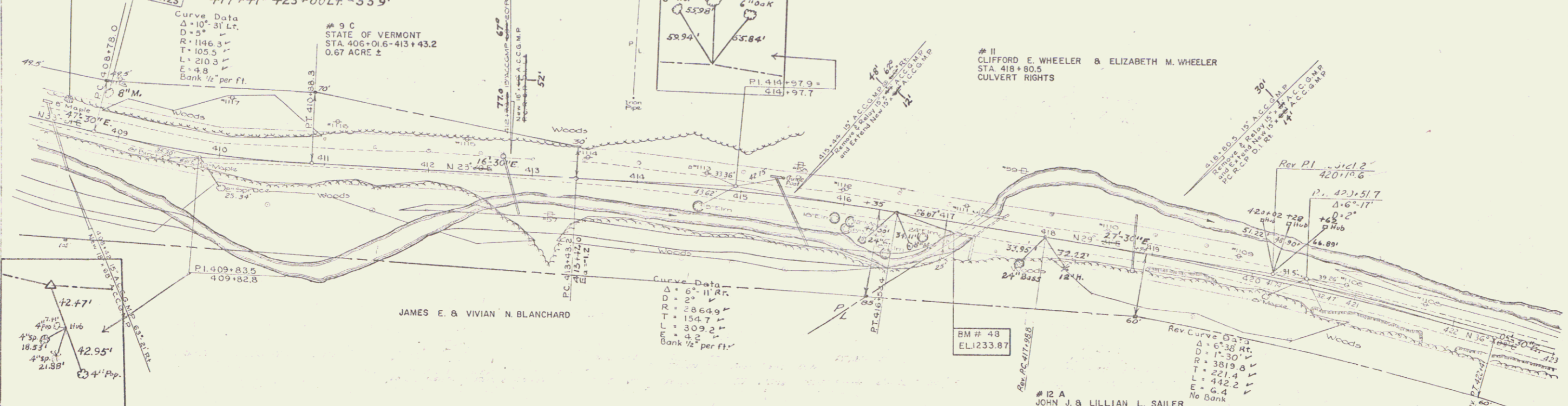

12 A
 JOHN J. & LILLIAN L. SAILER
 & ARNOLD J. SAILER & PAUL L.
 SAILER & JOHN S. SAILER
 STA. 416+35-430+85
 1.09 ACRES ±
 W.D.O.E. 10/22/55
 RECORDED - PLYMOUTH - BK 27-PG 215/217-10/22/55

Surveying
 D.H.

Surveying
 D.H.