

INDEX OF SHEETS

SHEET NO. 1	TITLE PAGE
2	TYPICAL CROSS-SECTION OF IMPROVEMENT CRUSHED GRAVEL MIXED-IN-PLACE SURFACE COURSE WITH OUTRACK ASPHALT AND PRIME COAT OF REFINED TAR ITEM 34E MOD.
3	BANKING AND WIDENING TABLES
4	QUANTITY SHEET (ITEMS)
5	QUANTITY SHEET (DRAINAGE)
6-12	EARTHWORK SHEETS
13-31	PLAN AND PROFILE SHEETS
32	CONSTRUCTION DETAILS (DRAINAGE AND MARKERS)
33	CONSTRUCTION DETAILS CD 1 (DITCHES)
34	CONSTRUCTION DETAILS CD 2 (TYPICAL SLOPE GRADINGS)
35	STANDARD STRUCTURE SHEET S-40 (BARRICADES, SIGNS AND LIGHTS)
36	STANDARD STRUCTURE SHEET S-45-45 (TWO CABLE GUARD RAIL)
37	STANDARD STRUCTURE SHEET S-49-46 (THREE CABLE GUARD RAIL W/STEEL POSTS)
38	DETAILS FOR DEAD END ANCHORAGE AT BRIDGE APPROACH
39	STANDARD STRUCTURE SHEET S 53-48 (P.C. R.C.P. DROP INLET)
40-113	CROSS-SECTIONS

STANDARD STRUCTURE SHEET APPROVED BY THE CHIEF ENGINEER, VERMONT STATE DEPARTMENT OF HIGHWAYS.
S 40 JUNE 10, 1950

STATE OF VERMONT
STATE HIGHWAY DEPARTMENT

PLAN AND PROFILE OF PROPOSED
STATE HIGHWAY

SECONDARY PROJECT

TOWN OF IRASBURG Pin#00R774
COUNTY OF ORLEANS
VERMONT ROUTE 14
IRASBURG-COVENTRY ROAD

BEGINNING AT A POINT APPROXIMATELY 23,720 FEET SOUTHERLY OF THE IRASBURG-COVENTRY TOWN LINE AND EXTENDING NORTHERLY 23,504.7 EXCLUDING BRIDGES

LENGTH OF PROJECT 23,504.7 FT. = 4.452 MILES

FED. ROAD DIV. NO.	STATE	FISCAL YEAR	SHEET NO.	TOTAL SHEETS
1	Vt.	8166(5)	1	113

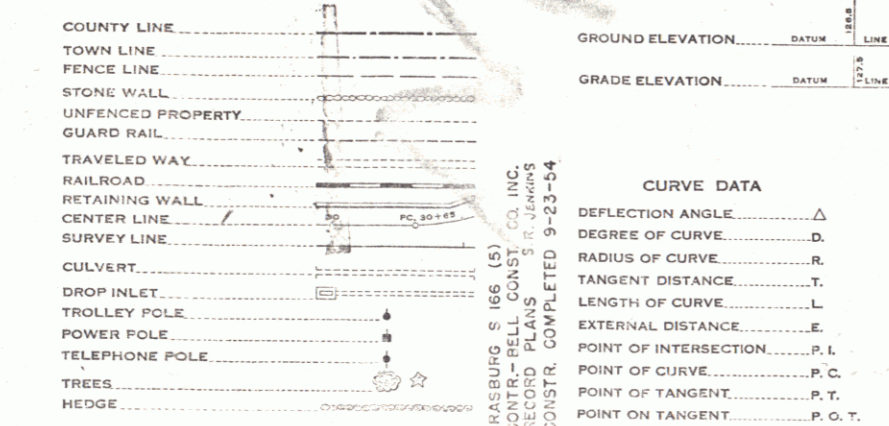
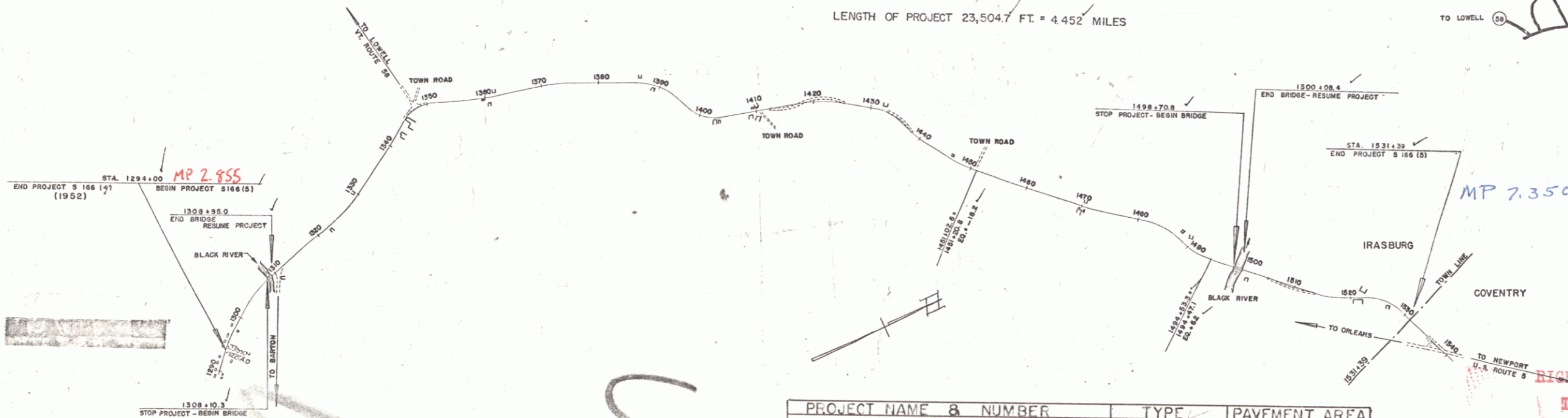
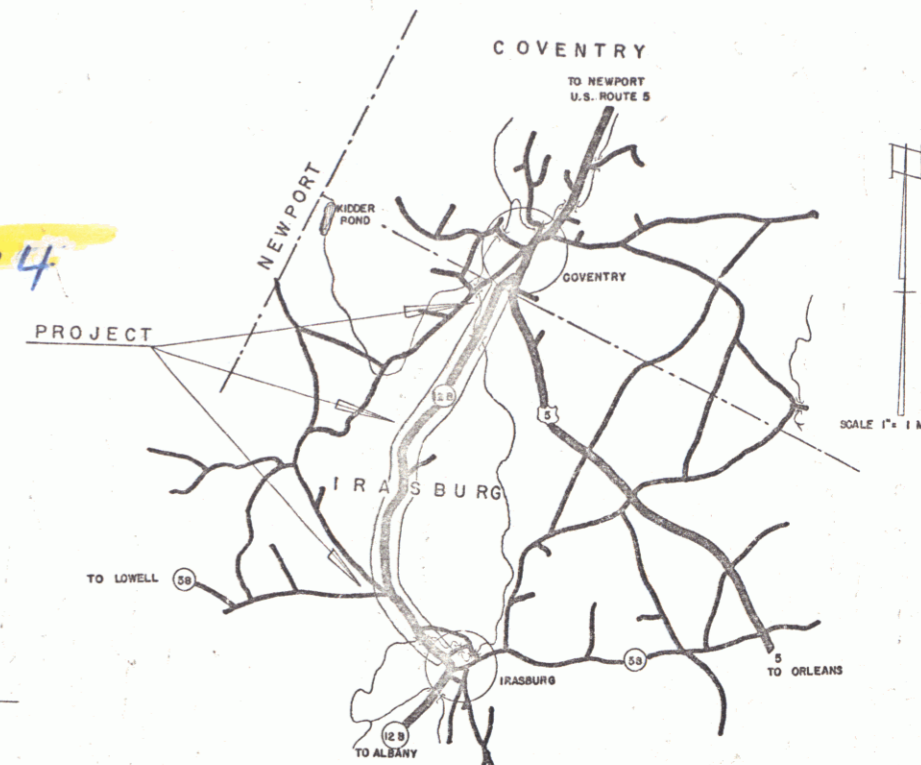

CURVE DATA

DEFLECTION ANGLE	Δ
DEGREE OF CURVE	D
RADIUS OF CURVE	R
TANGENT DISTANCE	T
LENGTH OF CURVE	L
EXTERNAL DISTANCE	E
POINT OF INTERSECTION	P.I.
POINT OF CURVE	P.C.
POINT OF TANGENT	P.T.
POINT ON TANGENT	P.O.T.

SCALES

TITLE	1" = 1000'
TYPICAL	1" = 2'
PLAN	1" = 50'
PROFILE HORIZONTAL	1" = 10'
CROSS SECTIONS	1" = 5'

PROJECT NAME & NUMBER	IRASBURG S 166 (5)	TYPE	M.P. SURFACE COURSE	PAVEMENT AREA	52,233 S.Y.
RECORD PLANS MATERIALS					
SUB-BASE OF GRAVEL	DEAN PIT, IRASBURG	A.C.C.G.M.P.	NEW ENG. METAL CULV. CO., POSTON, MASS.		
SUB-BASE OF SAND	PERRY PIT, IRASBURG	CABLE FOR G.R.	A.M. STEEL & WIRE CO., NEW HAVEN, CT.		
REFINED TARKOPPERS	SUYETTE PIT, IRASBURG	WHITE G.R. PAINT	BRADLEY LABS., BRATTLEBORO		
ASPHALT	BOONNY WAGUON, E. PROVIDENCE, R.I.	BLACK G.R. PAINT	FRANKLIN PAINT CO. FRANKLIN MASS.		
PEASTONE FOR SEAL	BOOSKA PLANT IN HANCOCK PIT, IRASBURG	M.I.P. AGGREGATES	BOOSKA PLANT IN HANCOCK PIT, IRASBURG		
REINF. STEEL	VT. STRUCT. STEEL CO. BURLINGTON	FIBRE DRAIN PIPE	BROWN CO. BURLINGTON N.H.		
R.C.P. VERMONT CONG. PIPE CORP.	WINDSOR				
CONTRACTOR	BELL CONST. CO., INC., NEWPORT, VT.	CONTRACT DATED	MAY 26, 1953		
RESIDENT ENGR	E. G. GILSON	CONTRACT STARTED	MAY 26, 1953		
INSPECTOR	G. J. GROSSETT	CONTRACT COMPLETED	SEPT. 23, 1954		
RECORD PLANS	S.P. VERMONT	CONTRACT ACCEPTED	SEPT. 24, 1954		

APPROVED: DEC 22, 1952
H.E. Sauguet
CHIEF ENGINEER

RIGHT-OF-WAY DIVISION
TOWN FILE
PERPETUAL
Town of VT 14
(To Be Returned To R.O.W. Division)

THESE PLANS ARE SUBJECT TO SUCH REVISIONS AS MAY BE REQUIRED BY THE BUREAU OF PUBLIC ROADS OR THE COMMISSIONER OF HIGHWAYS. CONSTRUCTION IS TO BE CARRIED ON IN ACCORDANCE WITH THE PLANS AND THE STANDARD ROAD AND BRIDGE SPECIFICATIONS OF 1948, AS APPROVED JULY 25, 1949 BY THE BUREAU OF PUBLIC ROADS INCLUDING ALL SUBSEQUENT APPROVED REVISIONS AND SUCH REVISED SPECIFICATIONS AND SPECIAL PROVISIONS AS ARE SUBMITTED WITH THE PLANS.

DEPARTMENT OF COMMERCE BUREAU OF PUBLIC ROADS	RECOMMENDED FOR APPROVAL
DISTRICT ENGINEER	DATE
APPROVED	
DIVISION ENGINEER	DATE

PROJECT S No. 166(5) FILED
SHEET 1 OF 113

Irasburg 151