

INDEX OF SHEETS

SHEET NO.	1	TITLE PAGE
	2	TYPICAL CROSS-SECTION OF IMPROVEMENT DOUBLE TACK COAT OF REFINED TAR WITH PEAS
	3	QUANTITY SHEET (DRAINAGE)
4-8	9-13	QUANTITY SHEET (DRAINAGE)
	14	ROADWAY STANDARD SHEET RS 56-1 (BANKING TABLES)
	15	ROADWAY STANDARD SHEET RS 56-2 (REINFORCED CONCRETE DROP INLET)
	16	ROADWAY STANDARD SHEET RS 56-3 (MARKERS)
	17	ROADWAY STANDARD SHEET RS 56-4 (DRAINAGE)
	18	ROADWAY STANDARD SHEET RS 56-5 (TYPICAL GRADING)
	19	ROADWAY STANDARD SHEET RS 56-11 (THREE CABLE GUARD RAIL)
	20	ROADWAY STANDARD SHEET RS 56-12 (BARRICADES, SIGNS AND LIGHTS)
	21	ROADWAY STANDARD SHEET RS 56-14 (PRECAST REINFORCED CONCRETE PIPE DROP INLET)
22	46	PLAN AND PROFILE SHEETS
	47	DETAILS OF CORR. GALV. METAL PLATE PIPE ARCH @ STA. 451+20
	48	DETAILS OF CORR. GALV. METAL PLATE PIPE ARCH @ STA. 682+00
49	148	CROSS-SECTIONS SHEETS

STATE OF VERMONT
DEPARTMENT OF HIGHWAYS
Proposed Improvement

TOWN OF CRAFTSBURY Pin # 00R768
COUNTY OF ORLEANS
VERMONT ROUTE 14
HARDWICK-CRAFTSBURY ROAD

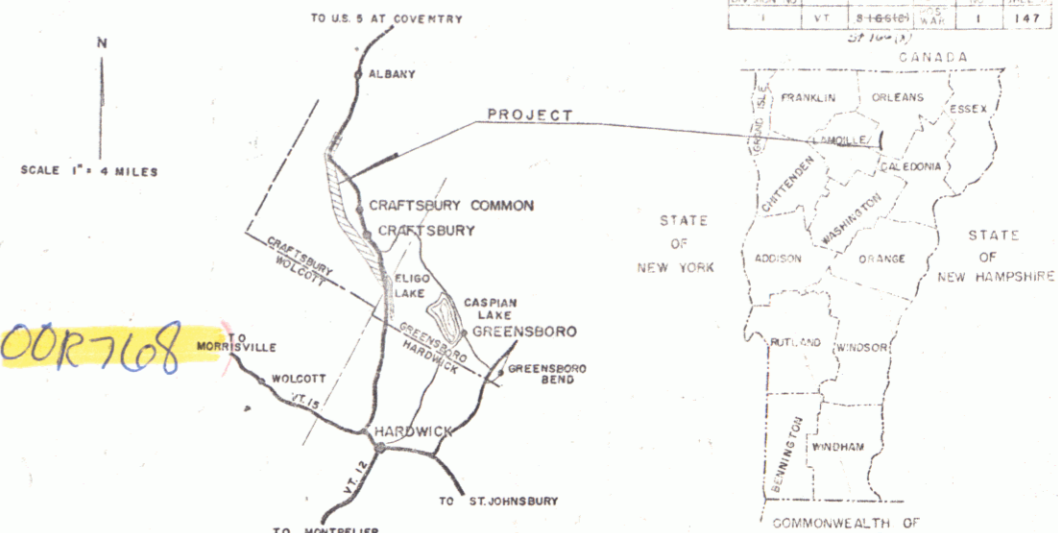

PROJECT NAME & NUMBER		PAVEMENT	AREA
CRAFTSBURY ST 166 X		DOUBLE TACK COAT OF REFINED TAR WITH PEAS	79331 sq
RECORD PLANS MATERIALS			
GRAVEL	ATHERTON Mfg. CRAFTSBURY VT. ROWELL Pitt ALBANY VT. STATE Pitt HARDWICK ROAD	C.G.M. PLATE PIPE ARCH. (REF. ENG. LAR) ACCGMP	CULVERT CO. WALPOLE, N.H.
REFINED TAR	KOPFER PRODUCTS CO. EVERETT MASS.	PACCGM UNDERDRAIN	FEDERAL SAND & GRAVEL CO. 80 GLENS FALLS, N.Y.
STEEL CABLE	AMERICAN WIRE CO.	RCP	PC RCH DI
CONTRACTOR	CALEDONIA SAND & GRAVEL CO. INC. & DOUGLAS WOOD ST. JOHNSBURY, VT.	CONTRACT DATED	NOV 2 56
RESIDENT ENG.	E. C. GLYSSON	"	STARTED NOV 2 56
RECORD PLANS	F. DEMELL	"	COMPLETED OCT 28 57
		"	ACCEPTED OCT 28 57

BEGINNING AT A POINT APPROXIMATELY 0.399 MILES NORTH OF THE GREENSBORO-CRAFTSBURY TOWN LINE AND EXTENDING NORTHERLY 35,698.9 FEET.
LENGTH OF PROJECT 35,698.9 FEET = 6.761 MILES.

Proj ST 166(X)

RIGHT-OF-WAY DIVISION
TOWN FILE
PERPETUAL
Town of U-14
(To Be Returned To R.O.W. Division)

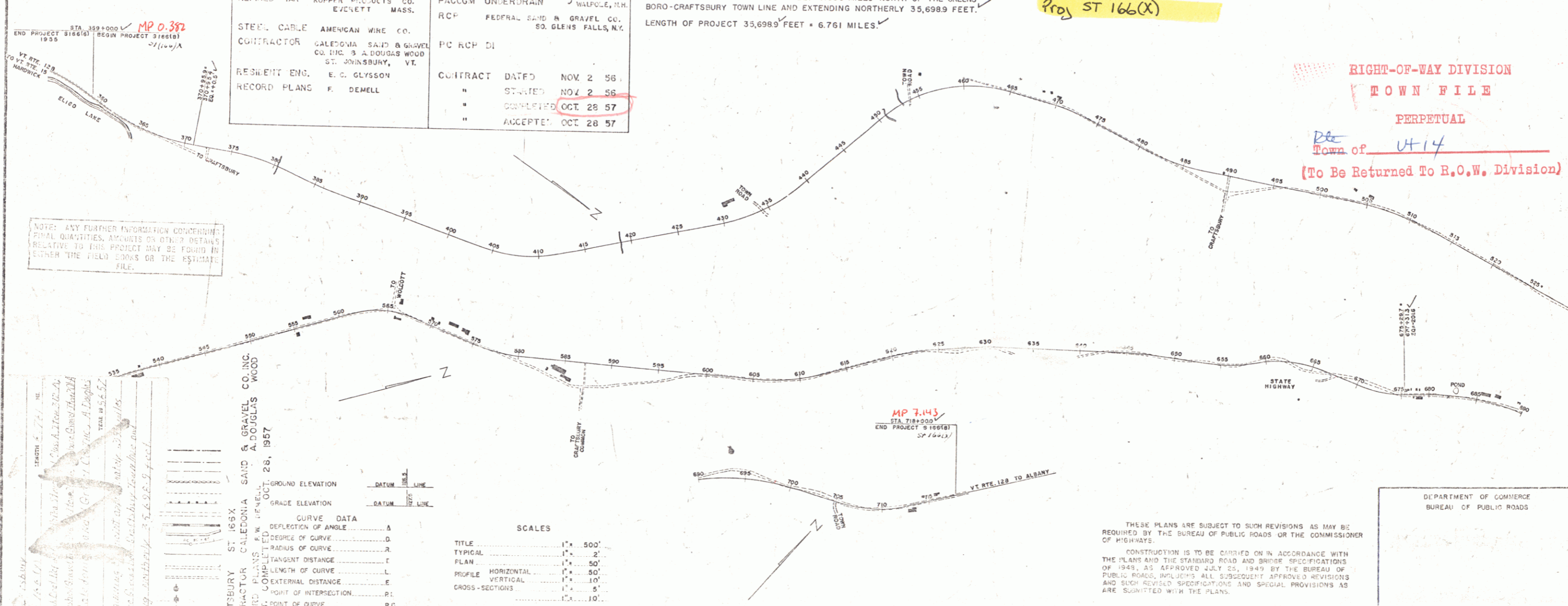

NOTE: ANY FURTHER INFORMATION CONCERNING FINAL QUANTITIES, AMOUNTS OR OTHER DETAILS RELATIVE TO THIS PROJECT MAY BE FOUND IN EITHER THE FIELD BOOKS OR THE ESTIMATE FILE.

CONTRACTOR: CALEDONIA SAND & GRAVEL CO. INC. & DOUGLAS WOOD
COMPLETED: OCT. 28, 1957

SCALES

TITLE	1" = 500'
TYPICAL	1" = 2'
PLAN	1" = 50'
PROFILE HORIZONTAL	1" = 10'
PROFILE VERTICAL	1" = 5'
CROSS-SECTIONS	1" = 10'

APPROVED [Signature] REGULATORY ENGINEER DATE 8/22/1956	APPROVED [Signature] CONSTRUCTION ENGINEER DATE 9/29/1956	APPROVED [Signature] ENGINEER DATE 9/23/56	APPROVED [Signature] CONTACT ENGINEER DATE 8/20/56	APPROVED [Signature] ENGINEER DATE 8/29, 1956	APPROVED [Signature] ENGINEER DATE 11/1/56
---	---	--	--	---	--

STEARNS R. JENKINS

U-14

DEPARTMENT OF COMMERCE
BUREAU OF PUBLIC ROADS

THESE PLANS ARE SUBJECT TO SUCH REVISIONS AS MAY BE REQUIRED BY THE BUREAU OF PUBLIC ROADS OR THE COMMISSIONER OF HIGHWAYS.

CONSTRUCTION IS TO BE CARRIED ON IN ACCORDANCE WITH THE PLANS AND THE STANDARD ROAD AND BRIDGE SPECIFICATIONS OF 1949, AS APPROVED JULY 25, 1949 BY THE BUREAU OF PUBLIC ROADS, INCLUDING ALL SUBSEQUENT APPROVED REVISIONS AND SUCH REVISED SPECIFICATIONS AND SPECIAL PROVISIONS AS ARE SUBMITTED WITH THE PLANS.

PROJECT NO. 148
SECTION 1

WEBSTER-MARTIN, INC.
SOUTH BURLINGTON, VT. 05401