

INDEX OF SHEETS

SHEET NO.	TITLE PAGE
1	TYPICAL CROSS SECTION OF IMPROVEMENT
2-3	DANKING AND WIDENING TABLES
4	QUANTITY SHEET, ITEMS
5	QUANTITY SHEET, DRAINAGE
6-7	EARTHWORK SHEETS
8-36	BRIDGE DETAILS STA. 572+03.3 TO 580+21
37-64	STANDARD STRUCTURE SHEET
65	S.S. B2 BRIDGE DETAILS
66	S.L.A.G. 30" BRIDGE DETAILS
67	S.B. 5C-1 BRIDGE DETAILS
68	S.B. 11 BRIDGE DETAILS
69	S.B. 20
70	S.C. 21
71	S. 29 BOX CULVERTS
72	S. 40 BARRICADES, SIGNS AND LIGHTS
73	S. 41 TYPICAL GRADING
74	S. 46-48 MARKERS
75	S. 47-48 RETAINING WALLS
76	S. 48-46 THREE CABLE GUARD RAIL
77	
78	
79	206 CROSS SECTIONS

STATE OF VERMONT
STATE HIGHWAY DEPARTMENT

PLAN AND PROFILE OF PROPOSED
STATE HIGHWAY
FEDERAL PROJECT

TOWNS OF WOODBURY-HARDWICK Pin# 00R761
COUNTIES OF WASHINGTON-CALEDONIA Project F 144(4)
VERMONT ROUTE 14

E. MONTPELIER-HARDWICK ROAD

BEGINNING AT A POINT 175 FEET NORTHERLY FROM THE TOWN ROAD TO THE HAMLET OF SOUTH WOODBURY AND EXTENDING NORTHERLY 36,884.8 FEET TO THE SOUTHERLY VILLAGE OF HARDWICK LIMITS.

LENGTH OF PROJECT 36,884.8 FEET 6.986 MILES

STANDARD STRUCTURE SHEET APPROVED BY CHIEF ENGINEER VERMONT STATE DEPARTMENT OF HIGHWAYS.

S-40 DEC. 18, 1945

FED. ROAD DIST. NO.	STATE	FISCAL YEAR	SHEET NO.	TOTAL SHEETS
9	VT.	144 (4)		

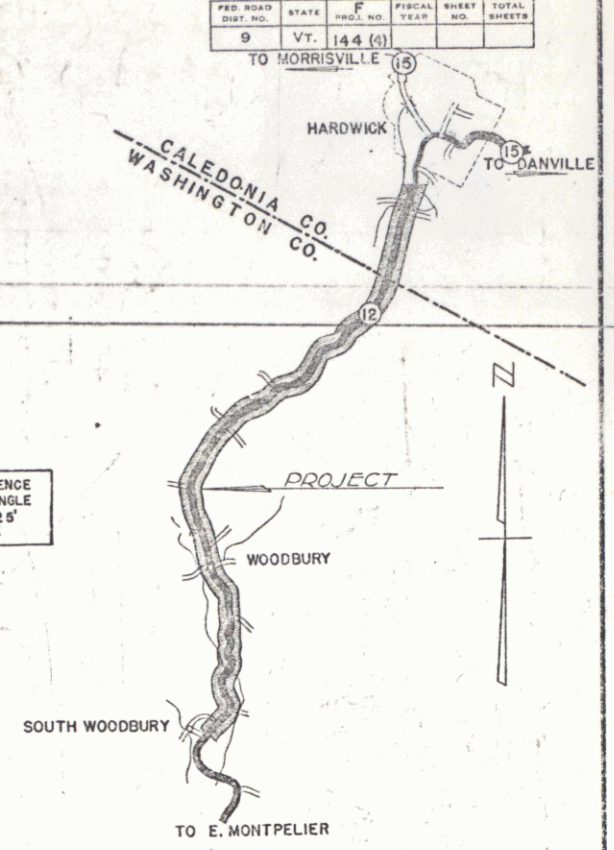

PROJECT NAME AND NUMBER	TYPE PAVEMENT AREA
WOODBURY-HARDWICK F-144(4)	MIP 83662 sy
RECORD PLANS	
MATERIALS	
CEMENT: AIR-ENTRAINED, ATLAS SAND: ASPHALT AND CONCRETE AGGREGATE CO., INC.	RCP: VT. CONC. PIPE CO., MONTPELIER, VT. ACCGMP: NEW ENGLAND METAL PIPE CO. BOSTON, MASS.
STONE: SAME	CRM: GUARRE GRANITE, WOODBURY, VT.
TAR: OLD COLONY TAR CO., WORCESTER, MA	STONE FILL: SAME
GRAVEL: MER PIT, HARDWICK, VT.	CG RAIL: BETHLEM STEEL
CONTRACTOR: A. L. DOUGHERTY CO.	CONTRACT DATED: JULY 6, 1949
INS. ENGR.: J. A. CURKEE, R. O. MUNN	CONTRACT STARTED: JULY 11, 1949
INSPECTORS: R. FUNK, C. KETCHAM, W. AUSTIN, R. DUPRESNE	CONTRACT COMPLETED: NOV. 30, 1950
RECORD PLANS BY: R. FUNK	CONTRACT ACCEPTED: FEB. 5, 1950

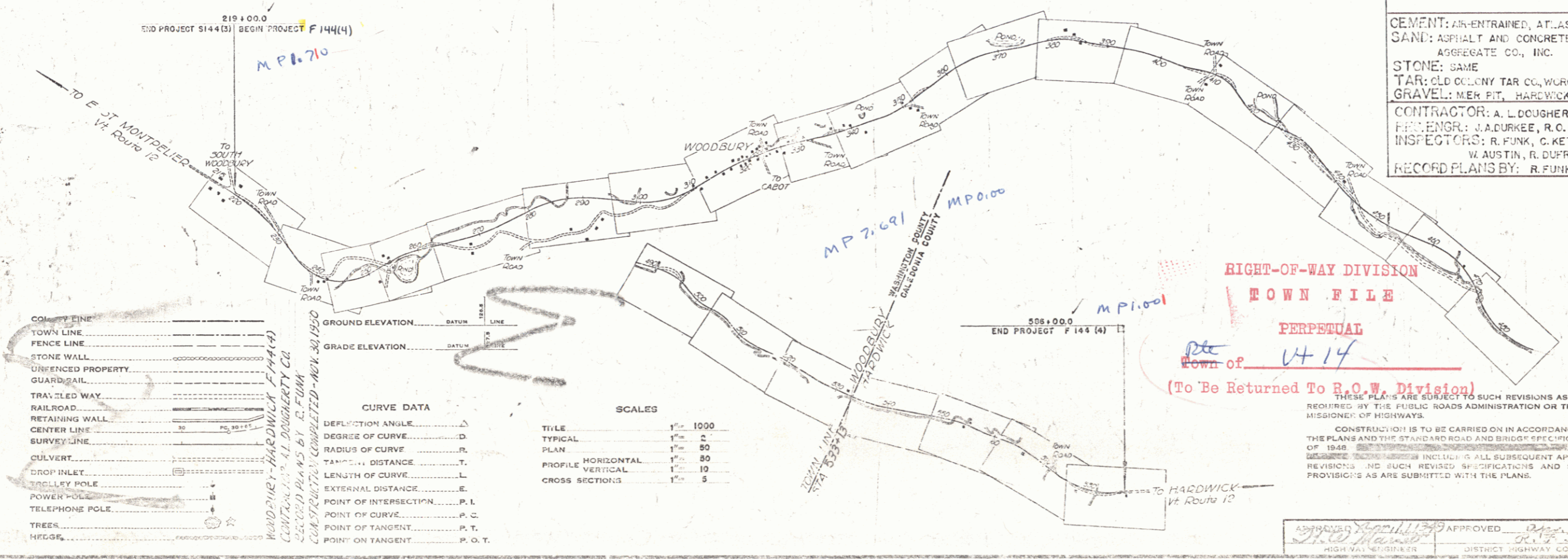

RIGHT-OF-WAY DIVISION
TOWN FILE
PERPETUAL
Town of 1414
(To Be Returned To R.O.W. Division)

THESE PLANS ARE SUBJECT TO SUCH REVISIONS AS MAY BE REQUIRED BY THE PUBLIC ROADS ADMINISTRATION OR THE COMMISSIONER OF HIGHWAYS.
CONSTRUCTION IS TO BE CARRIED ON IN ACCORDANCE WITH THE PLANS AND THE STANDARD ROAD AND BRIDGE SPECIFICATIONS OF 1949.

APPROVED: [Signature]	APPROVED: [Signature]	SERIES F No. 144(4) FINED
HIGHWAY ENGINEER	DISTRICT HIGHWAY COMMISSIONER	SHEET 0

1414 1