

INDEX OF SHEETS			
SHEET	NO.	TITLE	PAGE
-	2	TYPICAL CROSS-SECTION OF IMPROVEMENT	{ Grading, Drainage, Base, Guard Rail and Double Tack Coat of Refined Tar, Item 29.
-	3	BANKING AND WIDENING TABLES	
-	4-12	PLAN AND PROFILE	
"	13	Standard Structure Sheet	S-28 Pipe Culverts
"	14	"	S-C 2-4 Box Culverts
"	15	"	SC 2-3
"	16	"	SCW 4'
"	17	"	SCW 4x5
"	18	"	SC 1
"	19	"	S-30 Guard Rail
"	20	"	S-40 Barricodes, Signs & Lights
"	21	"	S-41 Typical Grading Cross Sections
"	22-B4 Cross Section Sheets		

STATE OF VERMONT
STATE HIGHWAY DEPARTMENT
**PLAN AND PROFILE OF PROPOSED
STATE HIGHWAY**
STATE AID PROJECT

TOWN OF CALAIS Pin # 00R 758
ROUTE 14

MONTPELIER-HARDWICK ROAD

Project No. **ST 144P**

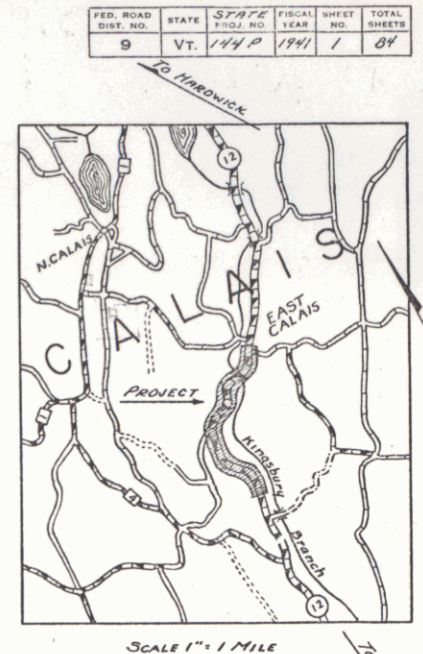

Standard Sheets Approved by
the Chief Engineer.

S-28 April 26, 1941.
S-40 Sept. 5, 1940.

BEGINNING AT A POINT 2.81± MILES NORTHERLY OF THE E. MONTPELIER TOWN LINE ON ROUTE 12, AND EXTENDING 1.760 MILES NORTHERLY TO THE VILLAGE OF EAST CALAIS.

LENGTH OF PROJECT 9294.7 FT. = 1.760 MILES.

RECORD PLANS
By - W. H. Chase

RIGHT-OF-WAY DIVISION
TOWN FILE

PERPETUAL

Town of VT 14

(To Be Returned To R.O.W. Division)

APPROVED: May 26, 1941

W. H. Chase
COMMISSIONER OF HIGHWAYS

SUBMITTED BY ORDER OF THE STATE HIGHWAY BOARD

COUNTY LINE	-----
TOWN LINE	-----
FENCE LINE	-----
STONE WALL	-----
UNFENCED PROPERTY	-----
GUARD RAIL	-----
TRAVELED WAY	-----
RAILROAD	-----
RETAINING WALL	-----
CENTER LINE	-----
SURVEY LINE	-----
CULVERT	-----
DROP INLET	-----
TROLLEY POLE	-----
POWER POLE	-----
TELEPHONE POLE	-----
TREES	-----
HEDGE	-----

RECORD PLANS
CALAIS ST. 144-P
1941

GROUND ELEVATION	DATUM	LINE
GRADE ELEVATION	DATUM	LINE
CURVE DATA		
DEFLECTION ANGLE	Δ	
DEGREE OF CURVE	D	
RADIUS OF CURVE	R	
TANGENT DISTANCE	T	
LENGTH OF CURVE	L	
EXTERNAL DISTANCE	E	
POINT OF INTERSECTION	P. I.	
POINT OF CURVE	P. C.	
POINT OF TANGENT	P. T.	
POINT ON TANGENT	P. O. T.	

TITLE	Sheet 4
TYPICAL	1" = 500'
PLAN	1" = 100'
PROFILE HORIZONTAL	1" = 50'
PROFILE VERTICAL	1" = 10'
CROSS SECTIONS	1" = 5'

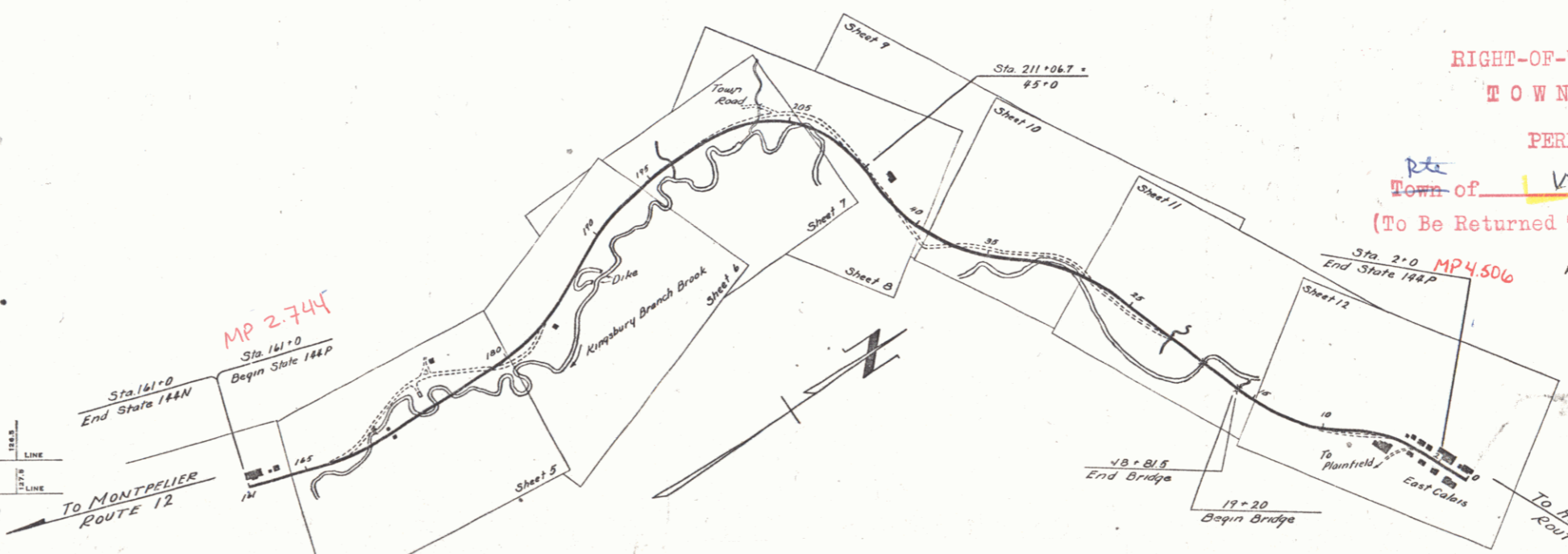

THESE PLANS ARE SUBJECT TO SUCH REVISIONS AS MAY BE REQUIRED BY THE PUBLIC ROADS ADMINISTRATION OR THE COMMISSIONER OF HIGHWAYS.
CONSTRUCTION IS TO BE CARRIED ON IN ACCORDANCE WITH THE PLANS AND THE STANDARD ROAD AND BRIDGE SPECIFICATIONS OF 1936, AS APPROVED DECEMBER 29TH, 1936 BY THE PUBLIC ROADS ADMINISTRATION, INCLUDING ALL SUBSEQUENT APPROVED REVISIONS AND SUCH REVISED SPECIFICATIONS AND SPECIAL PROVISIONS AS ARE SUBMITTED WITH THE PLANS.

RECOMMENDED FOR APPROVAL
DISTRICT ENGINEER
PUBLIC ROADS ADMINISTRATION
FEDERAL WORKS AGENCY

APPROVED
COMMISSIONER OF HIGHWAYS

APPROVED May 26, 1941 ROAD ENGINEER
APPROVED May 26, 1941 DISTRICT HIGHWAY COMMISSIONER
SERIES ST No. 144P FILED
SHEET (1) OF 84