

- INDEX OF SHEETS
- 1) Title Sheet & Typical Detail Sheet
 - 2) Earthwork, Drainage, & Quantity Sheet
 - 3) Layout & Profile Sheet
 - 4) Flute Pipe Arch Layout & Elevation Sheet
 - 5-9) Blank
 - 10) B-1 Banking Tables 12/13/71
 - 11) B-5 Typical Slope Rounding 12/16/71
 - 12) D-6 RCDI with Grate 4/14/73
 - 13) D-15 Cast Iron Grate w/ Frame, Type B 11/14/72 R
 - 14) E-2 Road Construction Approach Signs 5/14/74 R
 - 15) E-4 Road Construction Signs - Paving 5/14/74 R
 - 16) E-5 On Project Construction Signs 5/14/74 R
 - 17) E-7 Delineation and Barricades 9/19/73 R
 - 18) E-8 Typical Major Maintenance Operation Approach Signs 5/14/74 R
 - 19) E-10A Flagman's Paddle 12/12/73 R
 - 20) G-4 Guard Rail, Standard Steel Beam w/ Wood Posts, Type II 6/14/74 R
 - 21) G-1d Guard Rail, Standard Steel Beam w/ Wood Posts, Type II 9/10/76 R
 - 22) Blank
 - 23-30) Mainline Cross Sections
 - 31-36) Channel Sections

STATE OF VERMONT
DEPARTMENT OF HIGHWAYS



PROPOSED IMPROVEMENT
BRIDGE PROJECT

TOWN OF BARRE Pin# 00R754
COUNTY OF WASHINGTON

ROUTE NO: VT. 14 BRIDGE NO: 67

PROJECT LOCATION: Beginning at a point approximately 0.380 mi. northerly of the Barre City - Barre Town line & extending northeasterly 0.066 mi.

PROJECT DESCRIPTION: Replace Bridge w/ pipe structure & Appr Rail w/ Std. Beam Rail

| | | |
|-----------------------|-------------|-------------|
| LENGTH OF ROADWAY | 327.26 FEET | 0.062 MILES |
| LENGTH OF BRIDGE | 22.74 FEET | 0.004 MILES |
| LENGTH OF PROJECT | 350.00 FEET | 0.066 MILES |
| LENGTH OF ROW PROJECT | 560 FEET | 0.106 MILES |

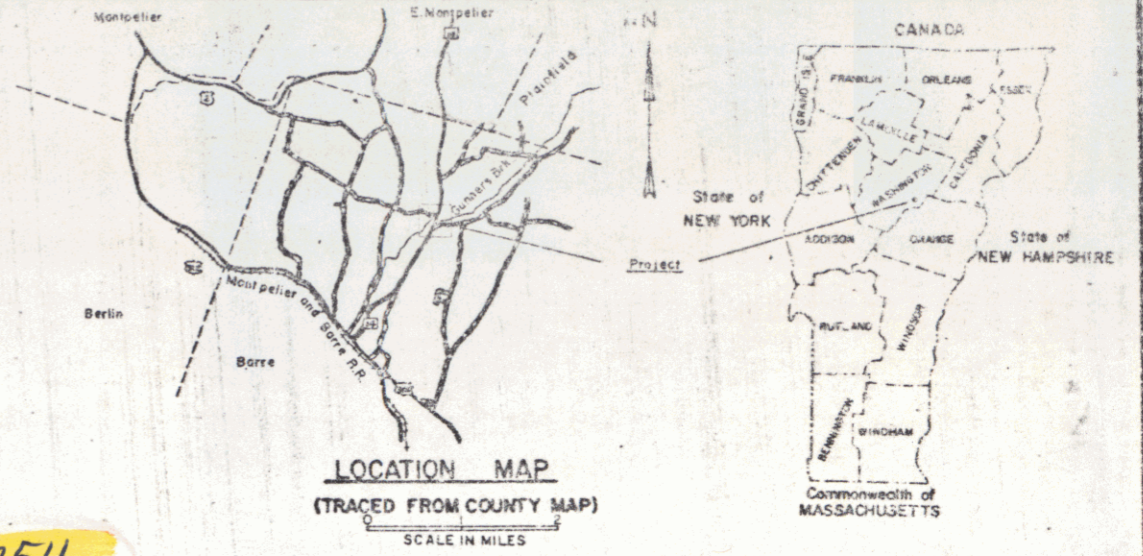

TRAFFIC DATA

| | |
|----------|------------|
| 1975 ADT | 2690 |
| 1975 DMV | 363 |
| D | 54% |
| T | 6% |
| V | 40 MPH |
| 1955 ADT | 4200 (EST) |
| 1955 DMV | 570 (EST) |
| D | 53% |
| T | 6% |

ROW PLANS

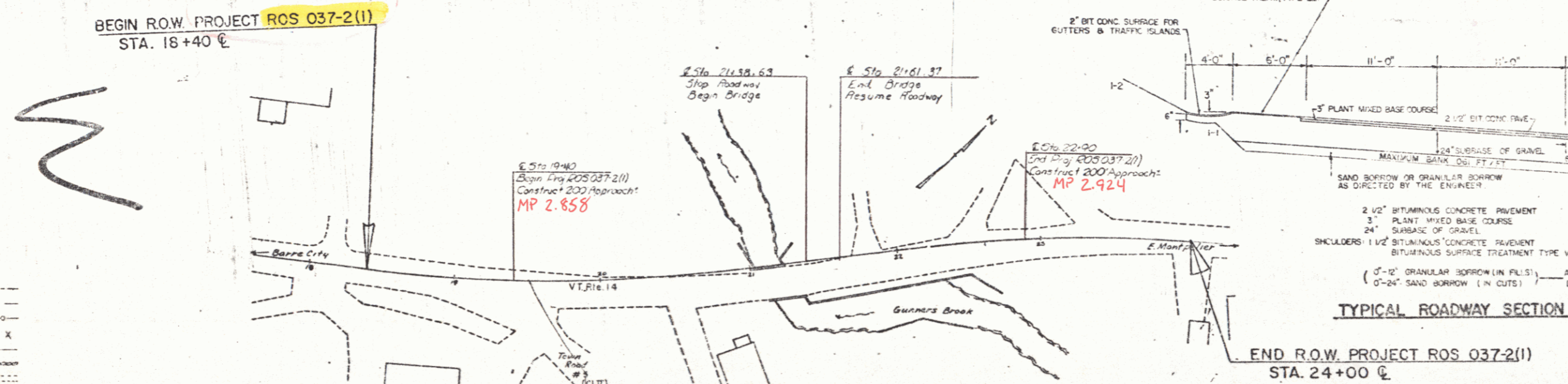

- CONVENTIONAL SIGNS
- COUNTY LINE
 - TOWN LINE
 - LIMITS OF ACCESS
 - POINT OF ACCESS
 - FENCE LINE
 - STONE WALL
 - TRAVELED WAY
 - RAILROAD
 - SURVEY LINE
 - CULVERT
 - POWER POLE
 - TELEPHONE POLE
 - TREES
 - F & CONST IDENTIFICATION SIGNS
 - PROPERTY LINE
 - ROW TAKING LINE
 - SLOPE RIGHTS
 - TOP OF CUT
 - TOE OF SLOPE

SEEDING FORMULA

| ITEM | 65110 | URBAN AREA | | |
|--------|--------|---------------------|----|----|
| % WT. | LBS/A. | | | |
| 38.46 | 25 | CREeping RED FESCUE | 98 | 85 |
| 48.15 | 30 | KENTUCKY BLUE GRASS | 85 | 75 |
| 15.39 | 10 | ANNUAL RYE GRASS | 95 | 90 |
| 100.00 | 65 | | | |

THE SEED MIXTURE SHALL NOT HAVE A WEED CONTENT EXCEEDING 0.40% BY WEIGHT AND SHALL BE FREE FROM ALL NOXIOUS WEED SEED.

HAY MULCH, ITEM 65125, TO BE PLACED ON ALL EARTH SLOPES AT THE RATE OF 2 TONS PER ACRE

FERTILIZER, ITEM 65115, SHALL BE DELIVERED IN BAGS NOT TO EXCEED 100 LBS EACH AND IS TO BE APPLIED AT THE RATE OF 500 LBS PER ACRE

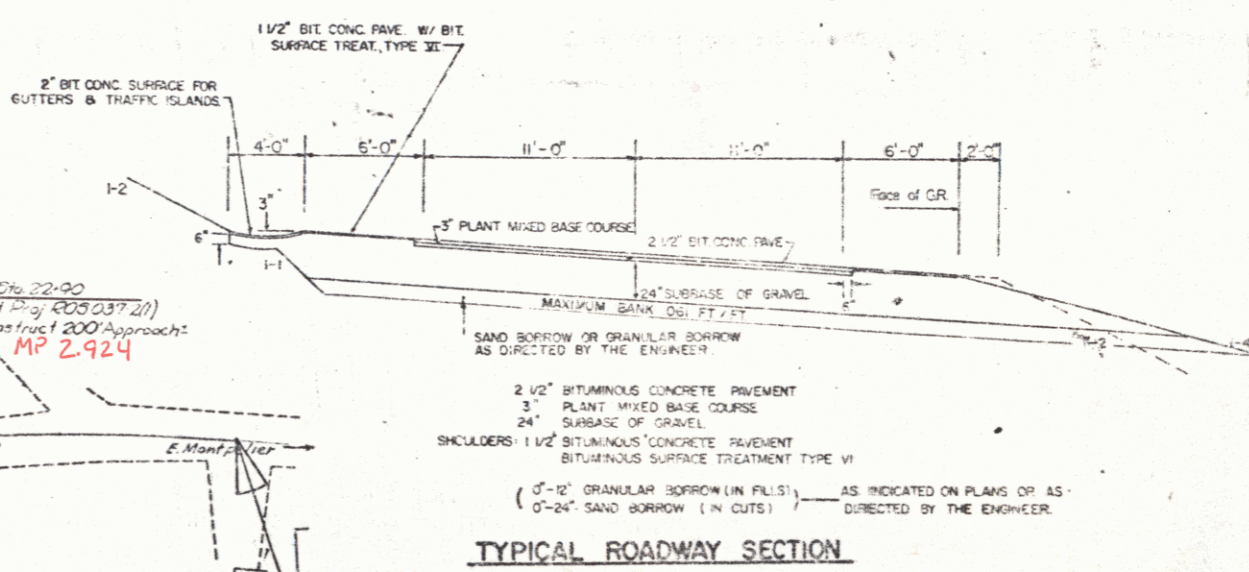

RIGHT-OF-WAY DIVISION
TOWN FILE
PERPETUAL
Town of Barre
(To Be Returned To P.O.W. Division)

These plans are subject to such engineering changes as may be required by the Federal Highway Administration or the Chief Engineer. Construction is to be carried on in accordance with these plans and the Standard Specifications for Highway and Bridge Construction dated March, 1976, as approved by the Federal Highway Administration on a project to project basis including all subsequent revisions and such required modification and special provisions as are incorporated in these plans.

APR 08 1986

SUBMITTED BY ORDER OF THE STATE HIGHWAY BOARD

APPROVED: *R.O. Munn* DATE 2-26-76
CHIEF ENGINEER

APPROVED: *[Signature]* DATE 2-16-76
ROW DIRECTOR

PROJECT ROS NO 037-2(1)

SHEET 1 OF 5 SHEETS