

PLUM
 DRAWN BY: NADOLSKI 8/24
 DATE: 8/24
 CHECKED BY: D. W. CASCHL 8/24
 TRACED

PROFILE
 DRAWN BY: NADOLSKI 8/24
 DATE: 8/24
 CHECKED BY: D. W. CASCHL 8/24
 TRACED

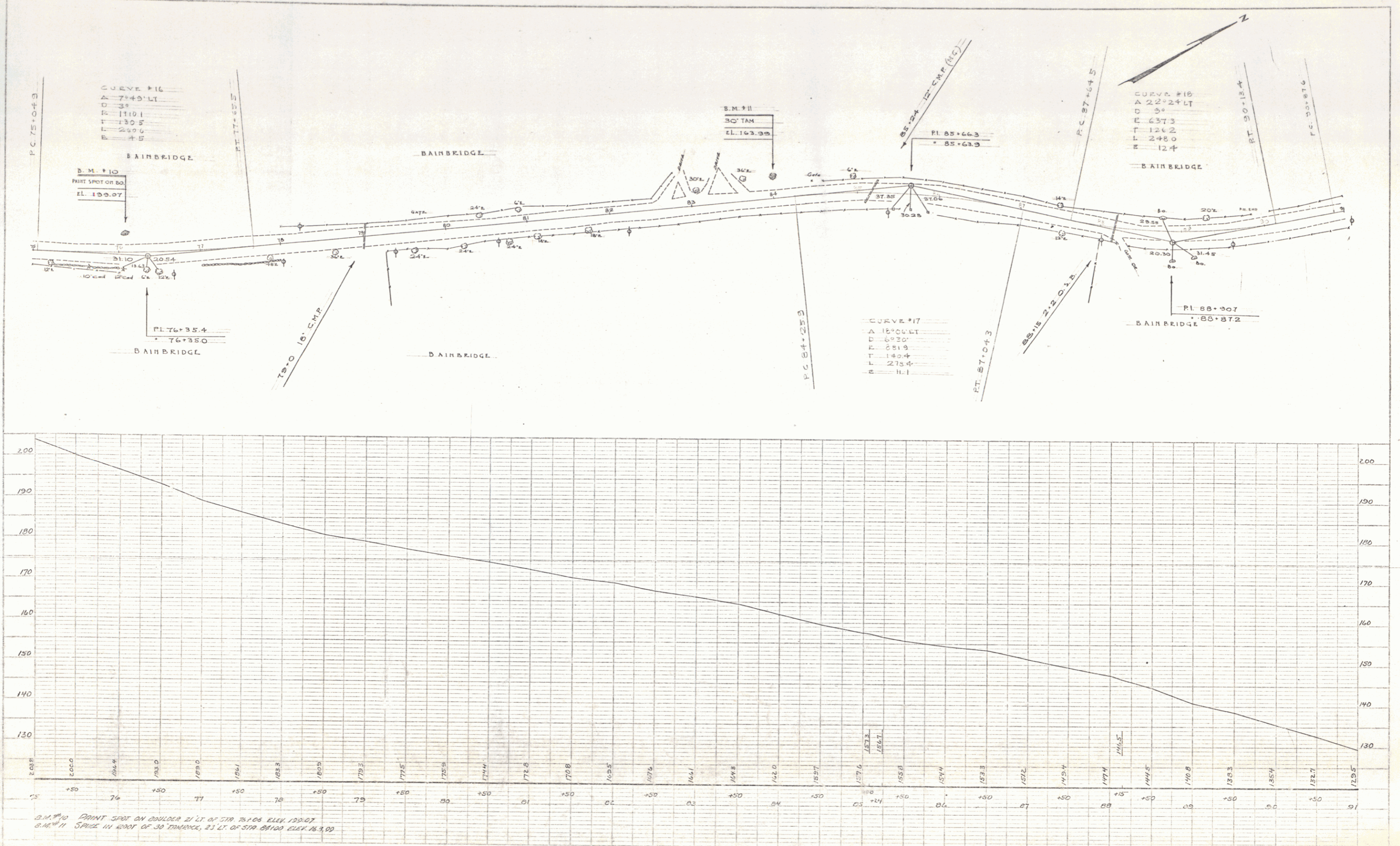

B.M. #10 POINT SPOT ON SHOULDER 21' LT OF STA 76+35.4 ELEV. 199.07
 B.M. #11 SPRUCE IN ROOT OF 30' TRUNK, 23' LT. OF STA 81+00 ELEV. 163.98

PLATE 1 - PLAN PROFILE OF P.A. & R.E. TANGERS
 1910 & 1911, NEW YORK

SHEET 9

11