

Parcel	Kind of Data or Instrument	Date of Instrument	Owner	Corner	Corner Elevation	Remarks
A, B, C	O.C.D.	3-9-36	Hammann & Tenny Co	Capitol Square	20 237.5	3-11-36
A'	O.C.D.	6-16-36	Oldfield White	#12	20 237.5	6-22-36
A''	O.C.D.	3-11-36	M. M. M. Iyer	"	20 237	3-17-36

Note: Grade Revised Sta 32+00 to 35+50 May 7, 1936

Note: Grade Revised from 43+00 to 47+00 May 7, 1936

Note: Grade shown on plan for existing Sta. was used on the next even station. i.e. grade at 39+50 used at 40+00 etc. This change was made between 40+00 & 41+00

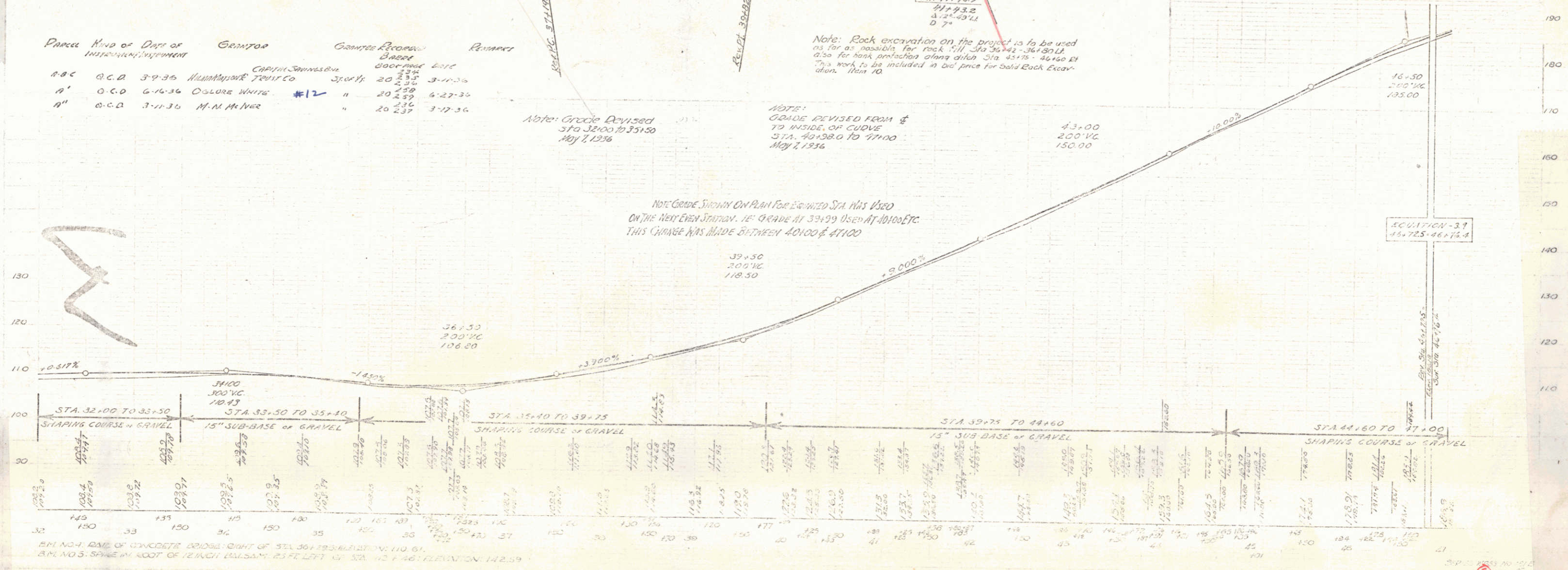

BM NO. 1: DATE OF CONCRETE BRIDGE: RIGHT OF STA 30+70 ELEVATION: 110.61  
 BM NO. 5: SAME IN FOOT OF 12 INCH BALSAM: 25 FEET LEFT OF STA. NO. 1: ELEVATION: 142.59