

NEW CULVERTS REQUIRED

STA 247+65- 15" REINFCONCRETE PIPE- 35' LONG  
 CONC CLASS B (1-B-3)- 1.9 CU YDS  
 REINF. 3#4 @ 4' - 33 lbs

STA 250+52- 24" CONCRETE BOX CULVERT  
 CONC CLASS A (1-B-4)- 10.1 CU YDS  
 REINF. 3#4 @ 4' - 656 lbs

STA 255+69- 24" CONCRETE BOX CULVERT  
 CONC CLASS A (1-B-4)- 12.5 CU YDS  
 REINF. 3#4 @ 4' - 817 lbs

110 ROAD STATE FEEL AND DESIGN  
 DIST. NO. 141 P. 101 1/2  
 7/1 200 1927 19 87

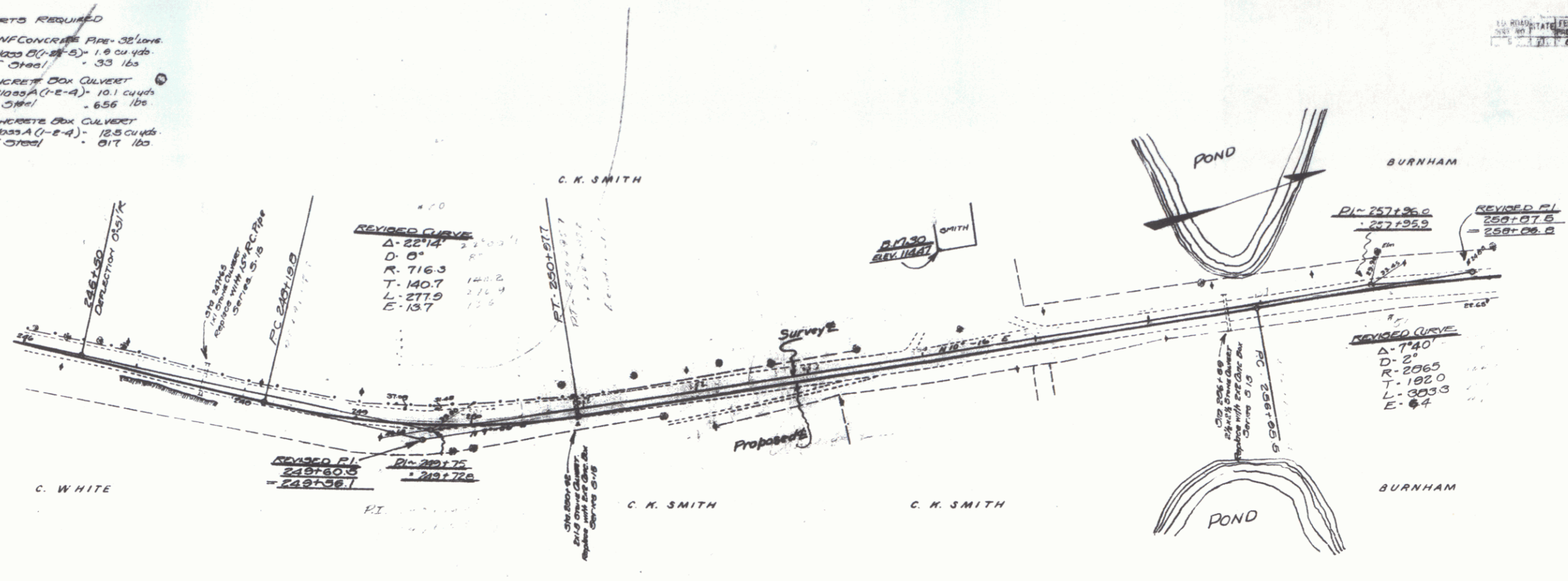

M. L. HARRIS 5/27/20

