

WOOD GUARD RAIL REQUIRED
LEFT
STA 194+40 TO STA 194+64 - LENGTH 24 FT
RIGHT
STA 194+40 TO STA 194+64 - LENGTH 24 FT
TOTAL FOR CHIST - 48 FT

CABLE GUARD RAIL REQUIRED
LEFT
STA 190+00 TO STA 192+56 - LENGTH 256 FT

NEW CULVERTS REQUIRED
STA 194+52 - 3x3 CONCRETE BOX CULVERT,
Concrete Class A (A-24) - 17.0 cu yds
Reinforcing Steel 1100 lbs.

STONE FILL ON LEFT STA. 189+00 TO 191+50 330 cu yds.

Note -
Stone Fill to be constructed with approved stone
of not less than 2 cu ft each, with smaller stone
used to fill voids, and make a fill of maximum stability.

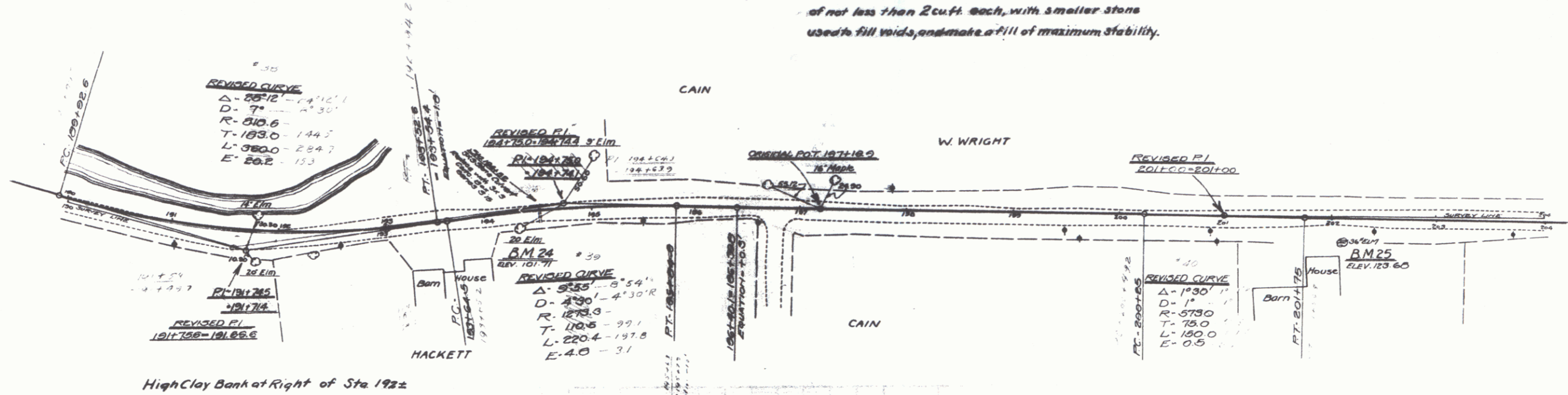

High Clay Bank at Right of Sta 1922

USE ORIGINAL GRADE ELEVATIONS

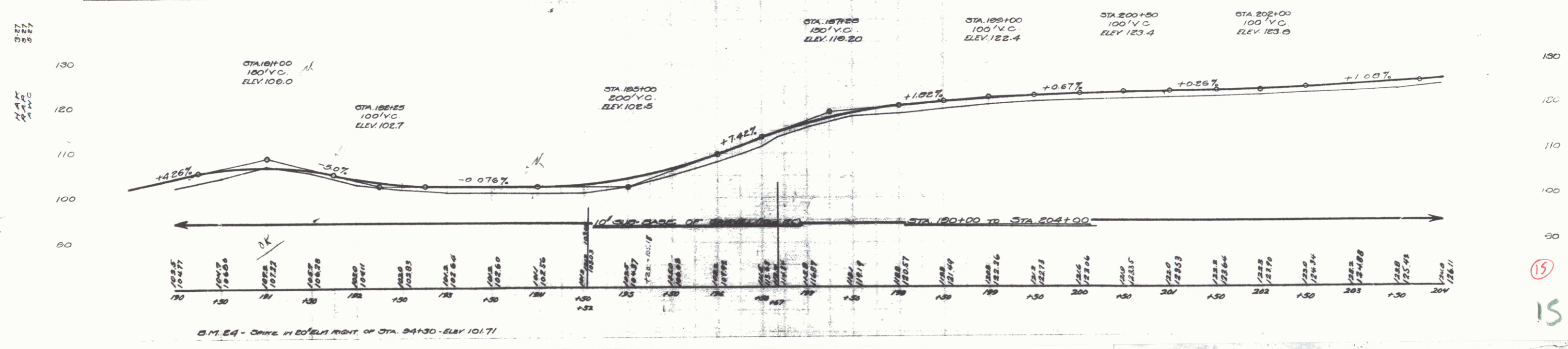

15