

FED. DIST.	STATE	PROJECT NO.	SHEET NO.
9	VT	008 1021	12

WOOD GUARD RAIL REQUIRED
 LEFT
 STA 160+20 TO STA 160+92 - LENGTH 72 FT
 RIGHT
 STA 150+38 TO STA 150+62 - LENGTH 24 FT
 STA 152+50 " " 152+74 " " 24 FT
 STA 153+30 " " 153+52 " " 22 FT
 TOTAL FOR SHEET - 144 FT

CABLE GUARD RAIL REQUIRED
 LEFT
 STA 152+20 TO STA 164+00 - LENGTH 118 FT
 STA 150+100 " " 150+140 " " 40 FT
 TOTAL FOR SHEET - 220 FT

NEW CULVERTS REQUIRED
 STA 151+70 - 15" REINFORCED CONCRETE PIPE 36' LONG
 Concrete Class B (1-2-5) - 1.8 cu yds.
 Reinforcing Steel - 33 lbs.
 STA 152+50 - 15" REINFORCED CONCRETE PIPE - 36' LONG
 Concrete Class B (1-2-5) - 2.3 cu yds.
 Reinforcing Steel - 33 lbs.
 STA 155+80 - 15" REINFORCED CONCRETE PIPE 30' LONG
 Concrete Class B (1-2-5) - 1.9 cu yds.
 Reinforcing Steel - 33 lbs.
 STA 152+62 - 3x3 CONCRETE BOX CULVERT
 Concrete Class A (1-2-4) - 22.2 cu yds.
 Reinforcing Steel - 1464 lbs.
 STA 153+50 - 15" REINFORCED CONCRETE PIPE 36' LONG
 Concrete Class B (1-2-5) - 1.9 cu yds.
 Reinforcing Steel - 33 lbs.

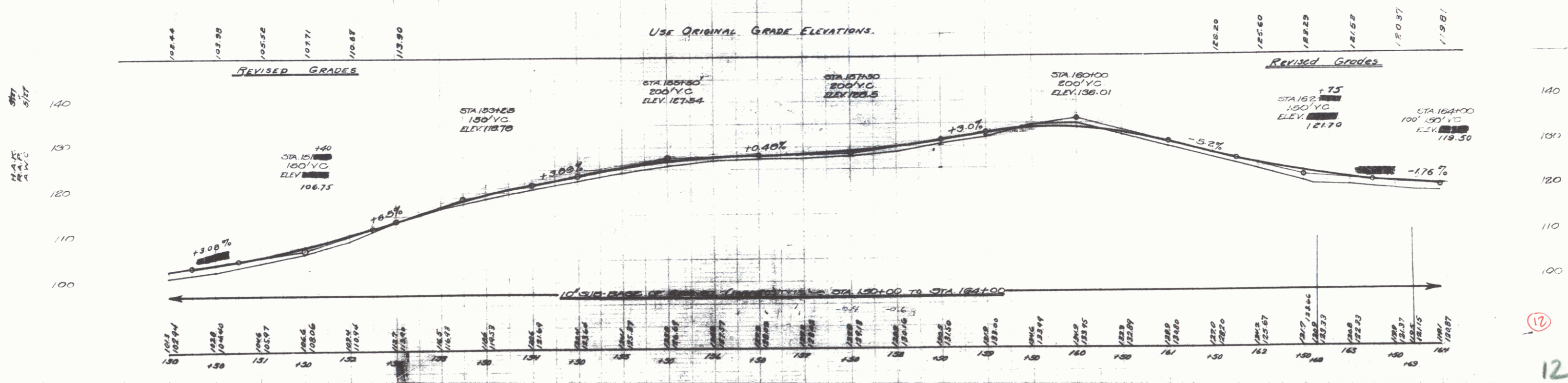
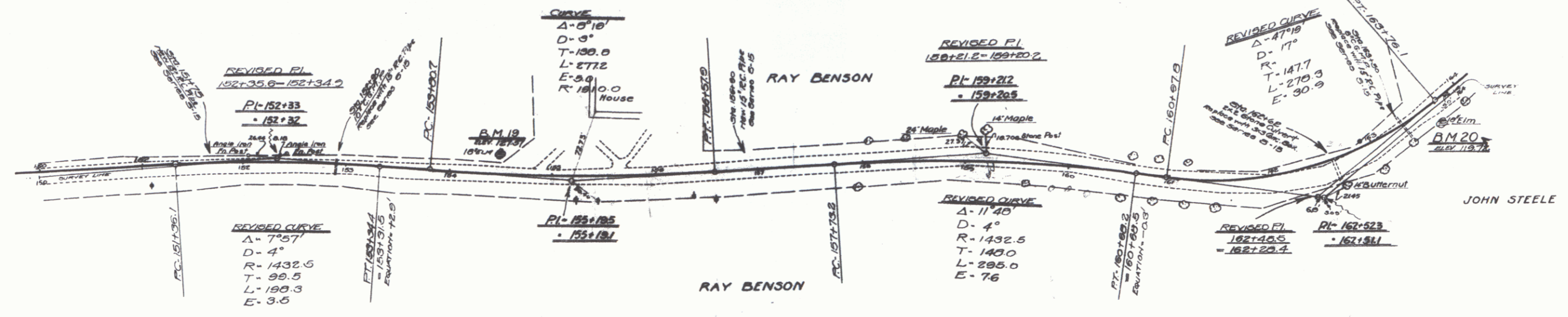

12