

GUANO PAIL REQUIRED

LEFT		
Sta. 111+23 To Sta. 111+47	24 ft.	
113+32	16 "	
114+56	14 "	
RIGHT		
Sta. 111+23 To Sta. 111+47	24 ft.	
112+52	36 "	
115+25	176 "	
TOTAL	480 ft.	

NEW CULVERTS REQUIRED
 Sta. 111+35 14" Cor. Iron Pipe 35 ft.
 1-2 3 Concrete 1.8 cu yd.

SUB-BASE REQUIRED
 Sta. 107+00 to Sta. 113+23 12" Base

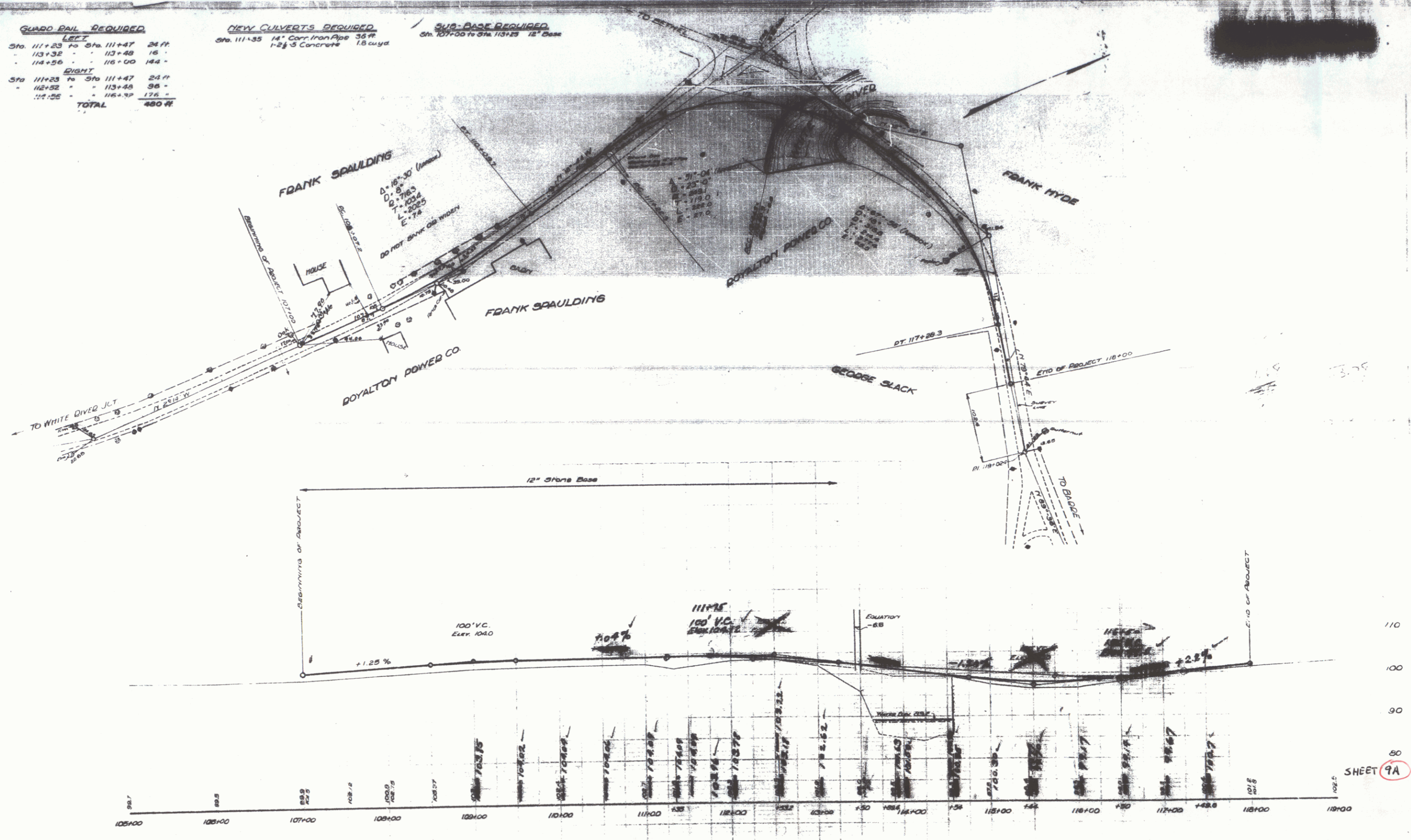

SHEET 9A

9