

INDEX OF SHEETS

SHEET NO.	TITLE	PAGE
1	TYPICAL CROSS-SECTION OF IMPROVEMENT	1
2	BANKING AND WIDENING TABLES	2
3	PLAN AND PROFILE	3
4	DETAILS OF BOX CULVERT	4
5	STANDARD STRUCTURE SHEET	5
6	PIPE CULVERTS	6
7	GUARD RAIL	7
8	STANDARD UNDERDRAIN	8
9	ONE COURSE CEMENT CONCRETE SIDEWALK	9
10	BARRICADES SIGNS & LIGHTS	10
11	ROUNDING OF SLOPES	11
12	CROSS SECTIONS	12

Standard Structure Sheets  
 Approved by the Chief Engineer  
 5-28 July 11, 1933  
 5-30 August 15, 1934  
 5-31 July 25, 1934

STATE OF VERMONT  
 STATE HIGHWAY DEPARTMENT

PLAN AND PROFILE OF PROPOSED  
 STATE HIGHWAY

FEDERAL AID PROJECT

TOWN OF SHARON Pin# 00R737

WHITE RIVER JCT. — ROYALTON ROAD

BEGINNING AT A POINT 664 FT. EAST OF THE INTERSECTION WITH THE TOWN ROAD TO POMFRET,  
 ACROSS THE WHITE RIVER, IN SHARON VILLAGE AND EXTENDING WESTERLY ON ROUTE 14 0.681 MILES.

LENGTH OF PROJECT 3600 FT. = 0.681 MILES

FED. ROAD DIST. NO.	STATE	FED. AID PROJ. NO.	FISCAL YEAR	SHEET NO.	TOTAL SHEETS
9	VT.	9480	1941	1	47

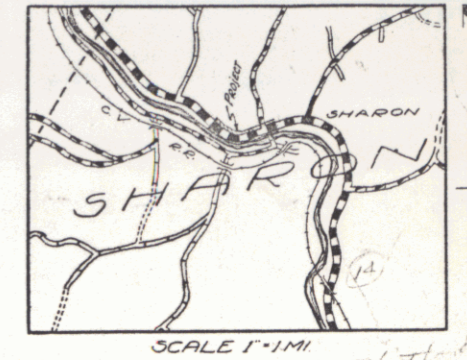

RECORD PLANS  
 A.C.B.

RIGHT-OF-WAY DIVISION  
 TOWN FILE:  
 PERPETUAL  
 Town of SHARON  
 (To Be Returned To R.O.W. Division)

APPROVED: Aug 30, 1934  
[Signature]  
 COMMISSIONER OF HIGHWAYS  
 SUBMITTED BY ORDER OF THE STATE HIGHWAY BOARD

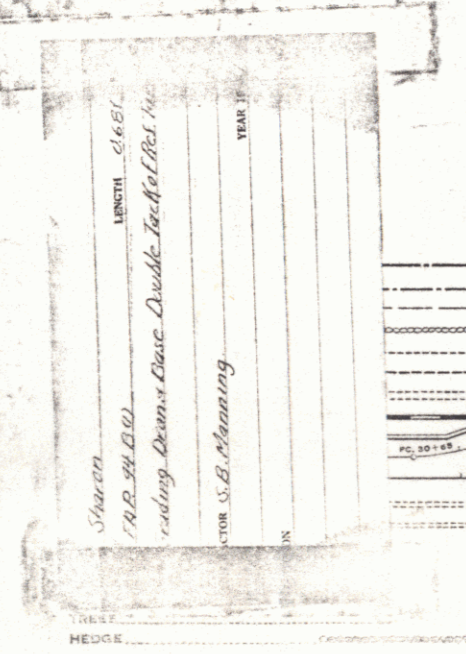
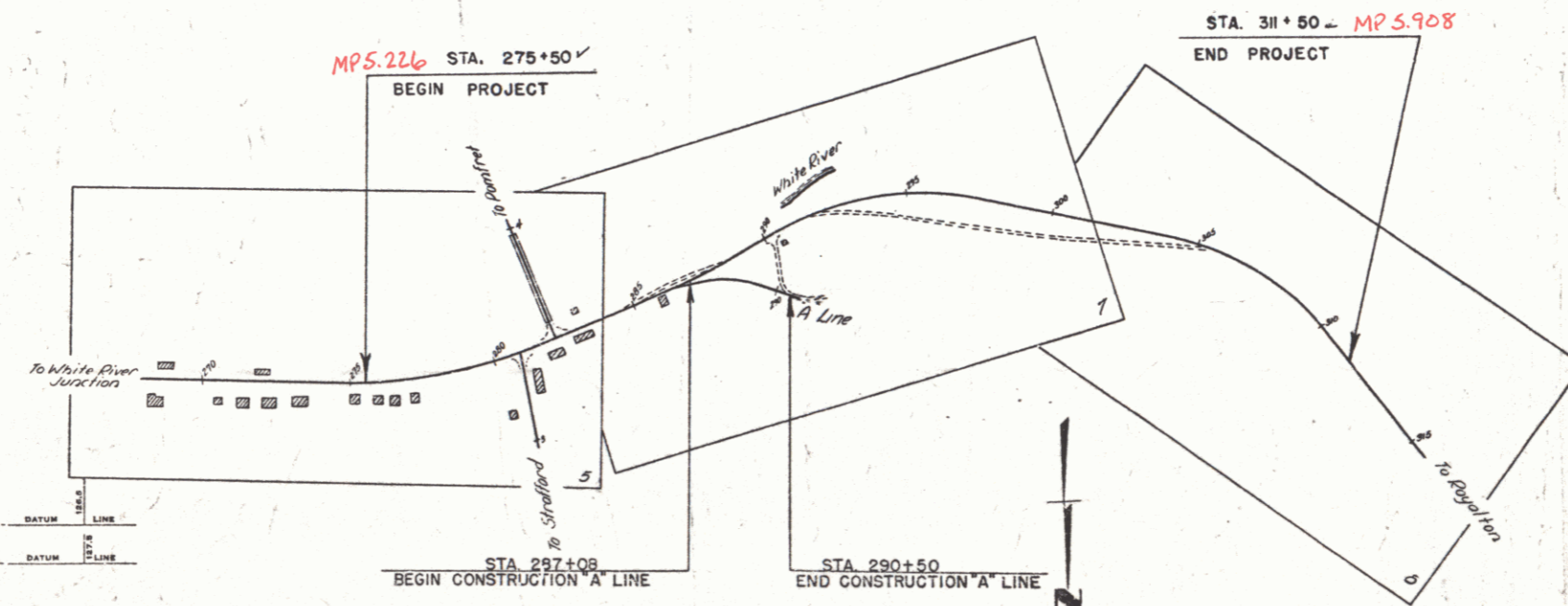

RECORD PLANS  
 SHARON - FILE 9480  
 Contractor - S.B. Manning  
 1934

GROUND ELEVATION	DATUM	LINE
.....	.....	.....
GRADE ELEVATION	.....	.....
.....	.....	.....

CURVE DATA

DEFLECTION ANGLE	.....	Δ
DEGREE OF CURVE	.....	D
RADIUS OF CURVE	.....	R
TANGENT DISTANCE	.....	T
LENGTH OF CURVE	.....	L
EXTERNAL DISTANCE	.....	E
POINT OF INTERSECTION	.....	P. I.
POINT OF CURVE	.....	P. C.
POINT OF TANGENT	.....	P. T.
POINT ON TANGENT	.....	P. O. T.

MM 0520-0589

THESE PLANS ARE SUBJECT TO SUCH REVISIONS AS MAY BE REQUIRED BY THE PUBLIC ROADS ADMINISTRATION OR THE COMMISSIONER OF HIGHWAYS.  
 CONSTRUCTION IS TO BE CARRIED ON IN ACCORDANCE WITH THE PLANS AND THE STANDARD ROAD AND BRIDGE SPECIFICATIONS OF 1934, AS APPROVED DECEMBER 29TH, 1934 BY THE PUBLIC ROADS ADMINISTRATION, INCLUDING ALL SUBSEQUENT APPROVED REVISIONS AND SUCH REVISED SPECIFICATIONS AND SPECIAL PROVISIONS AS ARE SUBMITTED WITH THE PLANS.

APPROVED <u>Aug 12, 1934</u> <u>[Signature]</u> ROAD ENGINEER	APPROVED <u>[Signature]</u> DISTRICT HIGHWAY COMMISSIONER	SERIES <u>FAP No. 3480</u> LEG. SHEET <u>1</u> OF <u>47</u>
---	--	--

DIST. # 4 PLANS