

**NEW CULVERTS REQUIRED**

STA 13+50 - 48" Rein. Conc. Pipe - 12.0 with 33 REINFORCING STEEL  
 This culvert laid by State forces. Headwalls to be constructed.

STA 22+50 - 18" Reinforced Concrete Pipe - CONCRETE CLASS B (1-21-2) - 2.7 cu yds REINFORCING STEEL - 33 lbs.  
 THIS CULVERT LAID BY STATE FORCES.

**CABLE GUARD RAIL REQUIRED**

STA 13+00 to STA 14+40 - Long 140 ft.  
 STA 21+24 to STA 23+40 - 216

STA 13+00 to STA 14+24 - Long 124 ft.  
 STA 21+40 to STA 23+40 - 200 ft.  
 600 ft.

**COBBLE GUTTER NOTE**

STA 14+25 (approx) and STA 23+25 (approx) - Right and Left. Cobble Gutter to be constructed on slope where fill meets original ground if necessary to prevent erosion.

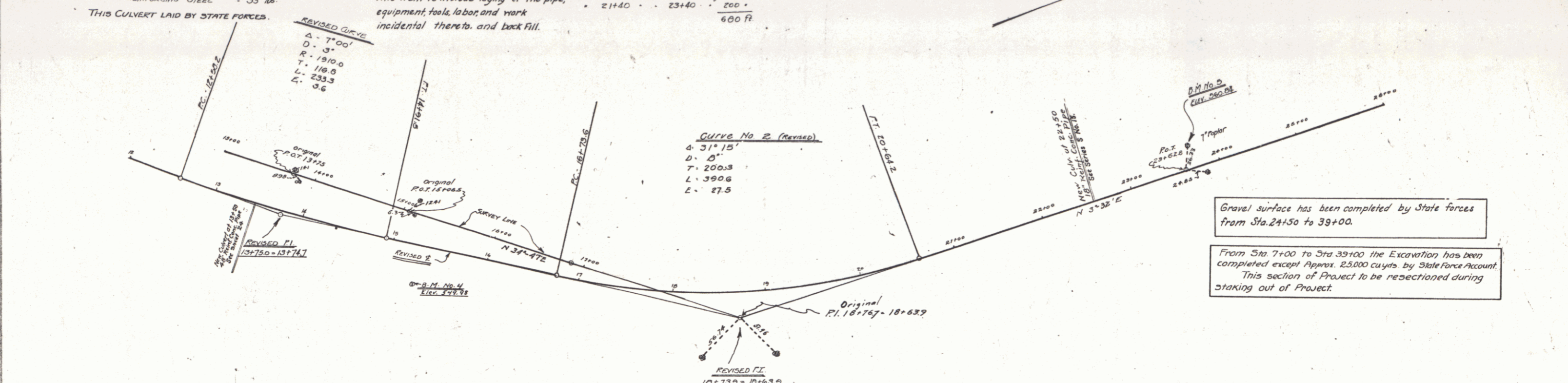

Gravel surface has been completed by State forces from Sta. 24+50 to 39+00.

From Sta 7+00 to Sta 39+00 the Excavation has been completed except Approx. 25,000 cu yds by State Force Account. This section of Project to be resectioned during staking out of Project.

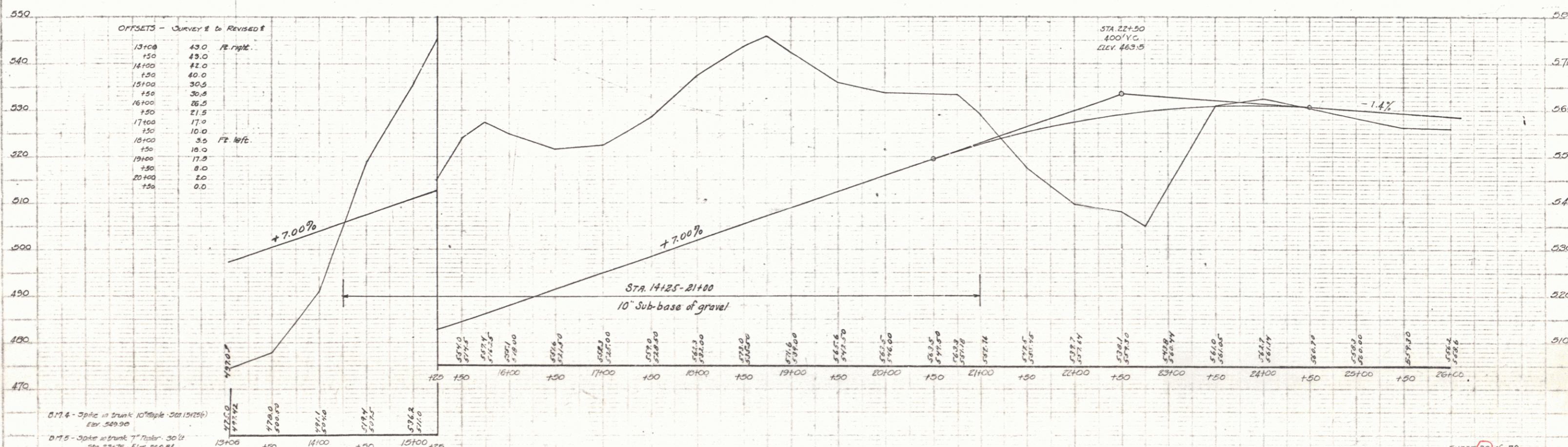

D174 - 3" dia. x 3' long 10" dia. x 500 (1975)  
 Elev. 549.90

D175 - 3" dia. x 3' long 10" dia. x 500 (1975)  
 Elev. 549.90

19