

INDEX OF SHEETS

SHEET NO. 1	TITLE PAGE
2	TYPICAL CROSS-SECTION OF IMPROVEMENT— <i>2 1/2 Gravel Mixed-in-Place Surface Course</i>
3	BANKING AND WIDENING TABLES <i>with Refined Tar Item 24-B+H</i>
4-54	PLAN AND PROFILE SHEETS
5	STANDARD STRUCTURE SHEET
10	PIPE CULVERTS
10A	C. R. M. WALL & GUARD RAIL
11	BOUNDARY MARKERS
12	CONCRETE ORSBING
13	BARRICADES, SIGNS & LIGHTS
14-37	CROSS SECTIONS
	SC1 BOX CULVERTS

STANDARD STRUCTURE SHEETS APPROVED
BY THE CHIEF ENGINEER
SHEET 328 JULY 11, 1933
SHEET 330 AUG. 15, 1933

(To Be Returned to R.O.W. Division)
[Handwritten initials]
PERMIT
RIGHT-OF-WAY DIVISION

STATE OF VERMONT
STATE HIGHWAY DEPARTMENT

PLAN AND PROFILE OF PROPOSED
STATE HIGHWAY
FEDERAL AID PROJECT

TOWN OF HARTFORD Pin# 00R732

SHARON-WHITE RIVER JUNCTION ROAD R-6-VT 14

BEGINNING AT A POINT APPROXIMATELY ONE-HALF MILES SOUTH OF WEST HARTFORD VILLAGE AND EXTENDING SOUTHEASTERLY 0.798 MILES

LENGTH OF PROJECT: 4,218.4 FT. = 0.798 MILES

FED. ROAD DIST. NO.	STATE	FED. AID PROJ. NO.	FISCAL YEAR	SHEET NO.	TOTAL SHEETS
9	VT.	31-B	1933	1	37

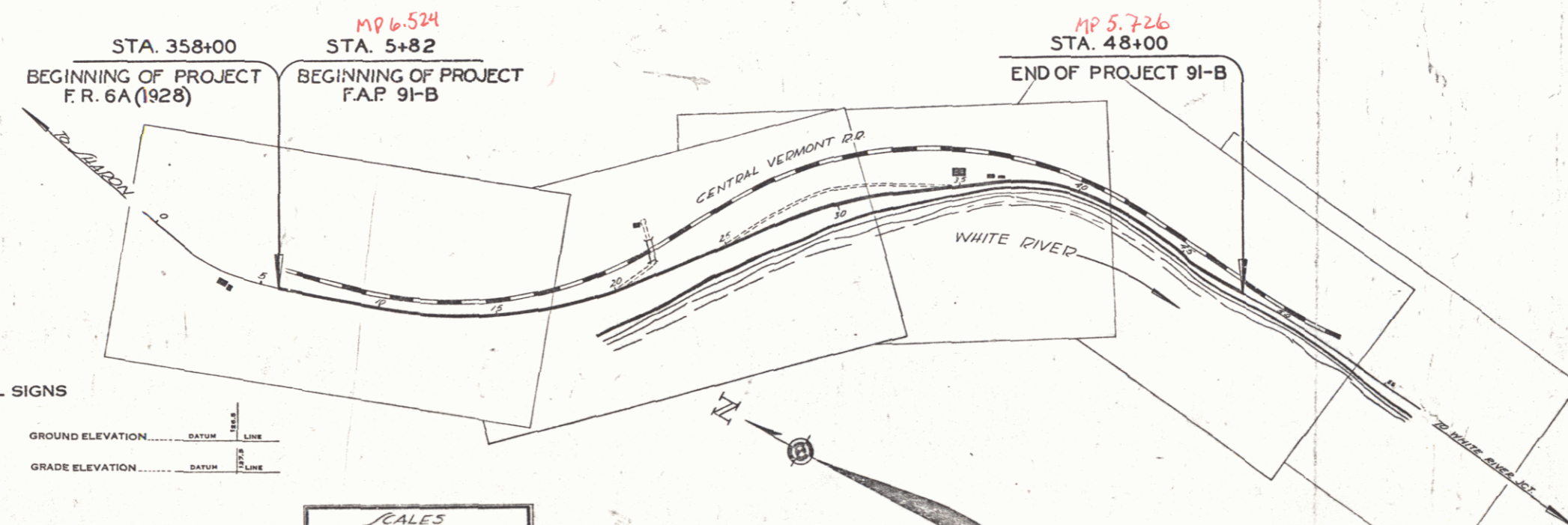
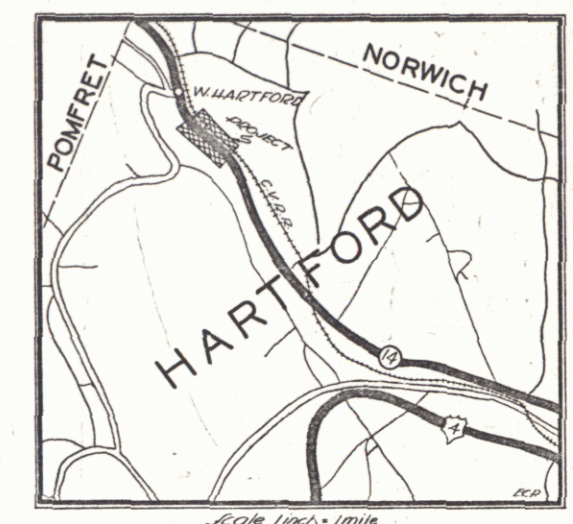

APPROVED: June 15, 1936
H. E. Sargent
COMMISSIONER OF HIGHWAYS
SUBMITTED BY ORDER OF THE STATE HIGHWAY BOARD

CONVENTIONAL SIGNS

COUNTY LINE	GROUND ELEVATION
TOWN LINE	GRADE ELEVATION
FENCE LINE	
STONE WALL	
UNFENCED PROPERTY	
GUARD RAIL	
TRAVELED WAY	
RAILROAD	
RETAINING WALL	
CENTER LINE	
SURVEY LINE	
CULVERT	
DROP INLET	
TROLLEY POLE	
POWER POLE	
TELEPHONE POLE	
TREES	
HEDGE	

SCALES

TITLE	1" = 300'
TYPICAL	1" = 2'
PLAN	1" = 50'
PROFILE	1" = 20'
CROSS SECTIONS	1" = 5'

These plans are subject to such revisions as may be required by the Bureau of Public Roads or the Comm. of Highways. Construction is to be carried on in accordance with the plans and Standard Road & Bridge Specifications of 1930, including all subsequent approved revisions and such revised specifications and special provisions as are submitted with the plans. Attention of the contractor is called to the fact that the State Highway Board reserves the right to extend this project of the same contract prices. Said cost of extension not to exceed 25% of the amount of the contract.

RECOMMENDED [Signature]
DISTRICT ENGINEER BUREAU OF PUBLIC ROADS
RECOMMENDED FOR APPROVAL [Signature]
CHIEF ENGINEER BUREAU OF PUBLIC ROADS
APPROVED [Signature]
DIRECTOR - BUREAU OF PUBLIC ROADS

CORRECT: June 1936
SERIES F.A.P. No. 31-B FILED
SHEET 1 OF 37

DIST. # 4 PLANS