

INDEX OF SHEETS

SHEET NO. 1	TITLE PAGE
2	TYPICAL CROSS-SECTION OF IMPROVEMENT (GRADING BASE DRAINAGE WITH GUARD RAIL AND DOUBLE TACK COAT OF REFINED TAR (ITEM 29))
3	BANKING AND WIDENING TABLES
4-8	PLAN AND PROFILE STA. 249+50 - 307+54.8
9	DETAIL SHEET 10' X 10' REINF. CONC. BOX CULVERT STA. 277+94
10	STANDARD SHEET S-28 PIPE CULVERTS
11	STANDARD SHEET S-30 GUARD RAIL
12	STANDARD SHEET S-30-A F. A. MARKERS
13	STANDARD SHEET S-40 BARRICADES, SIGNS & LIGHTS
14	STANDARD SHEET S-41 ROUNDING OF SLOPES
15-32	CROSS SECTIONS ROADWAY STA. 249+50 - 307+54.8
33-34	CROSS SECTIONS CHANNEL STA. 277+94

STANDARD STRUCTURE SHEETS
 APPROVED BY THE CHIEF ENGINEER
 S-28 JULY 11, 1933
 S-30 AUG. 15, 1934

STATE OF VERMONT
 STATE HIGHWAY DEPARTMENT

PLAN AND PROFILE OF PROPOSED
 STATE HIGHWAY
 FEDERAL AID PROJECT FAP 91D-(1)

TOWN OF HARTFORD Pin# 00R 731

WHITE RIVER JUNCTION - SHARON ROAD Rk. VT 14

BEGINNING AT A POINT 2.4 MILES SOUTH OF WEST HARTFORD VILLAGE AND EXTENDING NORTHWEST-ERLY 1.098 MILES.

LENGTH OF PROJECT 5,800.2 FT. = 1.098 MILES

FED. ROAD DIST. NO.	STATE	FED. AID PROJ. NO.	FISCAL YEAR	SHEET NO.	TOTAL SHEETS
9	Vt.	91D-(1)	1941	7	34



SCALE: 1 INCH = 1 MILE

RECORD PLANS
 W. H. Chase

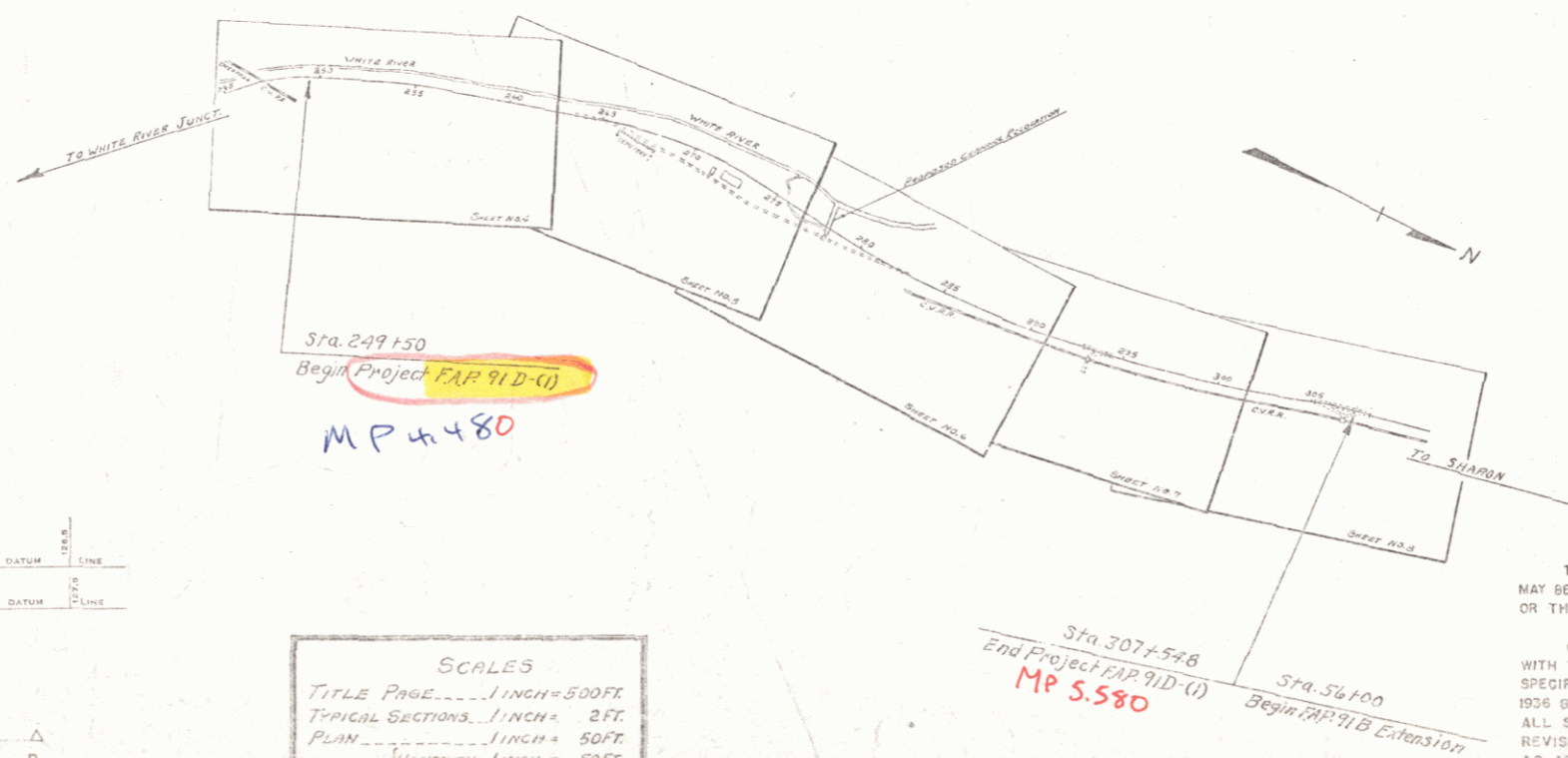

APPROVED: June 13, 1940
 Commissioner of Highways
 SUBMITTED BY ORDER OF THE STATE HIGHWAY BOARD

CONVENTION SIGNS

GROUND ELEVATION DATUM LINE
 GRADE ELEVATION DATUM LINE

CURVE DATA
 DEFLECTION ANGLE Δ
 DEGREE OF CURVE D
 RADIUS OF CURVE R
 TANGENT DISTANCE T
 LENGTH OF CURVE L
 EXTERNAL DISTANCE E
 POINT OF INTERSECTION P. I.
 POINT OF CURVE P. C.
 POINT OF TANGENT P. T.
 POINT ON TANGENT P. O. T.

SCALES
 TITLE PAGE 1 INCH = 500 FT.
 TYPICAL SECTIONS 1 INCH = 2 FT.
 PLAN 1 INCH = 50 FT.
 PROFILE (Horizontal) 1 INCH = 50 FT.
 PROFILE (Vertical) 1 INCH = 10 FT.
 CROSS SECTIONS 1 INCH = 5 FT.

THESE PLANS ARE SUBJECT TO SUCH REVISIONS AS MAY BE REQUIRED BY THE PUBLIC ROADS ADMINISTRATION OR THE COMMISSIONER OF HIGHWAYS.

CONSTRUCTION IS TO BE CARRIED ON IN ACCORDANCE WITH THE PLANS AND THE STANDARD ROAD AND BRIDGE SPECIFICATIONS OF 1936, AS APPROVED DECEMBER 29TH, 1936 BY THE PUBLIC ROADS ADMINISTRATION, INCLUDING ALL SUBSEQUENT APPROVED REVISIONS AND SUCH REVISED SPECIFICATIONS AND SPECIAL PROVISIONS AS ARE SUBMITTED WITH THE PLANS.

RECOMMENDED FOR APPROVAL

APPROVED: _____
 PUBLIC ROADS ADMINISTRATION
 FEDERAL AID PROJECT

APPROVED: _____
 PUBLIC ROADS ADMINISTRATION
 FEDERAL AID PROJECT

APPROVED: June 13, 1940 APPROVED: _____
 HEAD ENGINEER DISTRICT HIGHWAY COMMISSIONER
 SERIES FAP No. 91D(1) FILED SHEET 7 OF 34