

PLAN  
 DATE: 6/84  
 DRAWN BY: [Name]  
 CHECKED BY: [Name]  
 NO. 1

PROFILE  
 DATE: [Blank]  
 DRAWN BY: [Name]  
 CHECKED BY: [Name]  
 NO. 1

Three Cable Guard Rail with  
 Steel Posts Item 323  
 116+00 - 128+85 LT ✓  
 128+37 - 128+85 LT ✓

Removal and Disposal of Present  
 Guard Rail Item 350  
 116+00 - 128+85 LT ✓  
 128+37 - 128+85 LT ✓

Stone Fill for Slope Protection  
 Item 322  
 116+00 - 128+00 LT ✓

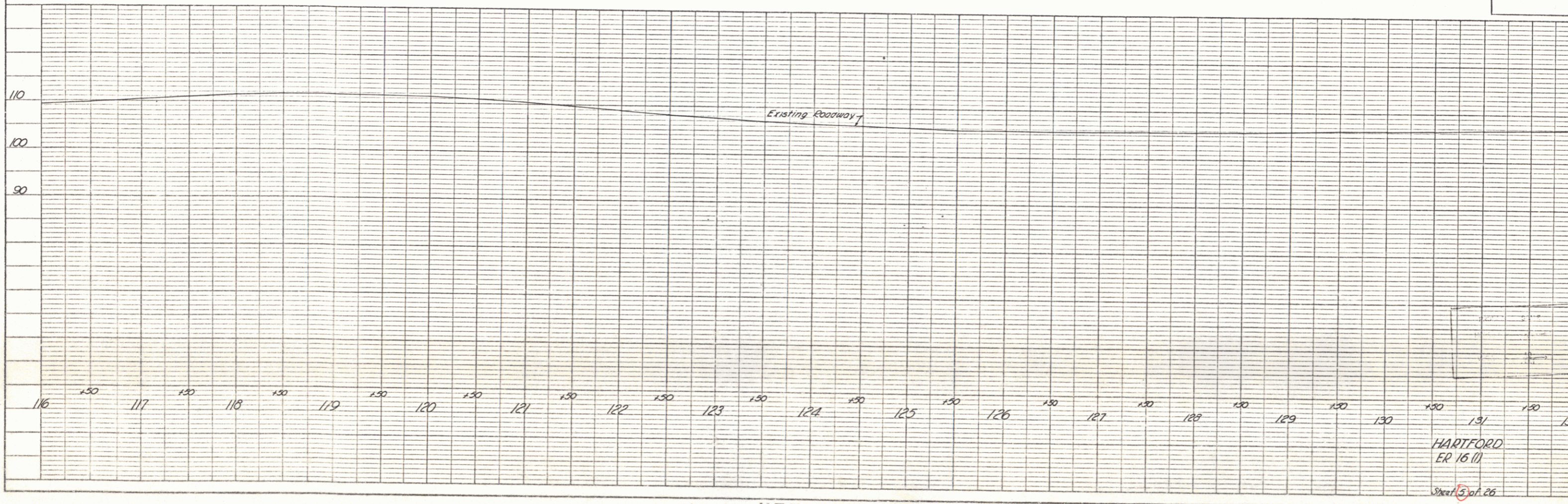
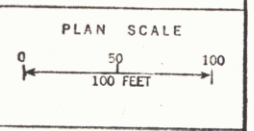
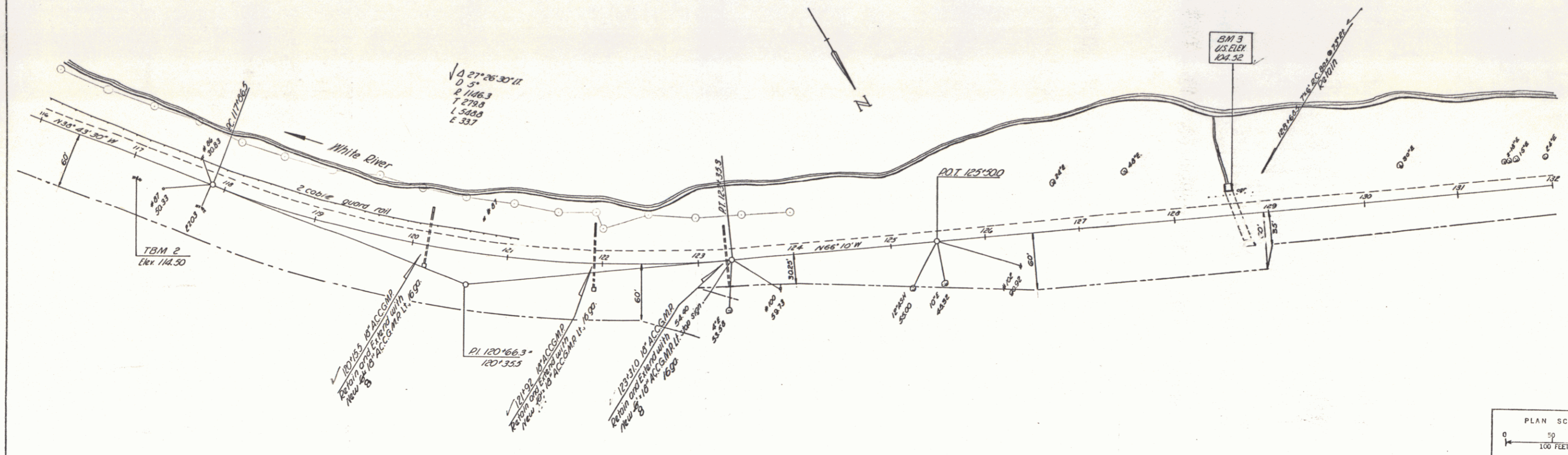

HARTFORD  
 ER 16 (1)  
 Sheet 5 of 26