

No Changes in  
Grade or E

DIST. NO.	STATE	SY. NO.	FISCAL YEAR	SHEET NO.	TOTAL SHEETS
5	Vt.	91(7)	1926	5	53

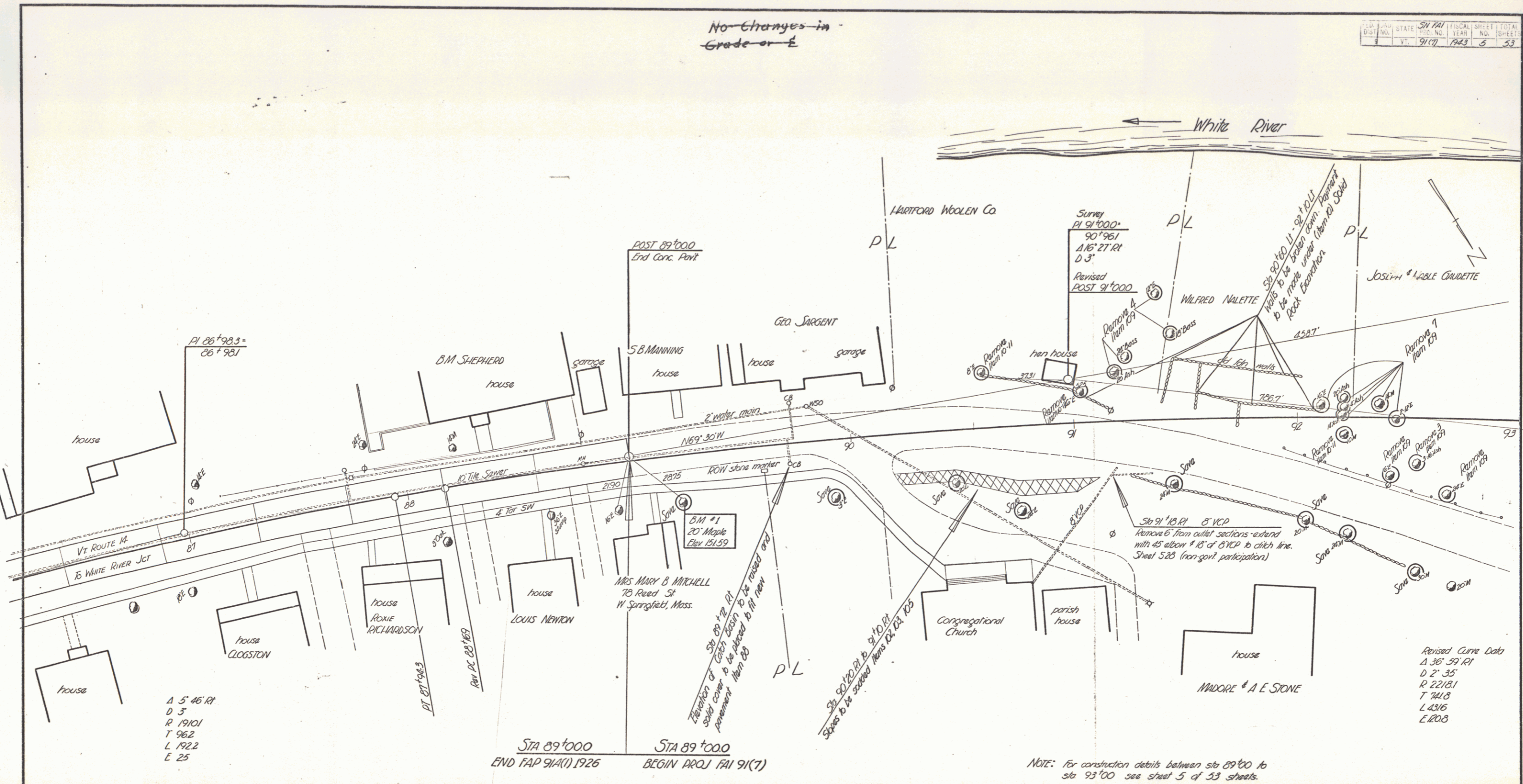

A 5' 46" RI  
D 3'  
R 191.01  
T 96.2  
L 192.2  
E 25

STA 89+000 END TAP 91A(1) 1926  
STA 89+000 BEGIN PROJ. 91(7)

NOTE: For construction details between sta 89+00 to sta 93+00 see sheet 5 of 53 sheets.

Revised Curve Data  
A 36' 59" RI  
D 2' 35"  
R 2218.1  
T 741.8  
L 4316  
E 120.8

ESTIMATED QUANTITIES		HARTFORD SY. 91(7)	
		Surveyed by	F. Barrett
		Designed by	
		Drawn by	E. Raymond Rogers
		Traced by	Lou Loh
		Checked by	
		Series	SY. 91(7) Filed
		Sheet	5A of 53 Sheets