

Wood Guard Rail Required

CUM. STA.	Left	Right
88+87	24'	24'
90+50-90+88	24'24"	24'
90+90-91+14	24'16"	24'16"
78+25	18'	18'

Wood Guide Posts Required

CUM. STA.	Left	Right
88+87	1	1
88+197	1	1
78+25	1	1

NEW REINF CONC PIPE GULY REQUIRED
 STA. 78+25 TO STA. 80+00
 12" DIA. LEAD 6000# STEEL CEMENTED MASS
 11'25" LONG 15' SPACING 1.2 CY
 84+77 12' 36" 1.2

Relay Pipe CGMP
 78+25 RT 12" 16' 1.2 cy cem. Rub. Mas.

Plain Concrete Gutter
 90+78 - 90+79 L & R 5' CY
 (13?)

125-A 1751 9 85

74530
PHASE I

67530
PHASE II
CHANCE

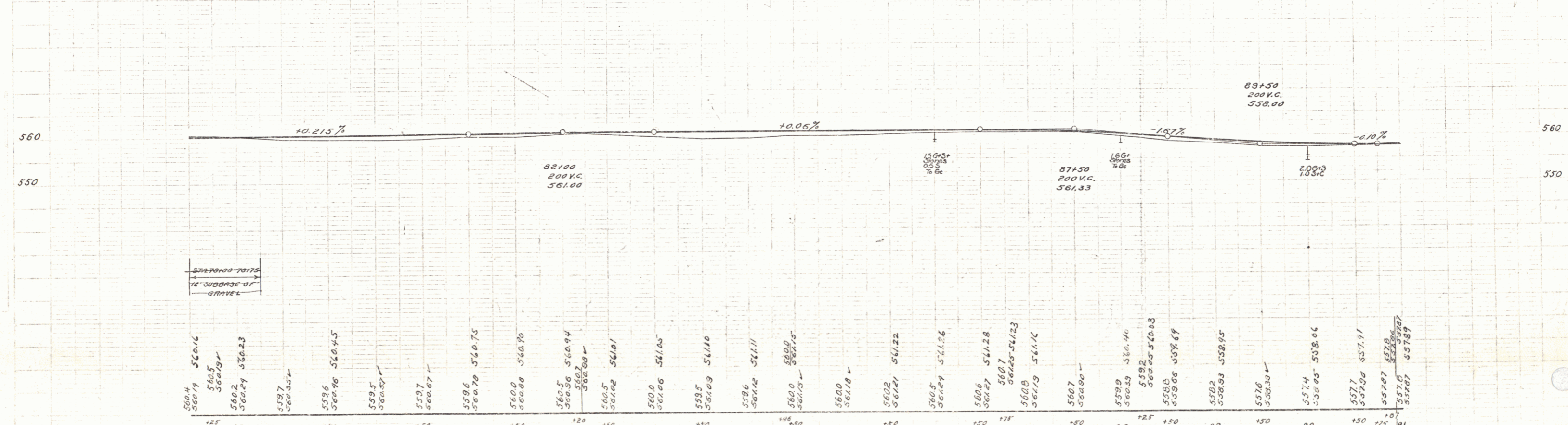
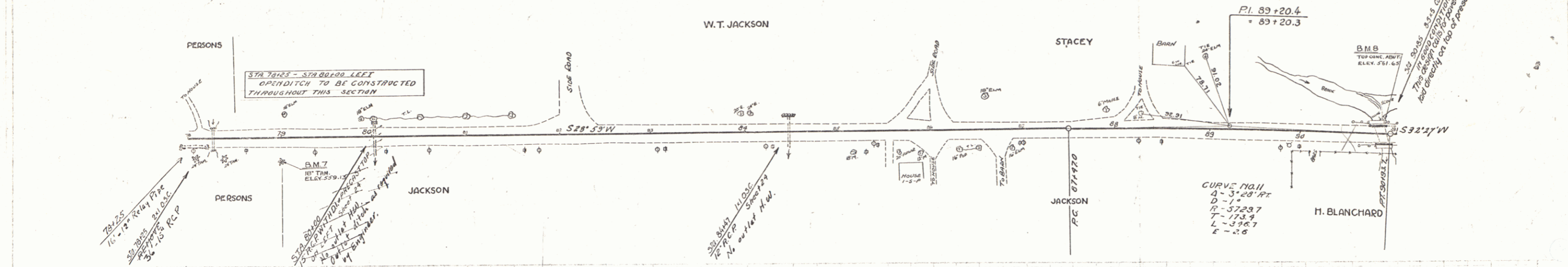

B.M. NO. 7 SPIKE IN ROOT 18' TAMARACK 23 FT. RT. STA. 78+93 - ELEV. 559.18
 B.M. NO. 8 TOP CONC. ABUT. SE COR. BRIDGE 12' LT. STA. 90+92 - ELEV. 561.65

SERIES F No 129A
 SHEET 3 OF 85

14