

**INDEX OF SHEETS**

SHEET NO. 1 TITLE PAGE  
 " 2 TYPICAL CROSS-SECTION OF IMPROVEMENT- ONE COURSE CEMENT CONCRETE PAVEMENT.  
 " 3 DETAILS OF CONSTRUCTION- BANKING, 4 KING STEEL IN PAVEMENT.

4-23 LAYOUTS  
 24 STANDARD STRUCTURE SHEET S20- PIPE CULVERTS  
 25 " " " S21- BOX CULVERTS  
 26 " " " S22- GUARD RAIL  
 27 " " " S23- DETAILS OF CONSTRUCTION  
 28 " " " S.C. 1

29-31 Standard Equipment  
 32 STANDARD SHEET S2B-20-25 - MODIFIED FOR 23  
 33 " " " S.B. No. 5 - CABLE RAIL  
 34 " " " S.B. No. 2 - S201, S202, S203  
 35 " " " S.B. No. 2A - S223, S227, S229  
 36 " " " S.B. No. 2B - S247  
 37 " " " S.B. No. 2 - S209.  
 38-65 Cross Sections

| FED. ROAD DIST. NO. | STATE | FED. AID PROJ. NO. | FISCAL YEAR | SHEET NO. | TOTAL SHEETS |
|---------------------|-------|--------------------|-------------|-----------|--------------|
| 9                   | VT.   | 129-A              | 1931        | 1         | 85           |

STATE OF VERMONT  
 STATE HIGHWAY DEPARTMENT

PLAN AND PROFILE OF PROPOSED  
 STATE HIGHWAY  
 FEDERAL AID PROJECT

TOWNS OF BARRE - WILLIAMSTOWN Pin#00R722

WILLIAMSTOWN GULF ROAD

FROM THE BARRE CITY LINE  
 SOUTH 5.152 MILES TO A BRIDGE  
 2000 FEET SOUTH OF WILLIAMSTOWN VILLAGE

LENGTH OF PROJECT EXCLUDING BRIDGE OVER 20 FT. SPAN 2718.1 FT. = 5147 MILES  
 LENGTH OF PROJECT INCLUDING BRIDGE OVER 20 FT. SPAN 27207.1 FT. = 5152 MILES



(To Be Returned to E.O.W. Division)  
 Form of  
 PERPETUAL  
 ESTATE  
 RIGHT-OF-WAY DIVISION

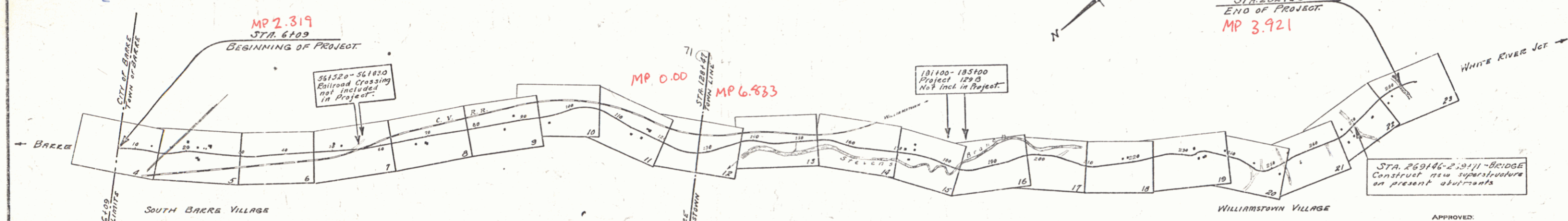

RECORD PLANS

Project No. F 129A  
 Rte. VT 14

APPROVED:  
*H. Johnson*  
 COMMISSIONER OF HIGHWAYS  
 SUBMITTED BY ORDER OF THE STATE HIGHWAY BOARD

SEE ANY FURTHER INFORMATION CONCERNING THIS PROJECT AT THE OFFICE OF THE CHIEF ENGINEER, BUREAU OF PUBLIC ROADS, STATE HOUSE, MOUNTAIN VIEW, VERMONT. THE FIELD OFFICE OR THE ESTIMATE FILE.

**CONVENTIONAL SIGNS**

|                   |                  |
|-------------------|------------------|
| COUNTY LINE       | GROUND ELEVATION |
| TOWN LINE         | GRADE ELEVATION  |
| FENCE LINE        |                  |
| STONE WALL        |                  |
| UNFENCED PROPERTY |                  |
| GUARD RAIL        |                  |
| TRAVELED WAY      |                  |
| RAILROAD          |                  |
| RETAINING WALL    |                  |
| CENTER LINE       |                  |
| SURVEY LINE       |                  |
| CULVERT           |                  |
| DROP INLET        |                  |
| TROLLEY POLE      |                  |
| POWER POLE        |                  |
| TELEPHONE POLE    |                  |
| TREES             |                  |
| HEDGE             |                  |

**CURVE DATA**

|                       |          |
|-----------------------|----------|
| DEFLECTION ANGLE      | Δ        |
| DEGREE OF CURVE       | D        |
| RADIUS OF CURVE       | R        |
| TANGENT DISTANCE      | T        |
| LENGTH OF CURVE       | L        |
| EXTERNAL DISTANCE     | E        |
| POINT OF INTERSECTION | P. I.    |
| POINT OF CURVE        | P. C.    |
| POINT OF TANGENT      | P. T.    |
| POINT ON TANGENT      | P. O. T. |

SCALES  
 Title: 1" = 1000'  
 Plan: 1" = 50'  
 Profile: Hor. 1" = 50', Vert. 1" = 10'  
 Cross Sections: 1" = 5'

These plans are subject to such revisions as may be required by the Bureau of Public Roads or the Chief Engineer

RECOMMENDED  
 DISTRICT ENGINEER  
 RECOMMENDED FOR APPROVAL  
 CHIEF ENGINEER

APPROVED  
 CORRECT  
 ROAD ENGINEER  
 PLANS COMPLETED

SERIES F. No. 129A FILED  
 SHEET 1 OF 85

MAY 15 1974

STEARNS R. JENKINS

Rte 14