

WOOD CHAIR PILE REQUIRED	
Sta. Station	LT.
1102+60	24'
1107+50	24'
1114+60	24'

CABLE GUARD PILE REQUIRED	
Sta. Station	LT.
1102+60	24'
1107+50	24'
1114+60	24'

GUIDE POSTS OF WOOD REQUIRED	
Station	LT.
1107+50	1
1114+60	1

NEW REIN. CONC. PIPE CULVERTS REQUIRED					
Station	DIAM.	LENG.	CONC.	C.R.M.	STEEL
1102+60	27"	27'			
1107+50	18"	17'			
1114+60	18"	14'			

RELAID PIPE CULVERTS REQUIRED	
Station	LENG.
1103+40	24'
1113+30	36'
1115+00	36'

DRY RUBBLE MASONRY REQUIRED		
Station	LENG.	VOLUME
1109+50	131'	61
1111+15	211'	61

Parcel	Kind of Instrument	Date of Grant	Grantor	Grantee	Recorded	Remarks
Culv. #5	G.C.D.	11-15-32	Calvin A. Gifford	Sta. 1102+60	30	359
A.B. Culv. #1	"	11-2-31	A.M. Smith	Sta. 1103+76.8	30	359
A.Culv. #1	"	11-2-31	Harvey Hackett	Sta. 1114+60	30	387-383

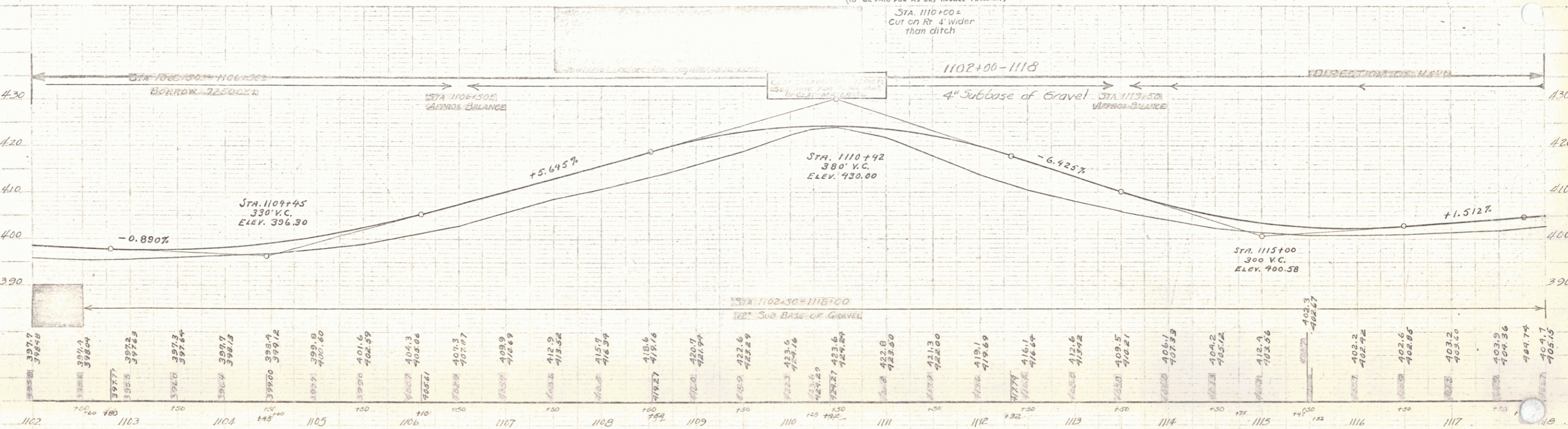
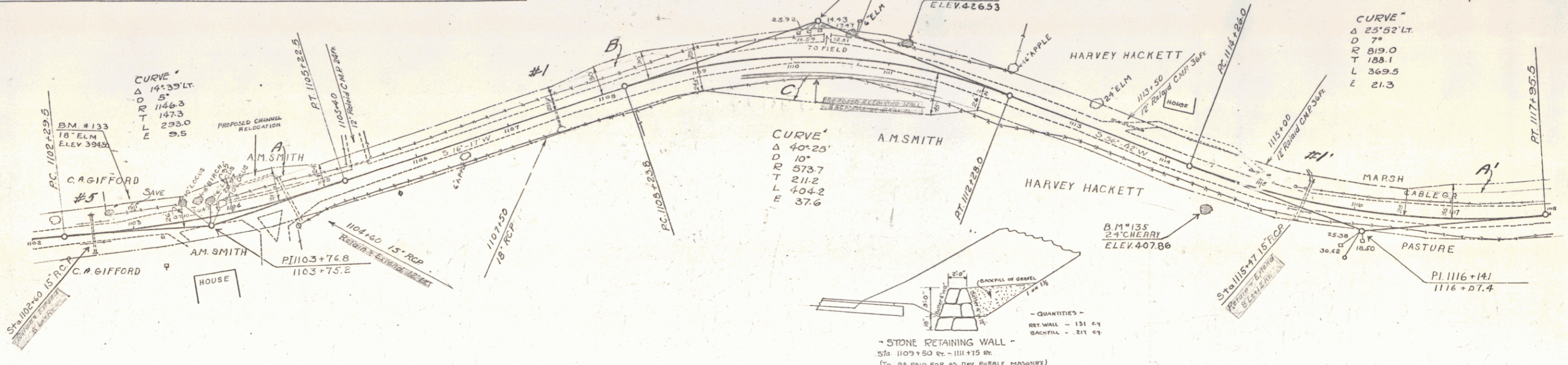

B.M.#133 SPIKE IN ROOT OF 18" ELM 18' LT. OF STA. 1103+00 ELEV. 394.50
 B.M.#134 SPIKE IN ROOT OF 12" ELM 19' LT. OF STA. 1111+15 ELEV. 426.53
 B.M.#135 SPIKE IN ROOT OF 24" CHERRY 34' RT. OF STA. 1114+56 ELEV. 407.86

SERIES F No. 50-L
SHEET 57 OF 141