

CABLE GUINED PILE REQUIRED				NEW REINF. CONC. PIPE CULVERTS REQUIRED				RELAYED PIPE CULVERTS REQUIRED				GRAUDED COBBLE GUTTER REQUIRED			
Sta.	Len.	Loc.	By	Station	Diam	Len.	C.P.M.	Station	Len.	C.P.M.	Station	Len.	Width	Area	
1067+30	1067+60	14.5'	10/25	1067+70	36"	100'	2.2	1067+20	1067+50	30'	1064+10	1067+50	4'-6"	165 sq. yd.	
1071+04	1071+30	24'	20												
1071+04	1071+30	24'	20												

Guide Station	LF	EF
1064+20	1	1
1067+70	1	1
1072+20	1	1

Parcel	Kind of Instrument	Date of Instrument	Grantor	Grantee	Recorded	Remarks
A, B, C, etc.	1/4"	Q.C.D.	11-12-31	E.S. Hall	Shaff. 30 267-2	22-33 (Culv. Sta. 1067+70, 1071+04, 1071+30)

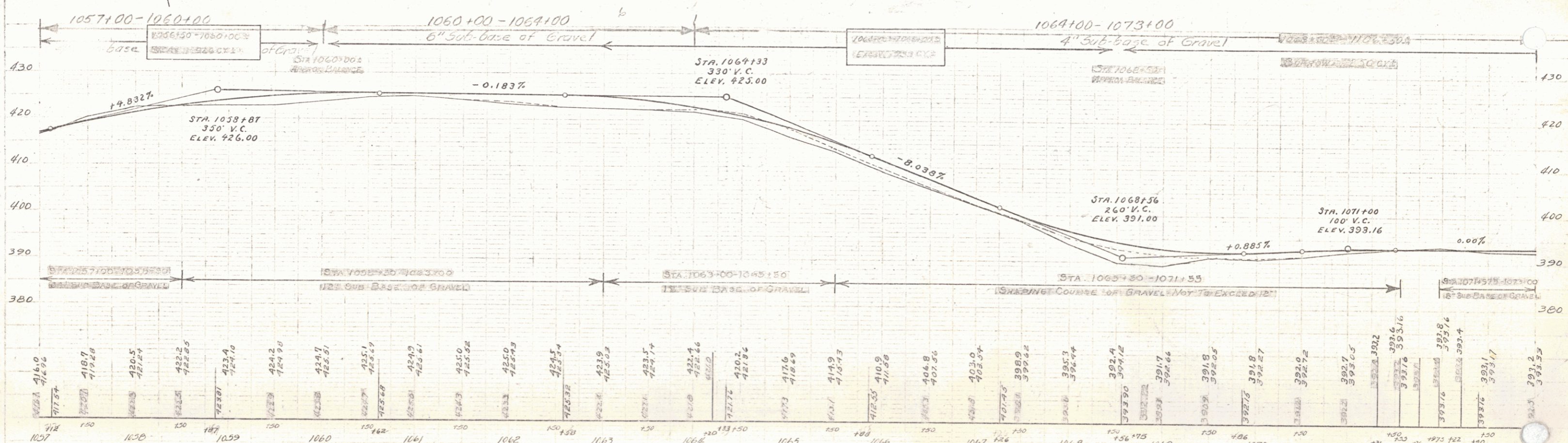
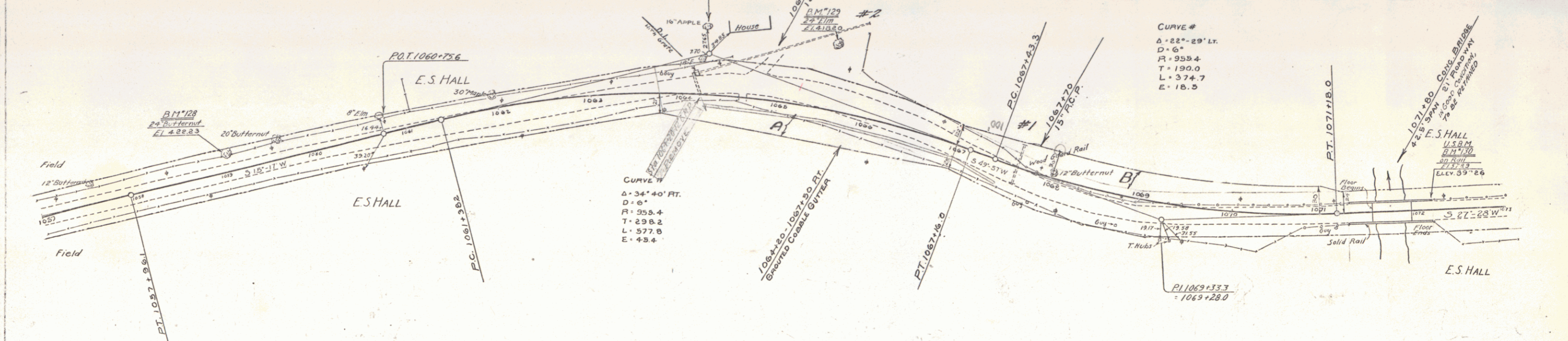

Station	Elevation
1057+00	416.0
1057+10	417.87
1057+20	418.7
1057+30	419.6
1057+40	420.5
1057+50	421.4
1057+60	422.2
1057+70	423.1
1057+80	423.9
1057+90	424.7
1058+00	425.5
1058+10	426.3
1058+20	427.1
1058+30	427.9
1058+40	428.7
1058+50	429.5
1058+60	430.3
1058+70	431.1
1058+80	431.9
1058+90	432.7
1059+00	433.5
1059+10	434.3
1059+20	435.1
1059+30	435.9
1059+40	436.7
1059+50	437.5
1059+60	438.3
1059+70	439.1
1059+80	439.9
1059+90	440.7
1060+00	441.5
1060+10	442.3
1060+20	443.1
1060+30	443.9
1060+40	444.7
1060+50	445.5
1060+60	446.3
1060+70	447.1
1060+80	447.9
1060+90	448.7
1061+00	449.5
1061+10	450.3
1061+20	451.1
1061+30	451.9
1061+40	452.7
1061+50	453.5
1061+60	454.3
1061+70	455.1
1061+80	455.9
1061+90	456.7
1062+00	457.5
1062+10	458.3
1062+20	459.1
1062+30	459.9
1062+40	460.7
1062+50	461.5
1062+60	462.3
1062+70	463.1
1062+80	463.9
1062+90	464.7
1063+00	465.5
1063+10	466.3
1063+20	467.1
1063+30	467.9
1063+40	468.7
1063+50	469.5
1063+60	470.3
1063+70	471.1
1063+80	471.9
1063+90	472.7
1064+00	473.5
1064+10	474.3
1064+20	475.1
1064+30	475.9
1064+40	476.7
1064+50	477.5
1064+60	478.3
1064+70	479.1
1064+80	479.9
1064+90	480.7
1065+00	481.5
1065+10	482.3
1065+20	483.1
1065+30	483.9
1065+40	484.7
1065+50	485.5
1065+60	486.3
1065+70	487.1
1065+80	487.9
1065+90	488.7
1066+00	489.5
1066+10	490.3
1066+20	491.1
1066+30	491.9
1066+40	492.7
1066+50	493.5
1066+60	494.3
1066+70	495.1
1066+80	495.9
1066+90	496.7
1067+00	497.5
1067+10	498.3
1067+20	499.1
1067+30	499.9
1067+40	500.7
1067+50	501.5
1067+60	502.3
1067+70	503.1
1067+80	503.9
1067+90	504.7
1068+00	505.5
1068+10	506.3
1068+20	507.1
1068+30	507.9
1068+40	508.7
1068+50	509.5
1068+60	510.3
1068+70	511.1
1068+80	511.9
1068+90	512.7
1069+00	513.5
1069+10	514.3
1069+20	515.1
1069+30	515.9
1069+40	516.7
1069+50	517.5
1069+60	518.3
1069+70	519.1
1069+80	519.9
1069+90	520.7
1070+00	521.5
1070+10	522.3
1070+20	523.1
1070+30	523.9
1070+40	524.7
1070+50	525.5
1070+60	526.3
1070+70	527.1
1070+80	527.9
1070+90	528.7
1071+00	529.5
1071+10	530.3
1071+20	531.1
1071+30	531.9
1071+40	532.7
1071+50	533.5
1071+60	534.3
1071+70	535.1
1071+80	535.9
1071+90	536.7
1072+00	537.5
1072+10	538.3
1072+20	539.1
1072+30	539.9
1072+40	540.7
1072+50	541.5
1072+60	542.3
1072+70	543.1
1072+80	543.9
1072+90	544.7
1073+00	545.5

B.M. # 128 SPIKE IN ROOT OF 24' BUTTERNUT 16.5' LT. OF STA. 1053+06 ELEV. 422.23  
 B.M. # 129 SPIKE IN ROOT OF 24' ELM 69' LT. OF STA. 1065+54 ELEV. 418.20  
 B.M. # 130 BRIDGE RAIL 11.6' LT. OF STA. 1072+22 ELEV. 397.20 U.S. B.M. ELEV. 578.9

SERIES F. No. 80 L  
 SHEET 54 OF 1-41