

WOOD GUARD RAIL REQUIRED

Station	LT	RT
1042+50	24'	—

CABLE GUARD RAIL REQUIRED

Station	L	R	Way	Length
1042+50	24'	—	—	—

GUIDE POSTS REQUIRED

Station	LT	RT
1042+50	—	1
1051+00	1	1
1055+80	1	—

NEW REINF. CONC. PIPE CULVERTS REQUIRED

Station	Diam	Length	Conc. A	C.R.M.	Steel
1042+50	2.34'	—	—	184#	—
1051+00	2.34'	—	—	99#	1
1052+00	2.34'	—	—	184#	—
1055+80	2.43'	—	—	54#	—

NEW REINF. CONC. BOX CULVERTS REQUIRED

Station	Size	Conc. A	Steel
1042+50	4'x6'	—	—

GRAUTED CABLE GUTTER REQUIRED

Station	L or R	Width	Area
1044+00-1042+50	RT	4'6"	75 sq. ft.
1044+00-1045+50	RT	4'6"	75 sq. ft.
1045+00-1046+00	LT	4'6"	50 sq. ft.

STATE ROAD DISTRICT NO. 1000
 DISTRICT ENGINEER
 DATE: 11-12-31
 SHEET NO. 141

Period: 11-12-31
 Kind of Instrument: G.C.D.
 Name of Engineer: H.W. ARMSTRONG
 Date of Survey: 11-12-31
 Remarks: See notes on drawings

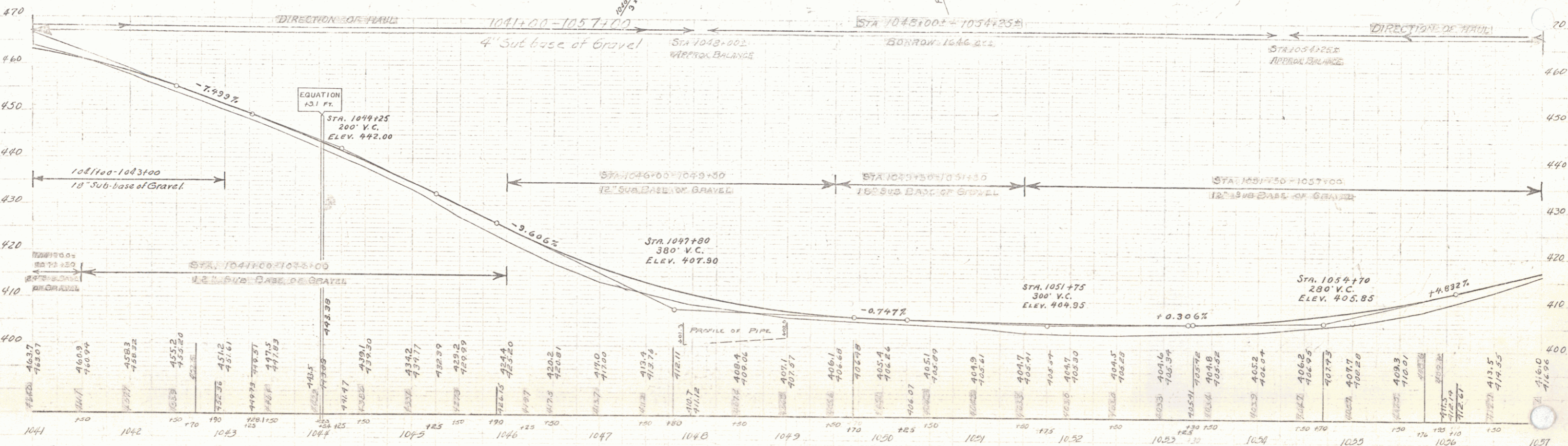
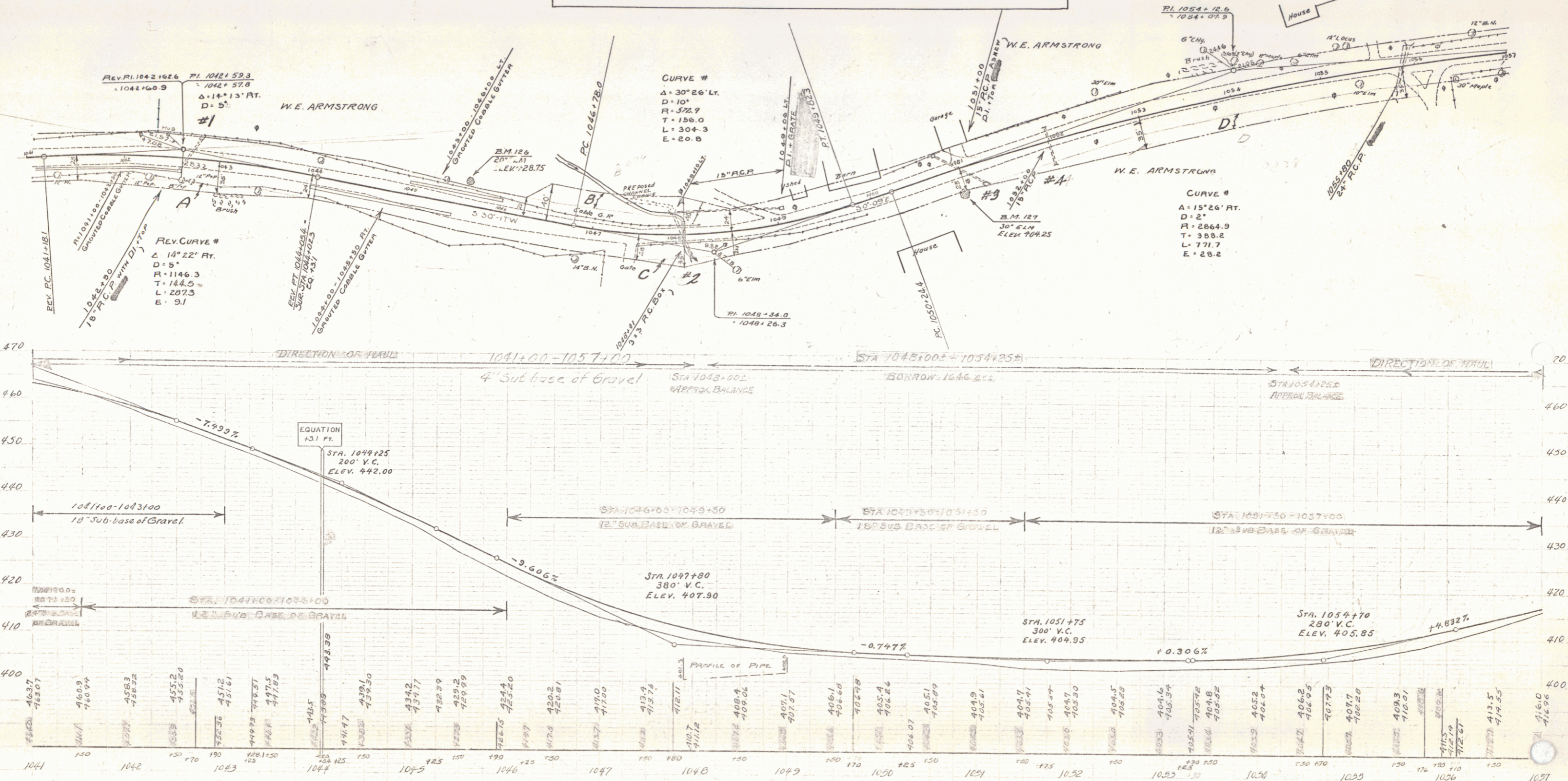

B.M. 126 Spike in Root 20' Elm 22' Lt of Sta 1045+40 E. 428.75
 B.M. 127 " " " 30' " 22' Rt of Sta 1050+96 E. 404.25

JERES F No. 80-L
 SHEET 141