

GUIDE POST REQUIRED
 Curb Station 1000+50
 1005+47
 1006+93

PLACED BACK OF SIDE WALK

NEW REIN. CONCRETE PIPE CULVERTS REQUIRED

STATION	DIAM.	LENG.	CONC. A	CONC. C	STEEL	GRATES
993+10	18"	100'	2.1 cy	1.0 cy	102 #	1
993+30	18"	32'	0.6 cy	0.3 cy	33 #	1
993+10	18"	176'	1.8 cy	0.8 cy	102 #	1
996+44	18"	74.5'	1.7 cy	0.8 cy	102 #	1
1001+30	18"	85'	1.8 cy	0.8 cy	102 #	1
1000+45	18"	64'	0.7 cy	0.3 cy	33 #	2
1003+10	18"	136'	1.9 cy	0.9 cy	102 #	1
1003+10	18"	100'	1.7 cy	0.8 cy	102 #	1
1005+17	18"	84'	1.3 cy	0.6 cy	78 #	1
1006+83	18"	40'	0.4 cy	0.2 cy	15 #	1
1007+15	18"	175'	1.7 cy	0.8 cy	102 #	1
1007+15	18"	175'	1.7 cy	0.8 cy	102 #	1
1007+15	18"	175'	1.7 cy	0.8 cy	102 #	1

WHERE D.I. WITH SUMP GRATE ARE CALLED FOR, CONSTRUCT THE SUMP 12" BELOW THE FLOW LINE OF THE PIPE.

Parcel	Kind of Instrument	Date of Grantor	Grantee	Recorded	Remarks
Calculated #1	D.C.D.	11-6-31	RA & LA Bean	Staff 50 131	1-3-32 Sta. 1001+45
		11-6-31	L.L. & A.G. Smith	" " 50 263	2-3-32 "

STATE ROAD STATE ROAD PROJECT YEAR NO. SHEET
 80-L-1931-50-1-11

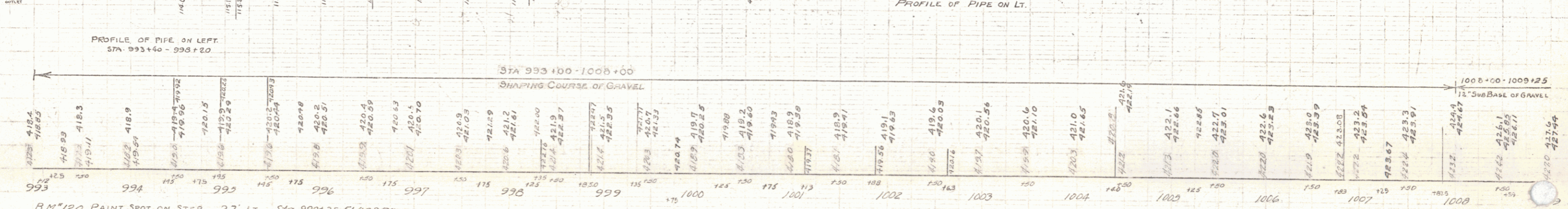
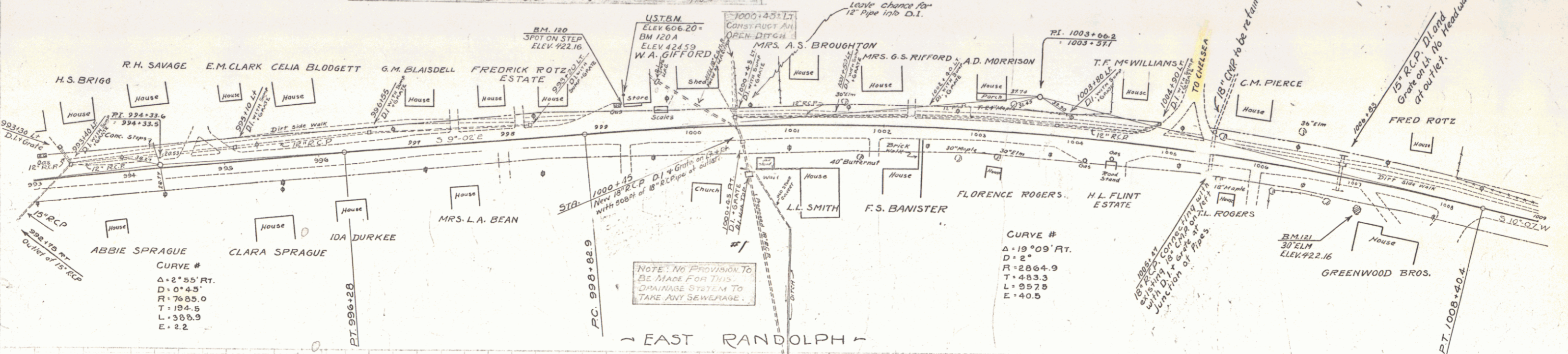

BM 120 PAINT SPOT ON STEP - 27' LT. STA 999+25 ELEV 422.74
 BM 121 SPIKE IN ROOT OF 30' ELM 26' FT. OF STA 1007+08 ELEV 422.16
 BM 120A ON STORE 40' FT. OF STA 999+23 ELEV 424.59 = USTBM ELEV 606.20

SERIES F No. 004
 SHEET 50 OF 121