

WOOD GUARD RAIL REQUIRED	CABLE GUARD RAIL REQUIRED		
Cul. Station	LT	RT	30'-36" L x R 10' High Galv. Rib Lining
970+65	24	-	30x30x30x10 L 300 40 400
973+38	24	-	36x36x36x10 R 40 40 200

GUIDE POSTS REQUIRED	LT	RT
967+42	-	1
968+65	-	1
973+38	-	1
975+05	1	1

NEW SPENT CONCRETE PIPE CULVERTS REQUIRED	DIAPHRAGM INLET TOP REQUIRED			
STATION	DIAM.	LEN. CONC. A	STEEL	
967+05	18"	36'	2.55	154.9
970+65	18"	36'	2.55	154.9
973+38	18"	36'	2.55	154.9

RELAYED PIPE CULVERTS REQUIRED				
STATION	DIAM.	LEN. CONC. A	STEEL	
970+65	18"	36'	2.55	154.9

RELAYED PIPE CULVERTS REQUIRED				
STATION	DIAM.	LEN. CONC. A	STEEL	
965+90-970+50	18" C.M.P.	60'	1.9 67	73#

10' x 8' CONC. BOX CULVERT STA. 965+56

SHEETS REQUIRED
 Sheet No. 101M Plan and Profile Bridge No. 1
 " " 11M 10' x 8' Box Culvert Plans
 " " 12M SB No. 5
 " " 13M Cross Sections.

ESTIMATE OF QUANTITIES
 Item No. 14 Channel Excavation
 " 15 Structure Excavation
 " 33A Concrete Class A
 " 34 Reinforcing Steel
 Temporary Bldg., Maintaining Traffic and Removing present Superstructure

35 Cu. Yds.
 100 " "
 72 " "
 4775 lbs.
 1 L.S.

NOTES
 The construction covering the Bridge at Sta. 965+56 shall include building of the Bridge and disposal of structure and channel excavation only.
 All suitable channel and structure excavation material shall be used for backfill and approach fill as directed by the Engineer.

Period	Kind of Instrument	Date of Instrument	Grantor	Grantee	Recorded	Remarks
A	O.C.D.	11-23-31	Town of Randolph	Both Ferry	39	238.1
B	"	10-20-31	RE & R.I. Kellogg	"	50	267
C	"	11-12-31	L.R. & M.M. DeBano	"	50	245-6
D	"	11-12-31	Inez Collins	"	50	235
E	"	10-29-31	R.H. Savage	"	50	265

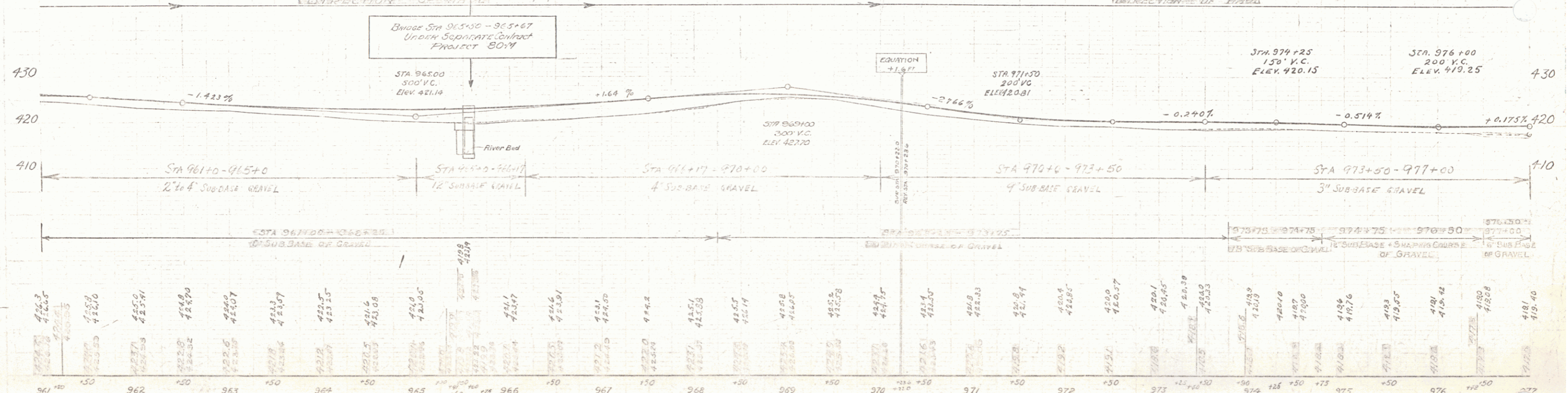
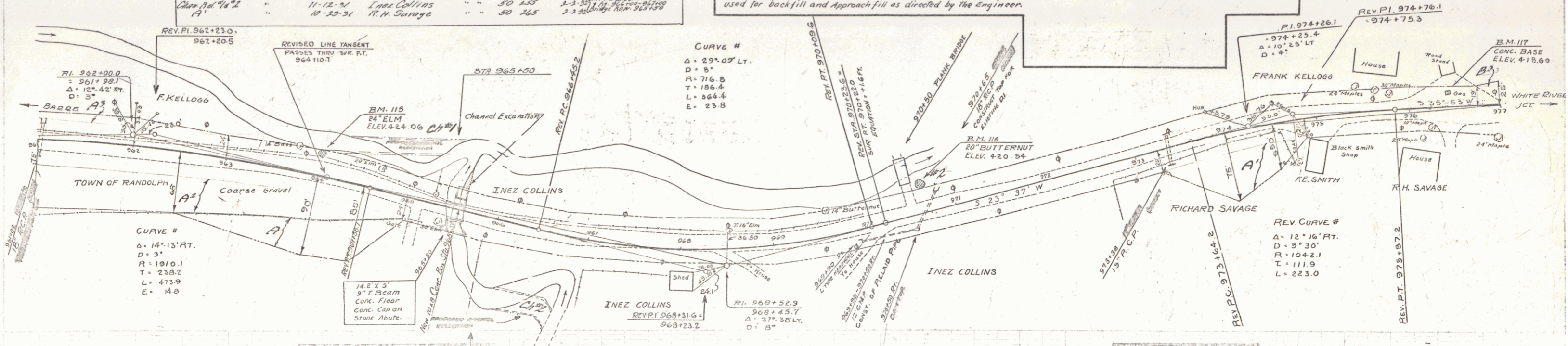

Station	Elevation
961+50	416.2
962+00	416.5
962+50	416.8
963+00	417.1
963+50	417.4
964+00	417.7
964+50	418.0
965+00	418.3
965+50	418.6
966+00	418.9
966+50	419.2
967+00	419.5
967+50	419.8
968+00	420.1
968+50	420.4
969+00	420.7
969+50	421.0
970+00	421.3
970+50	421.6
971+00	421.9
971+50	422.2
972+00	422.5
972+50	422.8
973+00	423.1
973+50	423.4
974+00	423.7
974+50	424.0
975+00	424.3
975+50	424.6
976+00	424.9
976+50	425.2
977+00	425.5
977+50	425.8
978+00	426.1
978+50	426.4
979+00	426.7
979+50	427.0
980+00	427.3
980+50	427.6
981+00	427.9
981+50	428.2
982+00	428.5
982+50	428.8
983+00	429.1
983+50	429.4
984+00	429.7
984+50	430.0
985+00	430.3
985+50	430.6
986+00	430.9
986+50	431.2
987+00	431.5
987+50	431.8
988+00	432.1
988+50	432.4
989+00	432.7
989+50	433.0
990+00	433.3
990+50	433.6
991+00	433.9
991+50	434.2
992+00	434.5
992+50	434.8
993+00	435.1
993+50	435.4
994+00	435.7
994+50	436.0
995+00	436.3
995+50	436.6
996+00	436.9
996+50	437.2
997+00	437.5
997+50	437.8
998+00	438.1
998+50	438.4
999+00	438.7
999+50	439.0
1000+00	439.3

B.M. No. 115 SPIKE IN FOOT OF 24" ELM 23' LT, STA. 963+93 ELEV. 424.06
 B.M. No. 116 SPIKE IN FOOT OF 20" BUTTERNUT 29' LT, STA. 970+49 ELEV. 420.54
 B.M. No. 117 CONC. BASE OF GAS PUMP 19.5' LT, STA. 976+39 ELEV. 418.60

SERIES NO. 80-M SHEET 10-M OF 13-M SHEETS
 SERIES S.A.P. NO. 80-L SHEET 14 OF 141