

WOOD GUARD RAIL REQUIRED

Guide Station	LT	RT
745+65	24	24
757+18	24	24

GUIDE POSTS OF WOOD REQUIRED

STATION	LT	RT
757+18	1	-

NEW REIN. CONC. PIPE CULVERTS REQUIRED

STATION	DIAM.	LEN.	CONC. A	CONC. B	CONC. C
752+18	18"	30'	1	1	1

DRILEWAY CULVERTS REQUIRED

STATION	TYPE	DIAM.	LENGTH	CONC.
744+75	LT	RCP 18"	24'	2.3

FED. ROAD DIST. NO. STATE DIST. NO. COUNTY DIST. NO. SHEET NO.

9	VT	129-C	1931	39	141
---	----	-------	------	----	-----

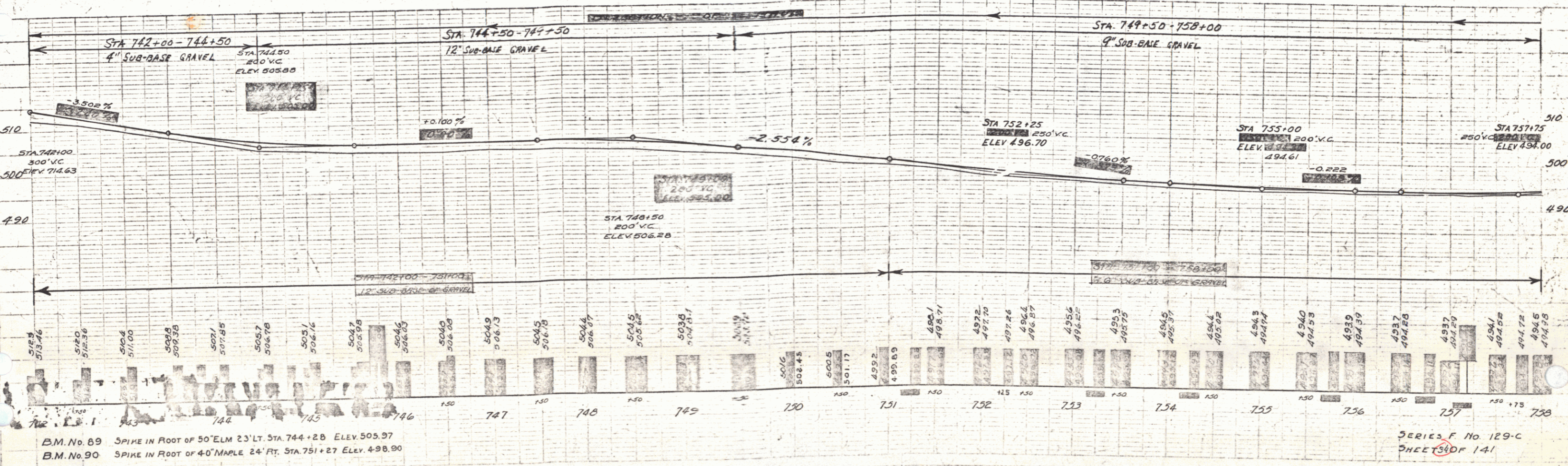
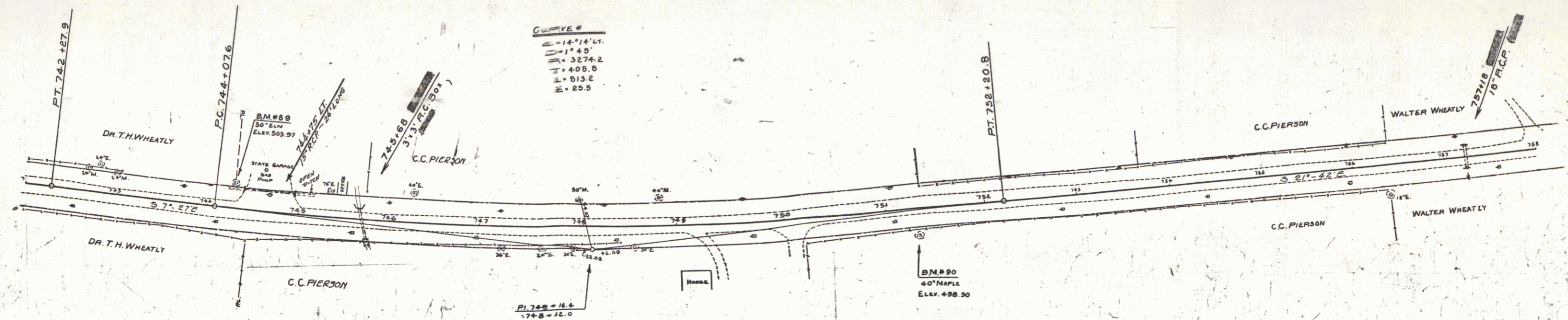

B.M. No. 89 SPIKE IN ROOT OF 50' ELM 23' LT. STA. 744+28 ELEV. 505.97
 B.M. No. 90 SPIKE IN ROOT OF 40' MAPLE 24' FT. STA. 751+27 ELEV. 498.90

SERIES F No. 129-C
 SHEET 34 OF 141