

WOOD GUARD RAIL REQUIRED
 Cur. Station L^c R^c
 490+01 - 29'

CABLE GUARD RAIL REQUIRED
 Sta. Sta L or R Leng. Constant T₁ Length
 490+00 - 490+40 18' 40' 25'

NEW RAIN GUTTER PIPE CURBETS REQUIRED

| STATION | QUM. | LENS. | CURB | GRN | STEEL |
|---------|------|-------|------|-----|-------|
| 490+25 | 10' | 10' | 10' | 10' | 10' |
| 490+35 | 10' | 10' | 10' | 10' | 10' |
| 490+40 | 10' | 10' | 10' | 10' | 10' |
| 490+50 | 10' | 10' | 10' | 10' | 10' |
| 490+60 | 10' | 10' | 10' | 10' | 10' |
| 490+70 | 10' | 10' | 10' | 10' | 10' |
| 490+80 | 10' | 10' | 10' | 10' | 10' |
| 490+90 | 10' | 10' | 10' | 10' | 10' |
| 490+100 | 10' | 10' | 10' | 10' | 10' |
| 490+110 | 10' | 10' | 10' | 10' | 10' |
| 490+120 | 10' | 10' | 10' | 10' | 10' |
| 490+130 | 10' | 10' | 10' | 10' | 10' |
| 490+140 | 10' | 10' | 10' | 10' | 10' |
| 490+150 | 10' | 10' | 10' | 10' | 10' |
| 490+160 | 10' | 10' | 10' | 10' | 10' |
| 490+170 | 10' | 10' | 10' | 10' | 10' |
| 490+180 | 10' | 10' | 10' | 10' | 10' |
| 490+190 | 10' | 10' | 10' | 10' | 10' |
| 490+200 | 10' | 10' | 10' | 10' | 10' |

NEW SMOKE MASONRY REQUIRED

| STATION | CURB | LENGTH | VOLUME |
|---------|--------|--------|------------|
| 487+00 | 487+42 | 42' | 23.2 Cu Yd |

| FED. ROAD DIST. NO. | STATE | YEAR | PROJECT NO. | SHEET NO. | TOTAL SHEETS |
|---------------------|-------|-------|-------------|-----------|--------------|
| 9 | VT | 189-C | 1201 | 18 | 141 |

Parcel Map of Date of Grantor Grantee Recorded Remarks
 A.B.C. G.C.D. 8-27-31 T.H. Wheatley St of Vt Brookfield
 Cur. Sta. 489+00, 495+00 & 495+100
 Chan. No. 43100-43150

GUIDE POSTS REQUIRED

| Cur. Station | L ^c | R ^c |
|--------------|----------------|----------------|
| 486+20 | 1 | 1 |
| 490+01 | 1 | 1 |
| 490+40 | 1 | 1 |
| 498+50 | 1 | 1 |
| 493+00 | 1 | 1 |
| 495+00 | 1 | 1 |
| 495+50 | 1 | 1 |

CURVE #
 Δ 22°20'
 D 8°
 R 716.8
 T 142.6
 L 281.3
 E 14.0
 DO NOT WIDEN

CURVE #
 Δ 9°05'
 D 6°
 R 955.4
 T 75.9
 L 151.4
 E 3.0
 DO NOT WIDEN

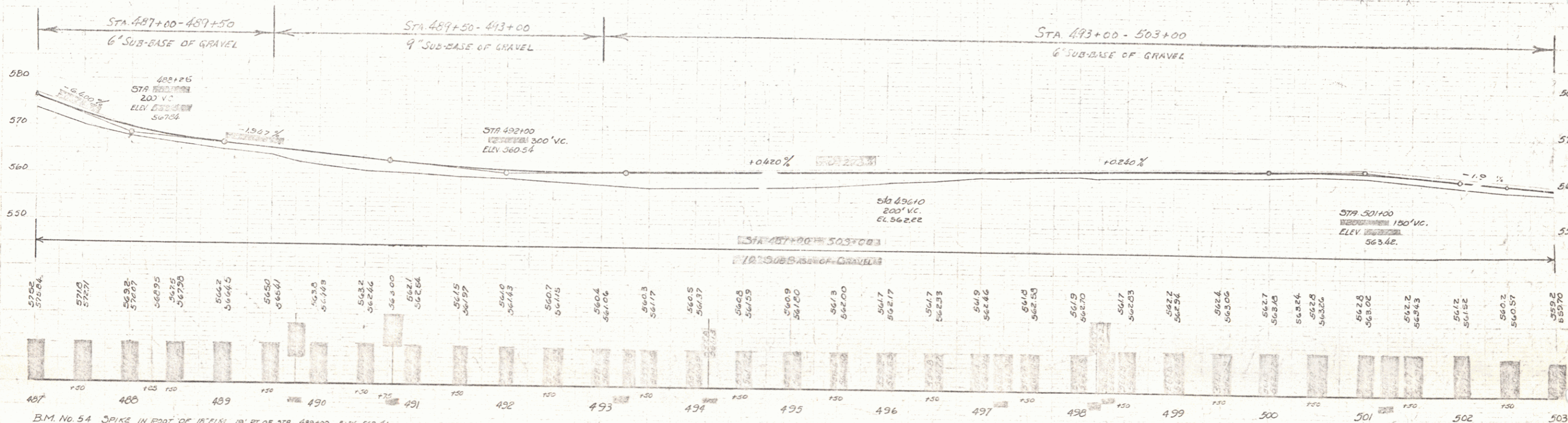
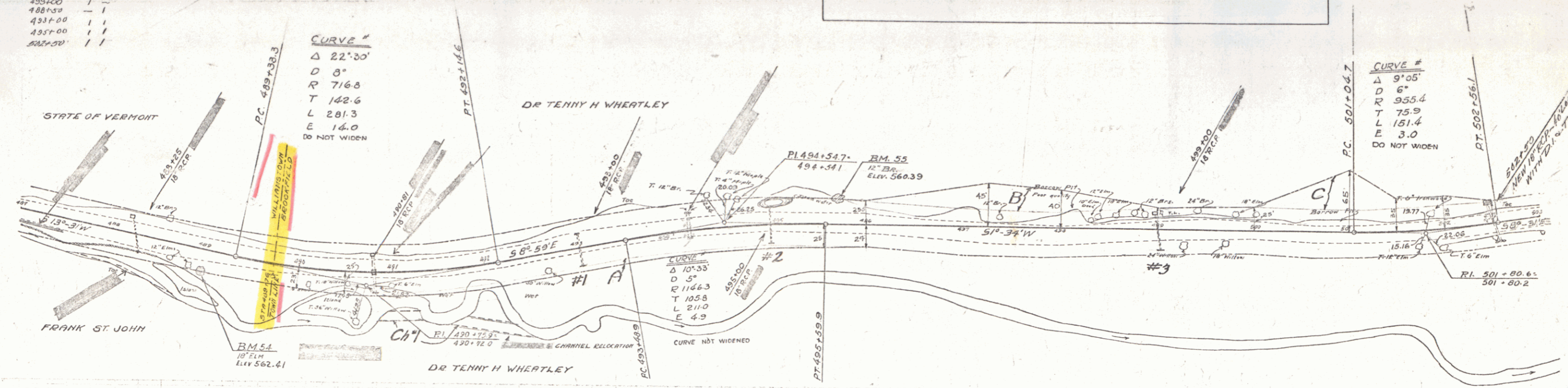

B.M. No. 54 SPIKE IN FOOT OF 18" BIRCH, 18' RT. OF STA. 489+00 ELEV. 562.41
 B.M. No. 55 SPIKE IN FOOT OF 12" BIRCH, 25' LT. OF STA. 495+72, ELEV. 560.39

SERIES F No. 129-C
 SHEET 18 OF 141