

Station	Dist. to	Dist. from	Dist. to	Dist. from
410+00	10'	10'	10'	10'
410+10	20'	20'	20'	20'
410+20	30'	30'	30'	30'
410+30	40'	40'	40'	40'
410+40	50'	50'	50'	50'
410+50	60'	60'	60'	60'
410+60	70'	70'	70'	70'
410+70	80'	80'	80'	80'
410+80	90'	90'	90'	90'
410+90	100'	100'	100'	100'

Station	LT	RT
411+17	24'	24'
412+12	24'	24'
413+62	24'	24'
423+12	24'	24'

Station	RT	LT
412+42	-	-
423+12	-	-

Period	Kind of Instrument	Date of Instrument	Grantor	Grantee	Recorded	Remarks
9-24-31	Q.C.D.	9-24-31	R.G. & E.D. Tripp	State of Vermont	Book 39 Page 118	9-25-31 Ch. Sh. A.H. Tripp
9-24-31	"	9-24-31	S. Frances Goodell	"	39 A. 1	9-25-31

FED. ROAD DIST. NO.	STATE	FISCAL YEAR	SHEET NO.	TOTAL SHEETS
9	Vt.	1934	13	14

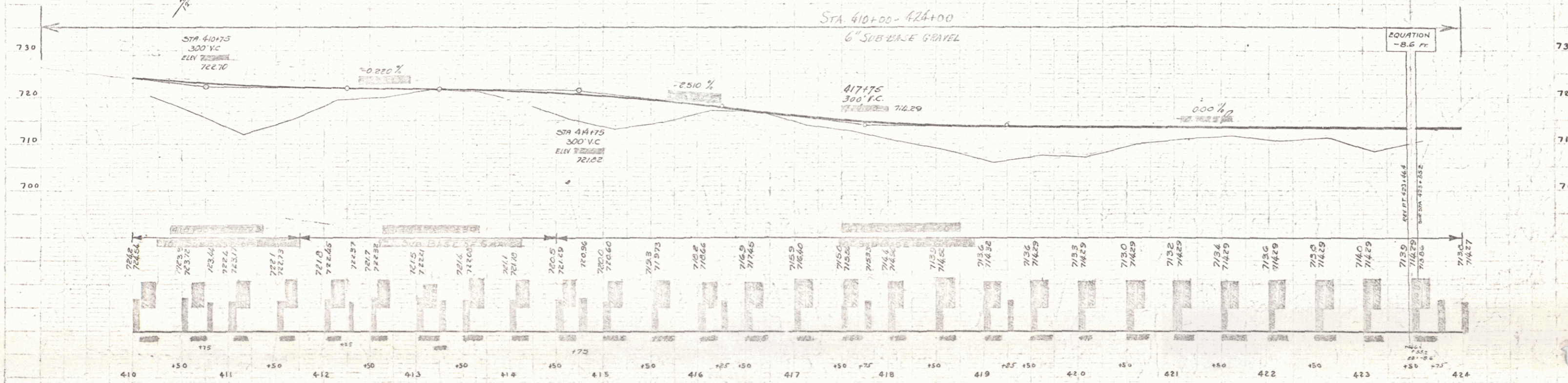
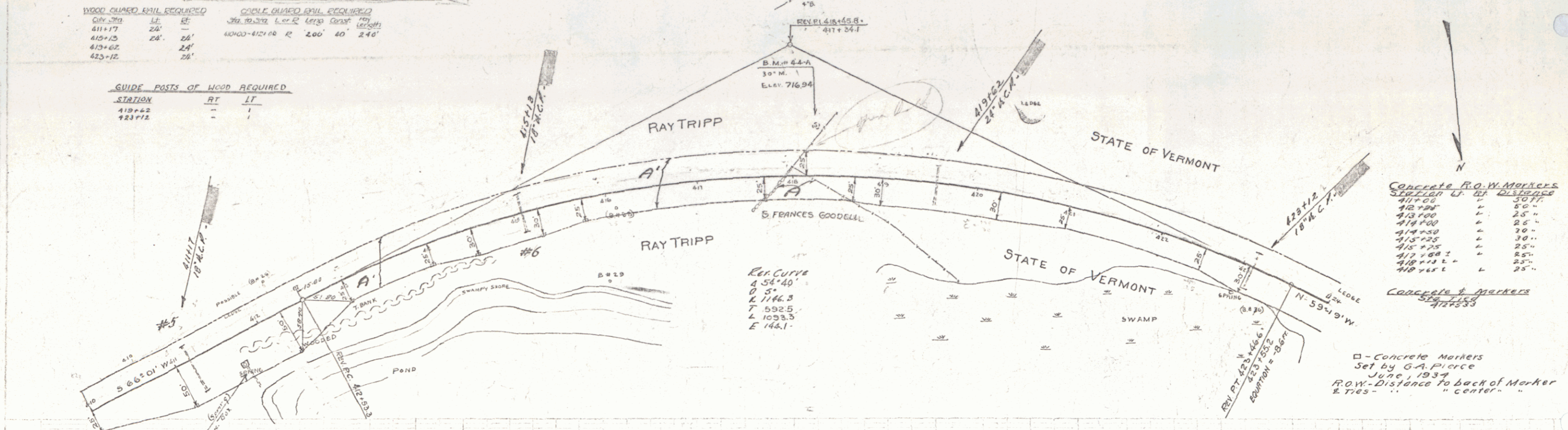

B.M. No. 44-A SPIKE IN ROOT OF 30" MAPLE 41' LT. STA. 417+70 ELEV. 716.34

SERIES F No. 129-C
SHEET 13 OF 14-1