

INDEX OF SHEETS

SHEET NO. 1	TITLE PAGE
" 2	TYPICAL CROSS-SECTION OF IMPROVEMENT (2% GRAVEL MIXED-IN-PLACE SURFACE COURSE WITH RESINED TAR)
" 3	BANKING AND WIDENING TABLES
" 4-15	PLAN AND PROFILE SHEETS
" 15A	PLAN AND PROFILE OF RAILROAD DITCH
" 15B & C	CROSS-SECTIONS OF RAILROAD DITCH
" 15	STANDARD SHEET 320; PIPE CULVERTS
" 20	" 320; BOX CULVERTS
" 21	" 330; GUARD RAIL
" 22	" 331; BOUNDARY MARKERS
" 23	" 340; BARRICADES, SIGNS & LIGHTS
" 23A	" 341; BOX CULVERTS
" 24-63	CROSS-SECTIONS

Standard sheets 328 and 329 approved by the Chief Engineer on July 14, 1933.

Standard sheet 330 approved by the Chief Engineer on Aug. 15, 1933.

Standard sheet 331 approved by the Chief Engineer on July 25, 1934.

FED. ROAD DIST. NO.	STATE	FED. AID PROJ. NO.	FISCAL YEAR	PROJECT NO.	TOTAL SHEETS
9	VT.	108F	1936	1	63

STATE OF VERMONT
STATE HIGHWAY DEPARTMENT

PLAN AND PROFILE OF PROPOSED
STATE HIGHWAY

FEDERAL AID PROJECT

TOWNS OF JERICO & UNDERHILL *Pin# 00R715*

ESSEX JCT.-CAMBRIDGE ROAD

FROM THE JUNCTION, IN JERICO VILLAGE, OF ROUTE 15
AND THE ROAD TO RICHMOND, EASTERLY 3.313 MILES,
TO 100 FT. EAST OF THE RESIDENCE OF GEO. BENEDICT.

LENGTH OF PROJECT 17,496.2 FT. = 3.313 MILES

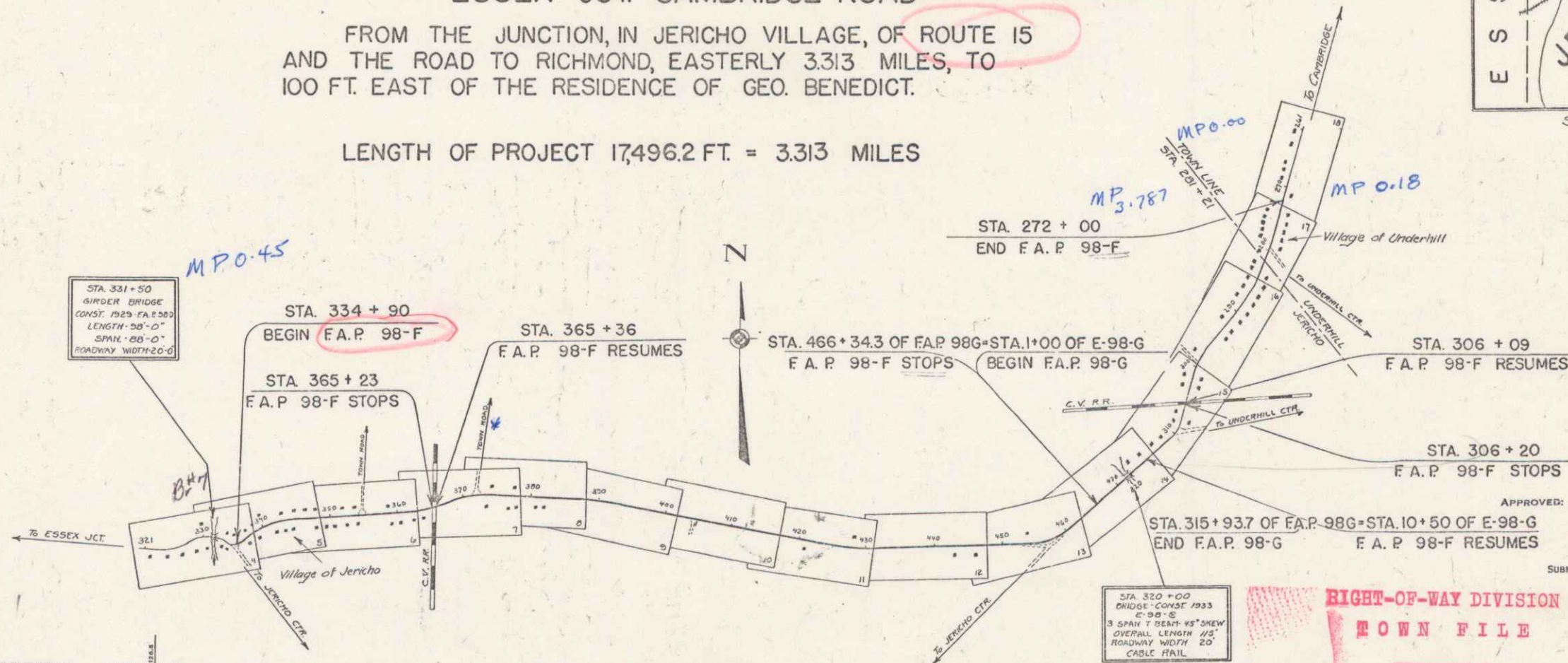

PROJECT NUMBER	Jericho-Underhill
TYPE	F.A.P. 98-F
LENGTH	
YEAR TO	
CONTRACTOR	see file card
LOCATION	

CONVENTIONAL SIGNS

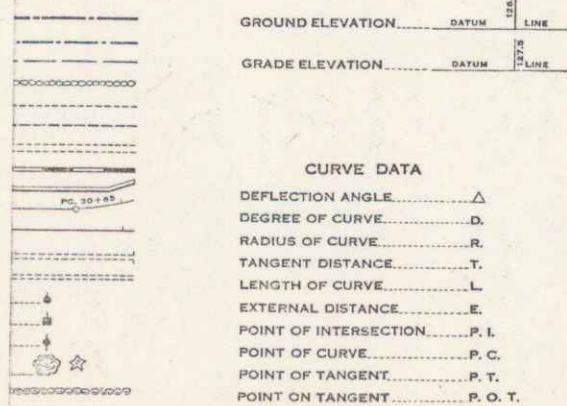

SCALES

TITLE	1"=100'
TYPICAL	1"=20'
PLAN	1"=50'
PROFILE	HOR. 1"=50'
VER.	1"=10'
CROSS-SECTIONS	1"=5'

These plans are subject to such revisions as may be required by the Bureau of Public Roads or the Commissioner of Highways. Construction is to be carried on in accordance with the plans and standard Road and Bridge Specifications of 1930 including all subsequent approved revisions and such revised specifications and special provisions as are submitted with the plans. Attention of contractor is called to the fact that the State Highway Board reserves the right to extend this project northward of the same contract prices. Said cost of extension not to exceed 25% of the amount of contract.

RIGHT-OF-WAY DIVISION
TOWN FILE
PERPETUAL
Town of *U-15*

APPROVED: *May 20, 1935*
H. S. [Signature]
COMMISSIONER OF HIGHWAYS
SUBMITTED BY ORDER OF THE STATE HIGHWAY BOARD

RECOMMENDED [Signature] DISTRICT ENGINEER BUREAU OF PUBLIC ROADS
RECOMMENDED FOR APPROVAL [Signature] CHIEF ENGINEER BUREAU OF PUBLIC ROADS
APPROVED [Signature] DIRECTOR BUREAU OF PUBLIC ROADS

CORRECT: *May 20, 1935*
[Signature] ROAD ENGINEER
SERIES F.A.P. NO. 98-F FILED
SHEET 1 OF 63