

CHANGING ELEVATIONS OF MANHOLES AND CATCHBASINS included in Govt. Participation - 2. Not

NEW CURB AND GUTTER REQUIRED For details see Sheet No. 7A

FED. ROAD DIST. NO.	STATE	PROJECT NO.	SHEET NO.
1	Vt.	100	7

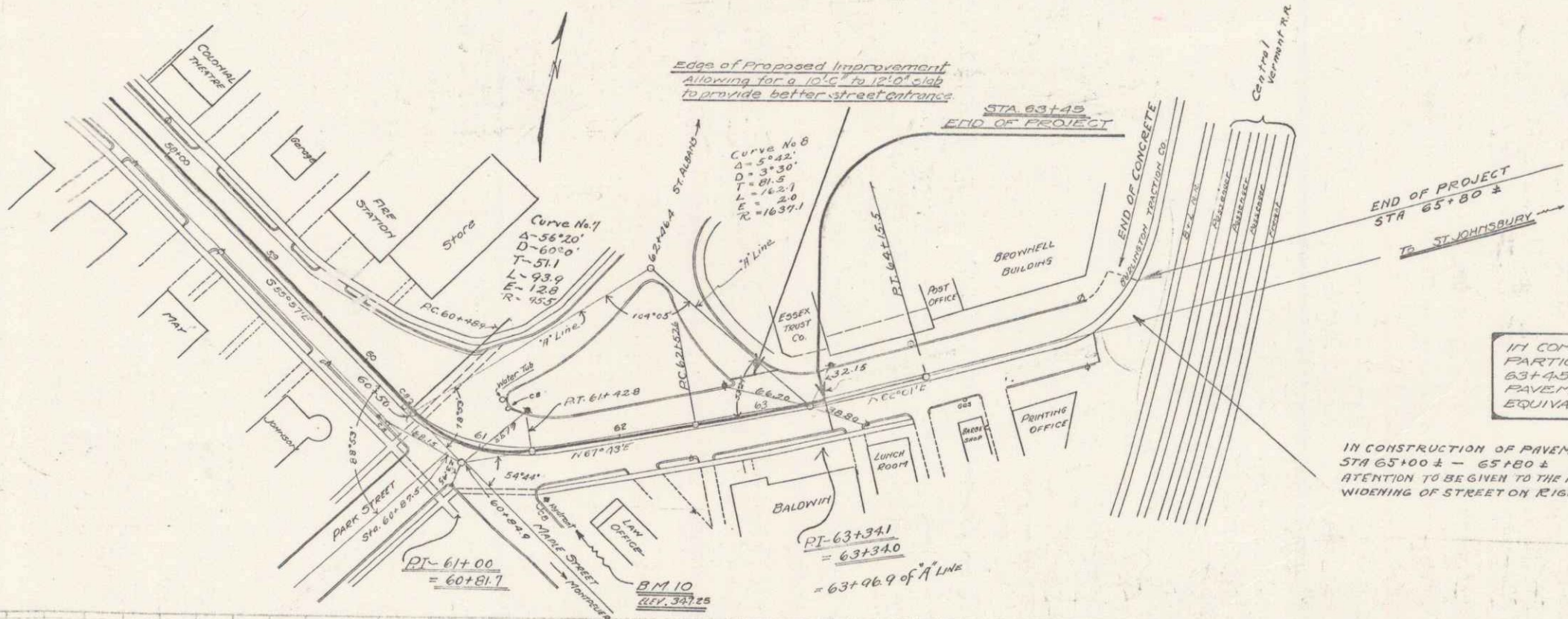

NOTE
 IN COMPUTING QUANTITIES FOR GOVERNMENT PARTICIPATION FROM STA. 60+50 TO STA. 63+45 (END OF PROJECT) THE EXCAVATION AND PAVEMENT IS FIGURED ONLY FOR THE EQUIVALENT OF TWO 8'-0" WIDTHS.

IN CONSTRUCTION OF PAVEMENT STA 63+00 ± - 65+80 ± ATTENTION TO BE GIVEN TO THE FUTURE WIDENING OF STREET ON RIGHT

