

E.S. BARRETT  
 C.R. LATHE  
 L.F. CONE  
 3/14  
 3/17  
 3/17

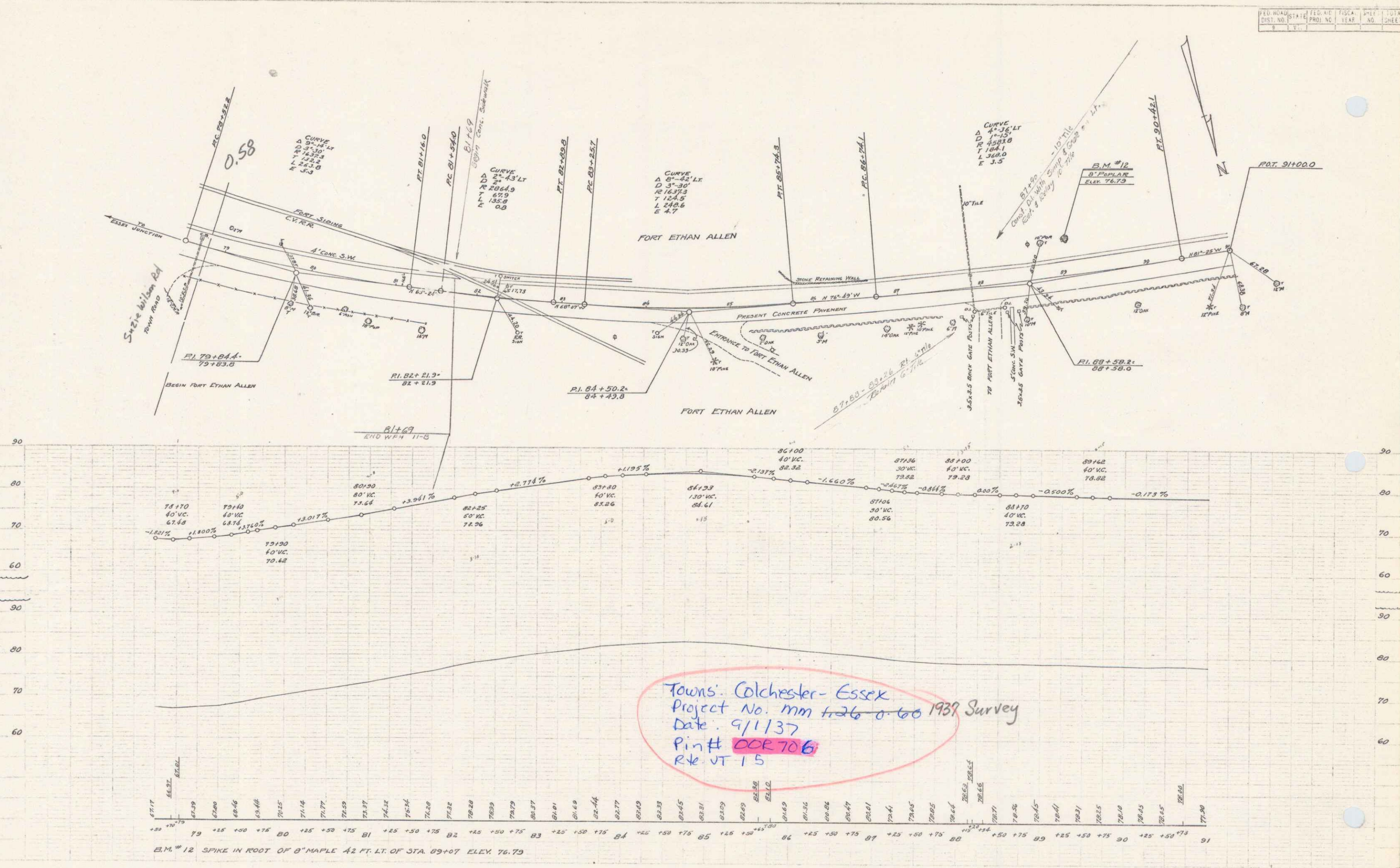

ESSEX - CONSULTING

1

T.S. DUNNITT  
 L.F. CONE  
 9/57

T.S. DUNNITT  
 L.F. CONE  
 9/57

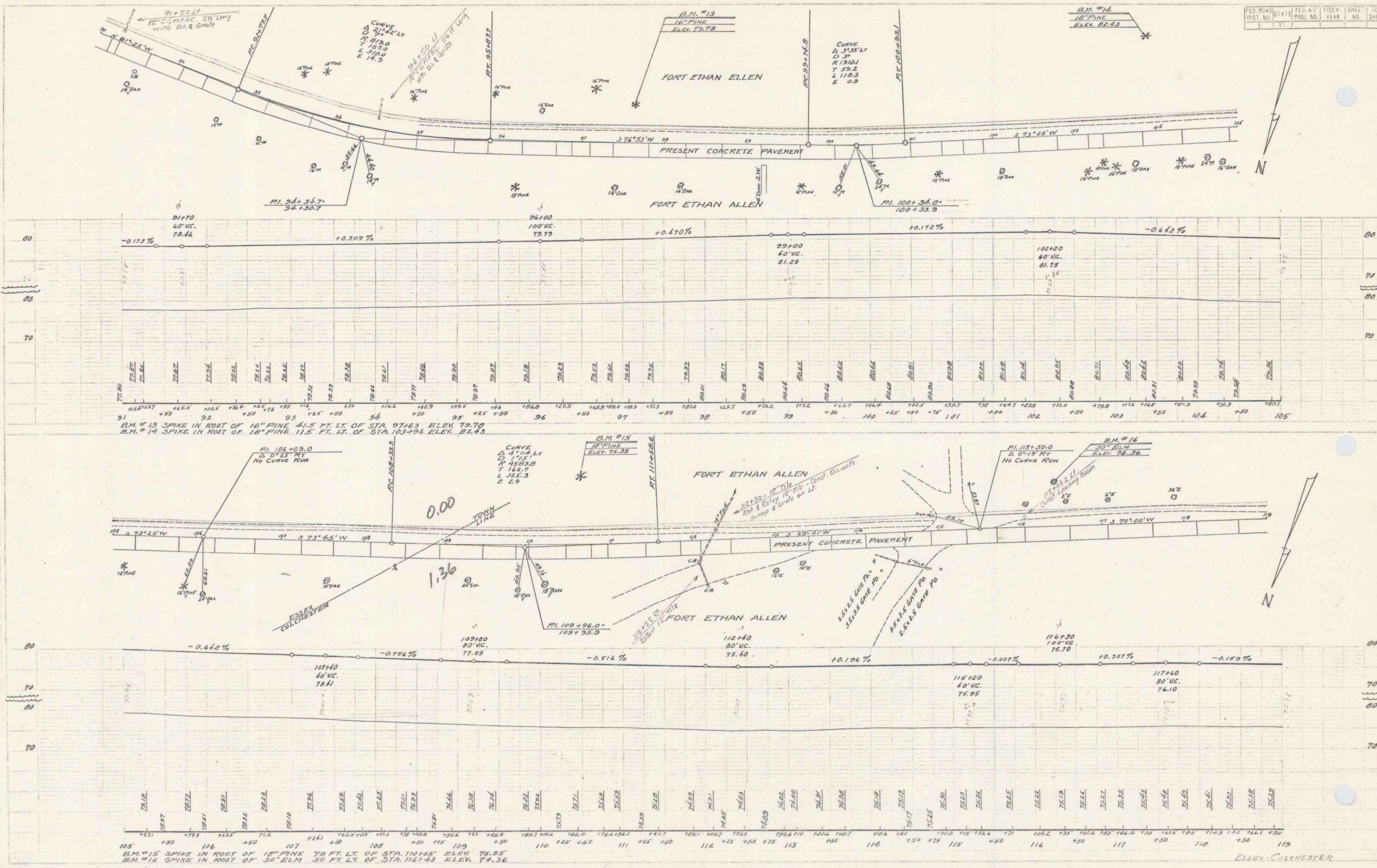

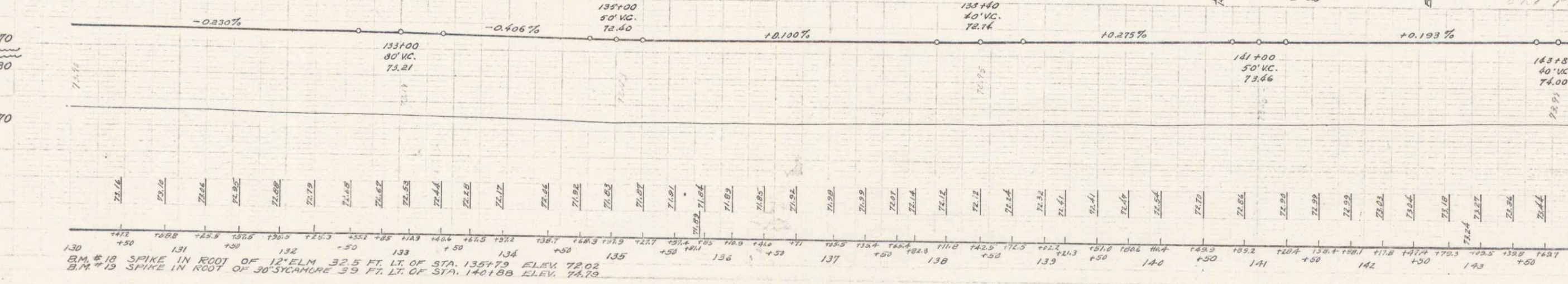
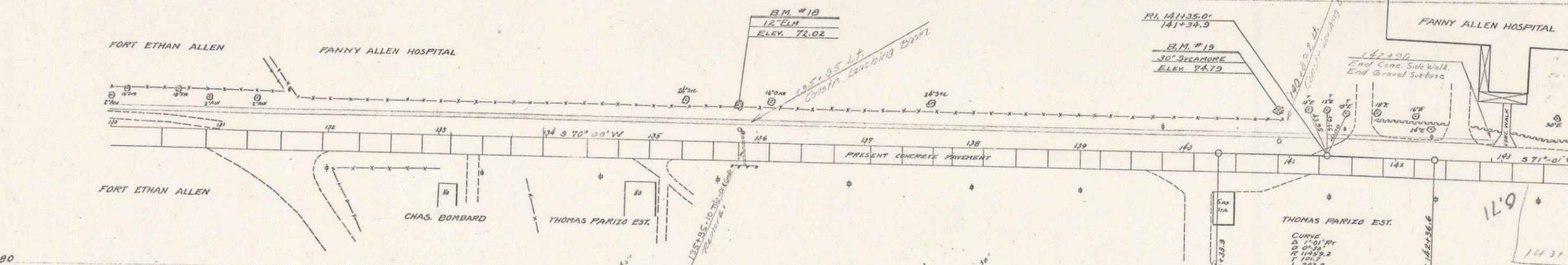
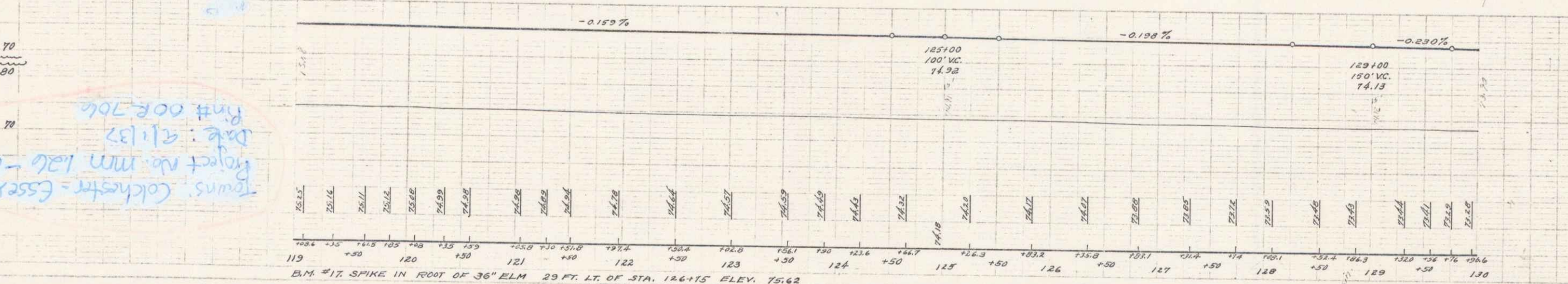
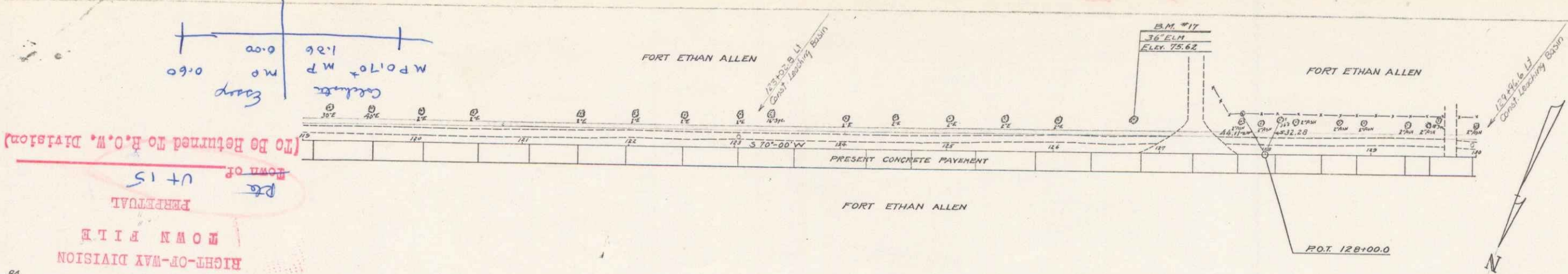

*(To Be Returned to R.O.W. Division)*  
 Town of U+15  
 RIGHT-OF-WAY DIVISION  
 TOWN FILE  
 PROJECT NO. MM 126-0.60  
 DATE: 4-1-32  
 Rm# 008-706

ESSEX COLCHESTER  
 3