

FED. ROAD DIST. NO.	STATE	SECTION	POST MILE	STATION NO.	TOTAL
2	VT	11	1218	7	12

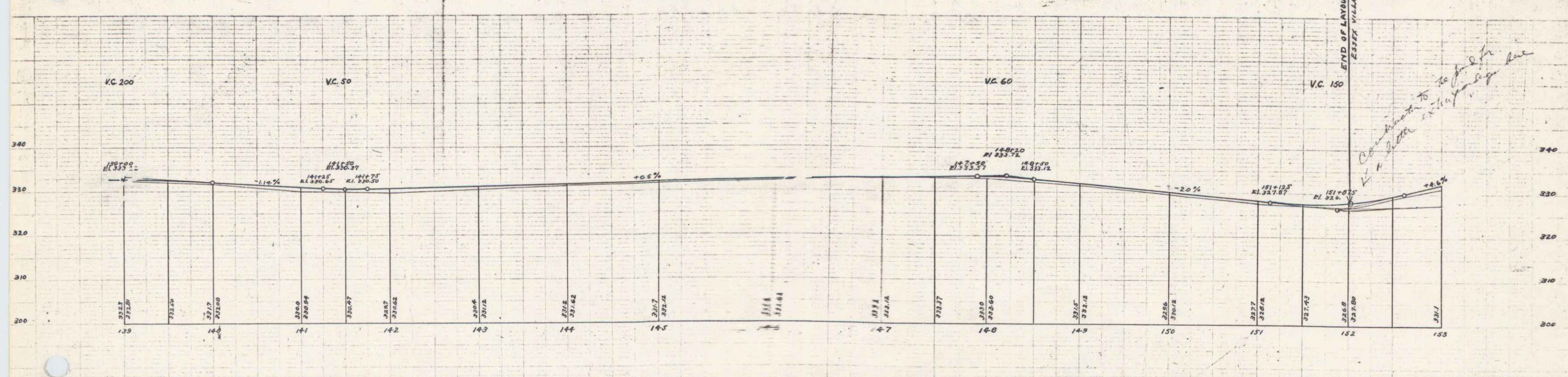
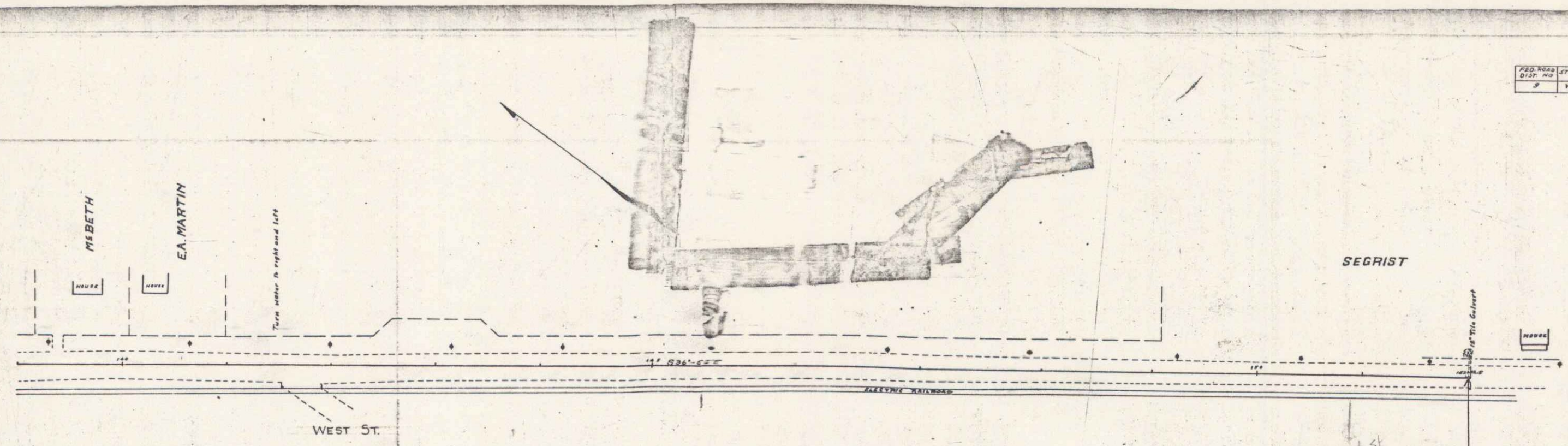

B.M. Opposite Sta 140+43.5 on House S.E. by Corner E. 11 Elev. 149.90  
 B.M. Opposite Sta 152+06.5 on Elm Tree on Spike Elev. 149.72  
 324-67

Series 2 No. 11 Filed  
 Sheet 7 of 12