

GUARD RAIL REQUIRED ON LEFT
Sta. 64+80 to Sta. 64+04 Length 24 ft.

CULVERT REPAIRS REQUIRED
Sta. 64+80 New 10" Tile Length 4 ft
Sta. 64+00 New Head Walls
Concrete laund. (1-2-4)

LEACHING BASINS REQUIRED ON LEFT
One at about Sta. 55+50
One at about Sta. 57+50

| FED. ROAD DIST. NO. | STATE | PROJECT NO. | FISCAL YEAR | SHEET NO. | TOTAL SHEETS |
|---------------------|-------|-------------|-------------|-----------|--------------|
| 5 | Vt. | 11 | 1919 | 5 | 12 |

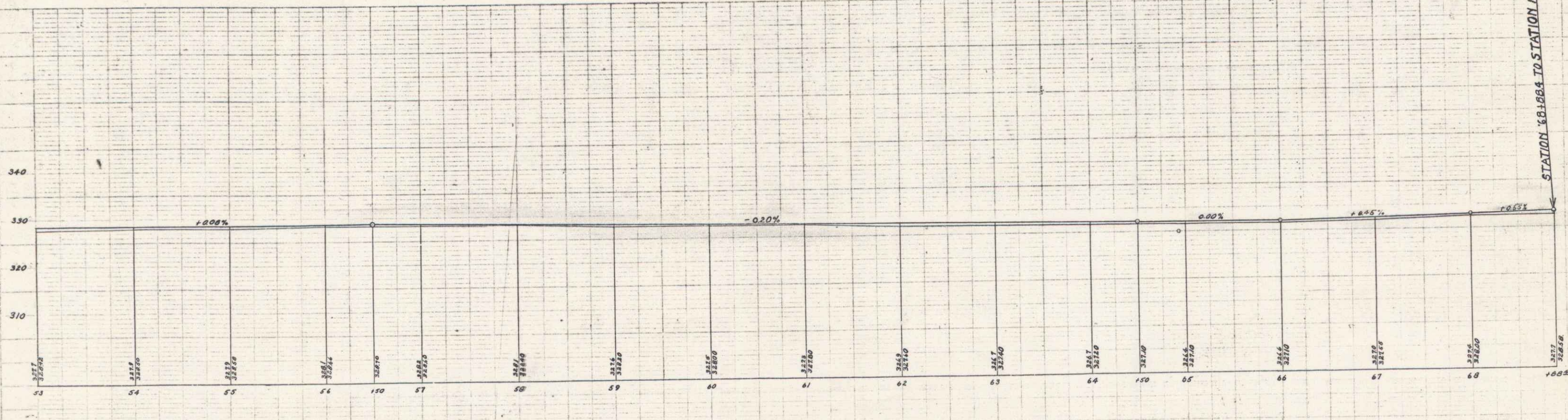
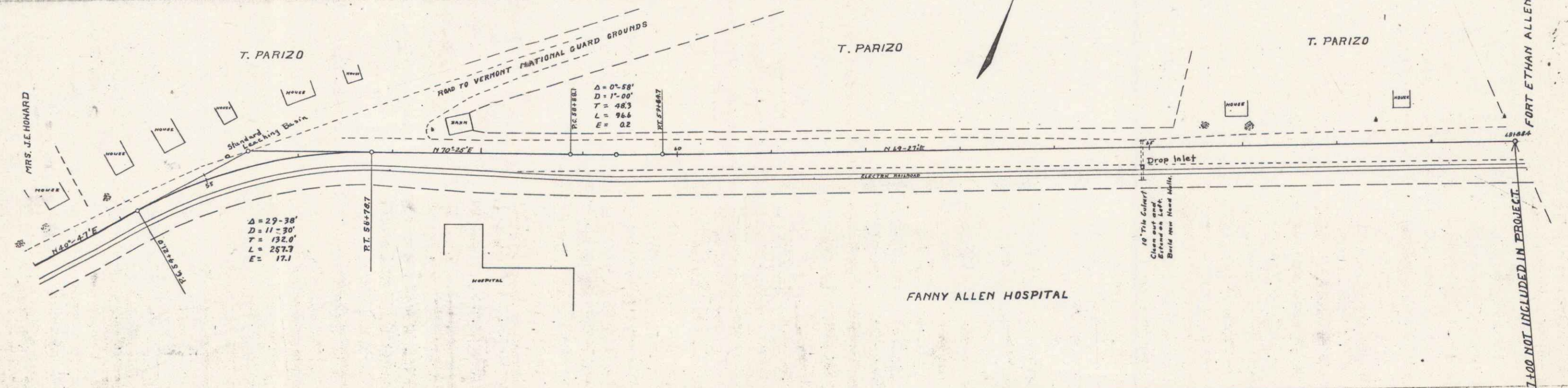

B.M. Bottom base board Gray House with Brown Blinds Elev. 329.30
B.M. Top of stone monument N by side of road Resurrection Line Sta. 68+00.4 Elev. 329.61

STATION 68+00.4 TO STATION 67+00 NOT INCLUDED IN PROJECT

Series No. 11 Filed
Sheet 5 of 12