

GUARD RAIL REQUIRED  
ON LEFT  
Sta. 33+09 to Sta 33+33 Length 24 FT.

CULVERT REPAIRS REQUIRED  
ON RIGHT  
NEW HEAD WALL ON END CULVERT STA 33+32  
CONCRETE (PLAN 75 D-1-4)

LEACHING BASINS REQUIRED  
ON LEFT  
One of about Station 31+00

FED. ROAD DIST. NO.	STATE	FED. AID PROJ. NO.	FISCAL YEAR	SHEET NO.	TOTAL SHEETS
9	VT.	11	1912	3	12

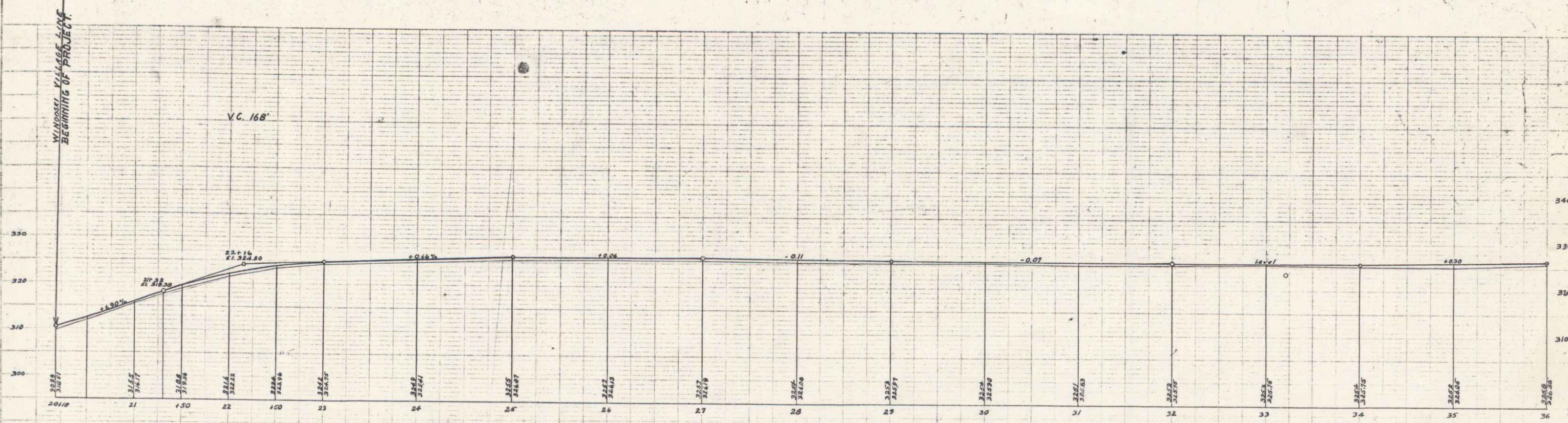
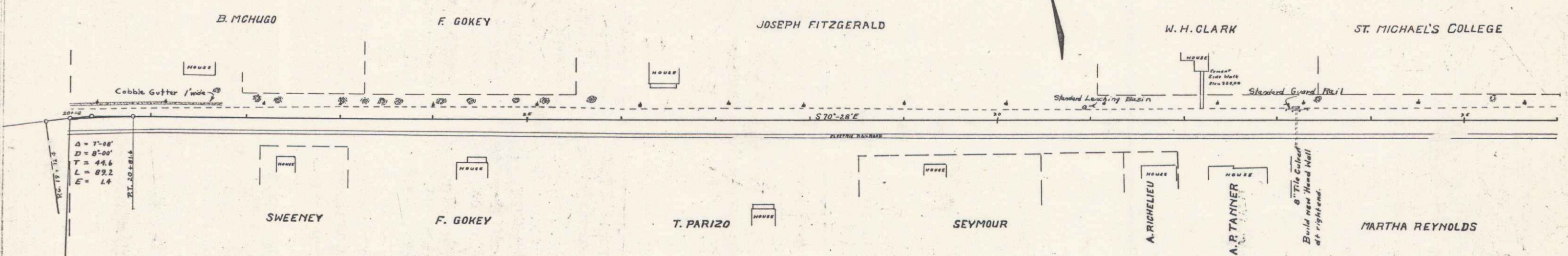

B.M. Spike in Elm Tree W. side road near Corporation Line Elev. 314.56  
B.M. Top N.E. by Corner Post W. by side of road N.E. by F. Gokey House, Elev. 328.70  
B.M. Bench mark N.E. by Corner A.P. Tanner House Sta. 32+48 Elev. 326.76

Same datum as (U.S. Geol. Survey bench mark Shaw Hill)

Spring 1912 filed