

INDEX OF SHEETS

SHEET NO 1	TITLE PAGE
" 2	TYPICAL CROSS-SECTION OF IMPROVEMENT
" 3	PLAN AND PROFILE STA. 20+10 TO STA. 36+00
" 4	" " " " " " 36+00 " " 53+00
" 5	" " " " " " 53+00 " " 60+00.4
" 6	" " " " " " 127+00 " " 139+00
" 7	" " " " " " 139+00 " " 152+02.5
" 8-12	CROSS-SECTIONS

FED. ROAD DIST. NO.	STATE	FED. AID PROJ. NO.	FISCAL YEAR	SHEET NO.	TOTAL SHEETS
2	VT.	11	1919	1	12

STATE OF VERMONT  
STATE HIGHWAY DEPARTMENT

PLAN AND PROFILE OF PROPOSED  
STATE HIGHWAY  
FEDERAL AID PROJECT

TOWNS OF COLCHESTER AND ESSEX Pin # 00R 705  
FORT ROAD  
WINOSKI VILLAGE LINE TO ESSEX VILLAGE LINE

Changes without amended agreement

SCALES (PLAN 1" = 50 FT  
PROFILE HORIZ. 1" = 20 FT VERT. 1" = 10 FT  
CROSS-SECTIONS 1" = 20 FT)

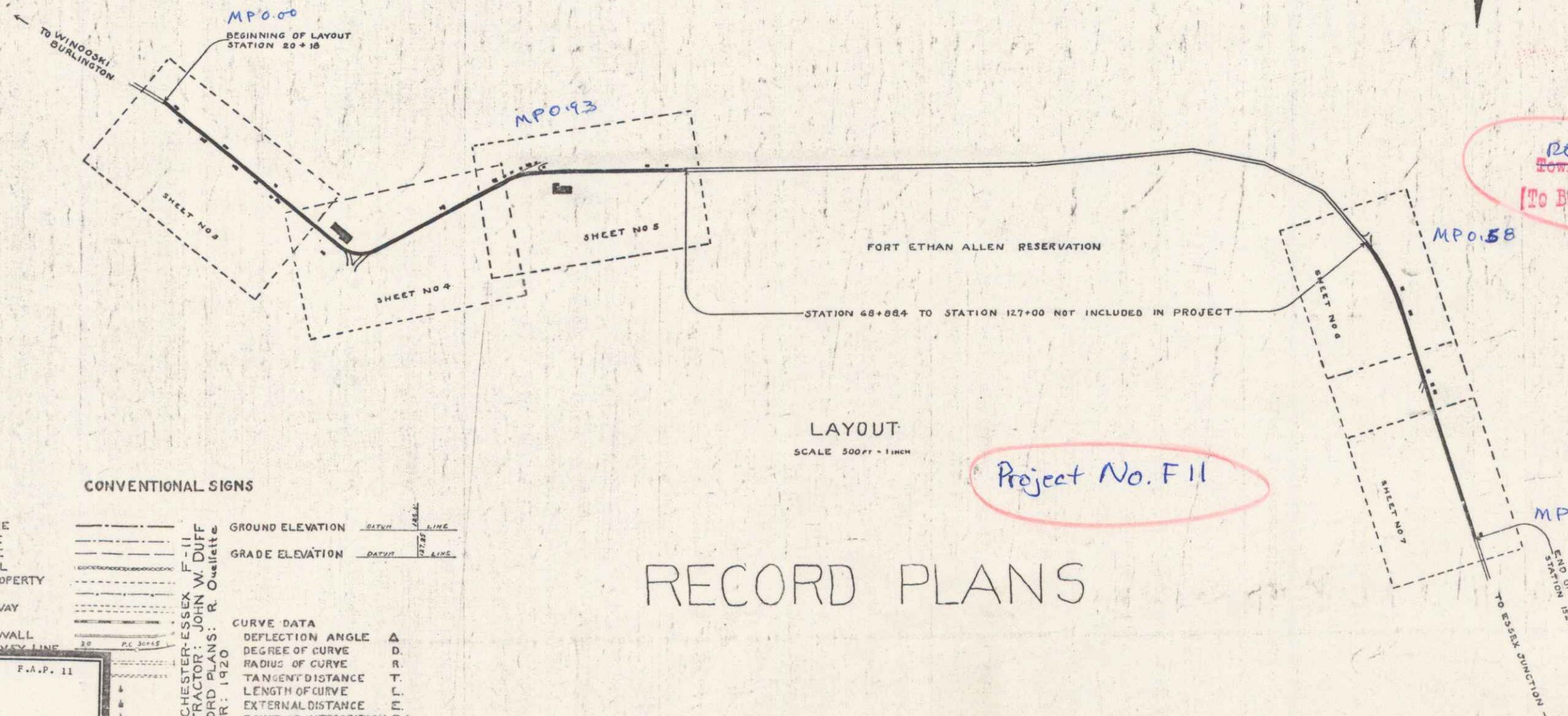

RIGHT-OF-WAY DIVISION  
TOWN FILE  
PERPETUAL  
Town of VT 15  
[To Be Returned To R.O.W. Division]  
Date: 1/1/19

NOTE: ANY FURTHER INFORMATION CONCERNING  
PRIAL QUANTITIES, AMOUNTS OR OTHER DETAILS  
RELATIVE TO THIS PROJECT MAY BE FOUND IN  
EITHER THE FIELD BOOKS OR THE ESTIMATE  
FILE

RECOMMENDED [Signature]  
STATE ENGINEER  
APPROVED [Signature]  
GOVERNOR  
SUBMITTED [Signature]  
STATE HIGHWAY COMMISSIONER

RECOMMENDED [Signature]  
DISTRICT ENGINEER  
BUREAU OF PUBLIC ROADS  
RECOMMENDED FOR APPROVAL [Signature]  
SHERIFFS & SHERIFFS OF PUBLIC ROADS  
APPROVED [Signature]  
DIRECTOR - BUREAU OF PUBLIC ROADS

CONVENTIONAL SIGNS

COUNTY LINE	---	GROUND ELEVATION	-----
TOWN LINE	---	GRADE ELEVATION	-----
FENCE LINE	---		
STONE WALL	---		
UNFENCED PROPERTY	---		
GUARD RAIL	---		
TRAVELED WAY	---		
RAILROAD	---		
RETAINING WALL	---		
ROAD OR SHOULDER LINE	---		

COLCHESTER-ESSEX F-11  
CONTRACTOR: JOHN W. DUFF  
RECORD PLANS: R. Ouellette  
YEAR: 1920

CURVE DATA  
DEFLECTION ANGLE Δ  
DEGREE OF CURVE D  
RADIUS OF CURVE R  
TANGENT DISTANCE T  
LENGTH OF CURVE L  
EXTERNAL DISTANCE E  
POINT OF INTERSECTION P.I.  
POINT OF CURVE P.C.  
POINT OF TANGENT P.T.

RECORD PLANS

FILE NO.	1920
TOWN	Colchester
PROJECT	Fort Road
F.A.P.	11

Sheet F No 11 Filed  
Sheet 1 of 12  
DIST. # 5 PLANS