

PARCEL	INSTRUMENT	DATE	GRANTOR	GRANTEE	RECORDED TOWN OF	BOOK	PAGE	DATE	REMARKS
7AB	W.D.O.E.	3-24-55	LOREN W. & ELIZABETH A. COLEMAN	SI OF VT.	LONDONDERRY	27	292-293	11-23-55	See also sheets 15 & 17

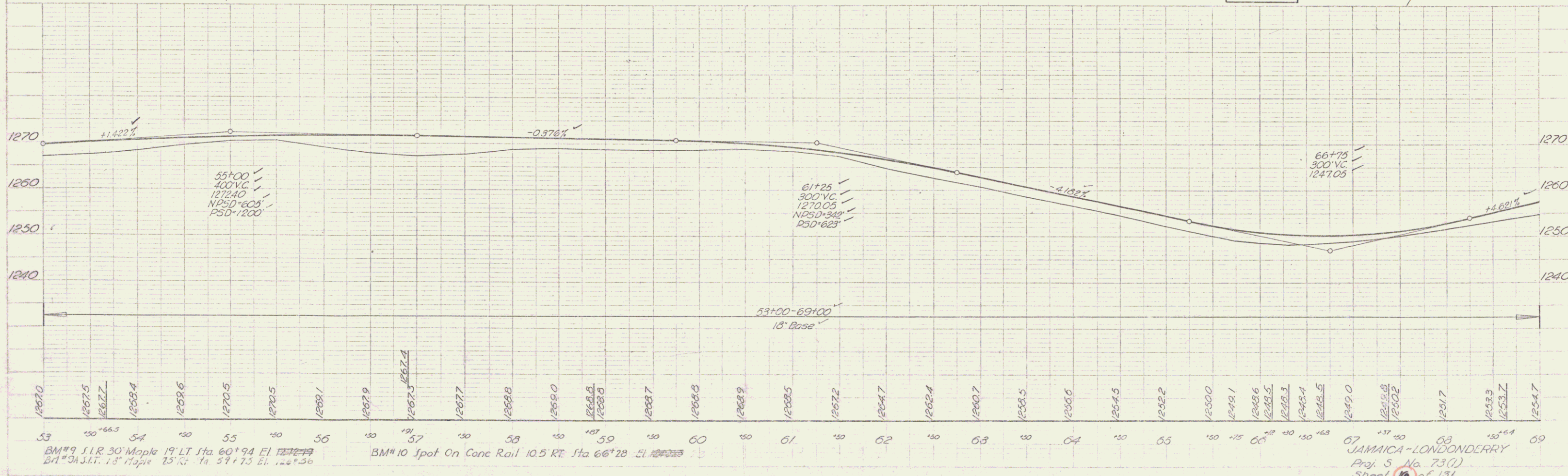

BM#9 51R 30' Maple 19' LT Sta 60+94 El. 1272.19
 BM#10 Spot On Conc Rail 10.5 RT Sta 66+28 El. 1272.23
 JAMMICA-LONDONDERRY
 Proj. 5 No. 73(1)
 Sheet 16 of 131