

ESTIMATED QUANTITIES (Bridge Only)			
Quantity	Unit	Item	Item No.
1607	cy	Borrow	102
642	cy	Unclassified Channel Excavation	106C
32	cy	Structure Excavation (modified)	107
31	ton	Bituminous Concrete Pavement for Bridge Floors	351
150	cy	Concrete Class "B", modified	401-B
23,400	lbs.	Reinforcing Steel (Abutments and Superstructure)	402
8,750	lbs.	Structural Steel	403A
26	sq.	Asphaltic Asbestos Coating	407
1	1	Furnishing Equipment for Driving Piles	501
348	lf.	Steel Piling	504
135	lf.	Cutoffs for Steel Piling	504-1
134	cy	Stone Filling	521
130	lf.	Bridge Railing	572

BRIDGE DATA		
	PRESENT	PROMISED
Type	Steel Pony Truss	W Steel Beam
Overall Span	Stone Abutments	Concrete Deck
Clear Span	31'	69'
Clear Height to Low Bridge Seat	25'	65'
	13'	19'

For further information see Preliminary Information Sheet Sheet No. of

NOTE: For modifications to Standard Drawings 51B30 H20-1 and 5B55-1 see details of Abutments #1 and #2.

INDEX OF BRIDGE SHEETS	
Sheet 13 of 12s Plan and Profile Sheet	
" 32 "	Details of Abutment #1
" 33 "	Details of Abutment #2
" 34 "	Reinforcing Steel Schedule
" 43 "	Std. Dwg. 51B30 H20-1 (mod. for End Post Design see Abut #1 & 2)
" 40 "	Std. Dwg. 5B55-1 Bridge Railing (see Abut #1 & 2 for post spacing)
" 42 "	Std. Dwg. 5B-20 Details C-14" x 14"
" 41 "	Std. Dwg. 5B-11 Barricades, Signs and Lights
" 123-125 "	Channel Sections
" 31 "	Preliminary Information Sheet
" 35 "	Earthwork Sheet

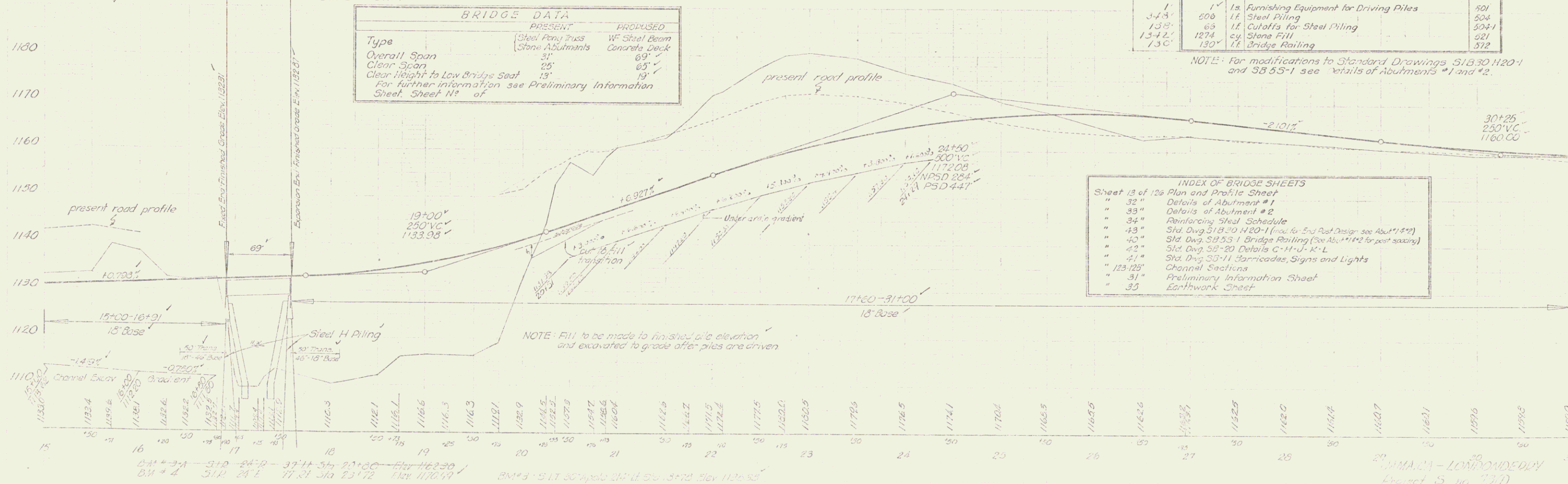

BM # 3-A 31.0 24.0 37.14 57.0 20+00 Elev. 1162.30
BM # 4 31.0 24.0 37.14 57.0 20+00 Elev. 1170.99
BM # 3 31.0 24.0 37.14 57.0 20+00 Elev. 1165.38

JAMAICA - LONGPOND EDDY
Project S No. 7301
Sheet 13 of 131